

PB30000D

GENERAC

3.0 DIESEL

REPAIR PARTS MANUAL

P.O. BOX 8- WAUKESHA WI. 53187

PHONE: (414) 544- 4811 / FAX : (414) 544-0179

PRINTED IN U.S.A.

ISSUED: 03/20/96

TABLE OF CONTENTS

ENGINE SERVICE RECOMMENDATIONS	2
ENGINE GASKETS , TUNE-UP PARTS, ENGINE PARTS	3
CYLINDER BLOCK AND ACCESSORIES	4
CYLINDER HEAD AND COVER	5
OIL PAN AND TIMING COVER ACCESSORIES	6
PISTON, CRANKSHAFT, AND FLYWHEEL	7
VALVE SYSTEM, AND RELATED PARTS	8-9
INTAKE MANIFOLD AND RELATED PARTS	10
EXHAUST MANIFOLD AND RELATED PARTS	11
FUEL SYSTEM	12
FUEL FILTER COMPONENTS	13
INJECTION PUMP	14
NOZZLE HOLDER AND SEDIMENTER	15
OIL PUMP AND FILTER RELATED PARTS	16
COOLING SYSTEM AND RELATED PARTS	17
ENGINE ELECTRICAL PARTS	18
TURBOCHARGER AND AIR FILTER RELATED PARTS	19
ENGINE FINISH PARTS	20-21

LEGEND

"STD" STANDARD SIZE

"O.S." OVERSIZE

"U.S." UNDERSIZE

***NOTE* FOR PRE-1989 UNITS, PLEASE SEE PUBLICATION # 68063**

ENGINE SERVICE RECOMMENDATIONS

SPECIFICATIONS:

CRANKCASE OIL CAPACITY 6.3 U.S. QUARTS
 COOLANT CAPACITY 9.0 U.S. QUARTS

RECOMMENDED COOLANT:

USE A MIXTURE OF HALF LOW SILICATE, ETHYLENE GLYCOL BASE ANTI-FREEZE AND HALF SOFT WATER. COOLING SYSTEM CAPACITY IS ABOUT 9 U.S. QUARTS (EIGHT LITERS). USE ONLY LOW SILICATE ANTI-FREEZE. IF YOU WANT, ADD A HIGH QUALITY RUST INHIBITOR TO THE RECOMMENDED COOLANT MIXTURE. WHEN ADDING COOLANT, ALWAYS ADD THE RECOMMENDED 50 / 50 MIXTURE.

DO NOT USE ANY CHROMATE BASE RUST INHIBITOR WITH ETHYLENE GLYCOL BASE ANTI-FREEZE OR ELSE "CHROMIUM HYDROXIDE" (GREEN SLIME) FORMS AND CAUSES OVERHEATING. ENGINES THAT HAVE BEEN OPERATED WITH CHROMATE BASE RUST INHIBITOR MUST BE CHEMICALLY CLEANED BEFORE YOU CAN ADD ETHYLENE GLYCOL BASE ANTI-FREEZE. USING ANY HIGH SILICATE ANTI-FREEZE BOOSTERS OR ADDITIVES WILL ALSO CAUSE OVERHEATING. WE ALSO RECOMMEND THAT YOU DO NOT USE ANY SOLUBLE OIL INHIBITOR FOR THIS EQUIPMENT.

RECOMMENDED ENGINE OIL:

USE A HIGH QUALITY DETERGENT OIL CLASSIFIED "FOR SERVICE CC, SD, SE, OR SF." DETERGENT OILS KEEP THE ENGINE CLEANER AND REDUCE CARBONDEPOSITS. USE OIL HAVING THE FOLLOWING SAE VISCOSITY RATING BASED ON THE AMBIENT TEMPERATURE RANGE ANTICIPATED BEFORE THE NEXT OIL CHANGE

TEMPERATURE	RECOMMENDED OIL GRADE
ABOVE 80 deg. F	SAE 30
30-80 deg. F	SAE 20W-20
BELOW 32 deg. F	SAE 10W

AFTER FIRST 30 HOURS OF OPERATION

- * CHECK AND ADJUST VALVE CLEARANCE.
- * RETORQUE CYLINDER HEAD BOLTS.
- * RETORQUE INTAKE / EXHAUST MANIFOLD BOLTS.
- * RETORQUE OIL PAN BOLTS.
- * RETORQUE ENGINE FAN BOLTS.
- * TEST FUEL INJECTION NOZZLES.
- * CHECK INJECTION TIMING.
- * CHECK ENGINE CRANKCASE OIL.
- * INSPECT ENGINE FAN BELTS.

EVERY MONTH

- * CHECK ENGINE OIL LEVEL.
- * CHECK GEARBOX OIL LEVEL (IF SO EQUIPPED).
- * DRAIN, FLUSH, AND REFILL COOLING SYSTEM.

EVERY SIX MONTHS

- * CHANGE ENGINE OIL AND FILTER.
- * LUBRICATE ENGINE CONTROLS.
- * SERVICE ENGINE AIR CLEANER AND FUEL FILTER.
- * INSPECT FAN BELTS.
- * CHECK COOLANT LEVEL.
- * INSPECT COOLING SYSTEM HOSES.
- * CHECK ENGINE COMPRESSION.

ONCE ANNUALLY

- * CHECK ENGINE VALVE CLEARANCE.
- * TEST FUEL INJECTION NOZZLES.
- * TEST INJECTION TIMING.
- * TEST ENGINE STARTER.
- * DRAIN WATER FROM FUEL TANK.
- * RETORQUE FAN BOLTS.

EVERY TWO YEARS

- * REPLACE ALL RUBBER HOSES.
- * REPLACE ENGINE FAN BELTS.
- * DRAIN, FLUSH, AND REFILL COOLING SYSTEM.

ENGINE REBUILD GASKET SET # 100-70874G

DESCRIPTION	GENERAC#	QTY
THERMOSTAT GASKET	197-70874	1
GASKET, VALVE COVER	199-70874	1
CYLINDER HEAD GASKET	201-70874	1
OIL PAN GASKET SET	205-70874	1
TIMING COVER SEAL	164-57778	1
GASKET, TIMING CASE	165-57778	1
GASKET, GEAR COVER	207-70874	1
GASKET, TIMING COVER	167-57778	1
GASKET, OIL JET	208-70874	8
GASKET, REAR COVER	215-70874	1
REAR MAIN OIL SEAL	220-70874	1
VALVE STEM SEAL (INTAKE)	222-70874	4
VALVE STEM SEAL (EXHAUST)	222-70874A	4
INTAKE MANIFOLD GASKET	235-70874	1
EXHAUST MANIFOLD GASKET (FRONT)	238-57778	2
EXHAUST MANIFOLD GASKET (REAR)	238-70874	2
GASKET, ELBOW	57594	1
INJECTOR NOZZLE GASKET	269-55441	4
INJECTOR NOZZLE GASKET	270-55441	4
GASKET, LEAK PIPE	254-67057	4
INJECTOR PUMP GASKET	123-70874	1
GASKET, SUCTION PIPE	257-70874	1
O-RING, OIL PIPE	442-57778	1
GASKET, OIL PIPE	258-70874	1
OIL COOLER MOUNTING GASKET	261-70874	2
GASKET, OIL COOLER TO BLOCK	262-70874	1
GASKET, OIL FILTER ADAPTOR TO BLOCK	263-70874	1
OIL FILTER CANISTER GASKET	269-70874	1
GASKET, WATER PUMP MOUNTING TO BLOCK (LARGE)	465-57778	1
GASKET, WATER PUMP MOUNTING TO BLOCK (SMALL)	466-57778	1
GASKET, WATER PUMP TO MOUNTING	470-57778	1
GASKET, WATER PUMP INLET	272-70874	1
GASKET, THERMOSTAT COVER	477-57778	1

ENGINE TUNE-UP / ENGINE PARTS

FUEL SOLENOID	79966
AIR CLEANER	73267
FUEL FILTER	363-67057
OIL FILTER (PRIMARY)	101-57778
OIL BYPASS FILTER	268-70874
V-BELT	58012
UPPER RADIATOR HOSE	55512
LOWER RADIATOR HOSE	71661
CONNECTING ROD BEARING KIT (STD)	108-57778
MAIN BEARING KIT (STD)	106-57778
PISTON RING SET (STD)	105-57778
REAR MAIN OIL SEAL	220-70874

TORQUE SPECIFICATIONS

FUEL INJECTION NOZZLE HOLDERS	12-17 ft. lbs.
INJECTION PUMP	12-17 ft. lbs.
INTAKE / EXHAUST MANIFOLD BOLTS	12-17 ft. lbs.
MAIN BEARING CAPS	80-85 ft. lbs.
CONNECTING ROD CAPS	55-60 ft. lbs.
CAMSHAFT THRUST PLATE	12-17 ft. lbs.
INJECTION PUMP COVER	43-51 ft. lbs.
CYLINDER HEAD BOLTS	80-85 ft. lbs.
CRANKSHAFT PULLEY	94-123 ft. lbs.
END PLATE	21-30 ft. lbs.
OIL PAN BOLTS	5-9 ft. lbs.

CYLINDER BLOCK AND ACCESSORIES

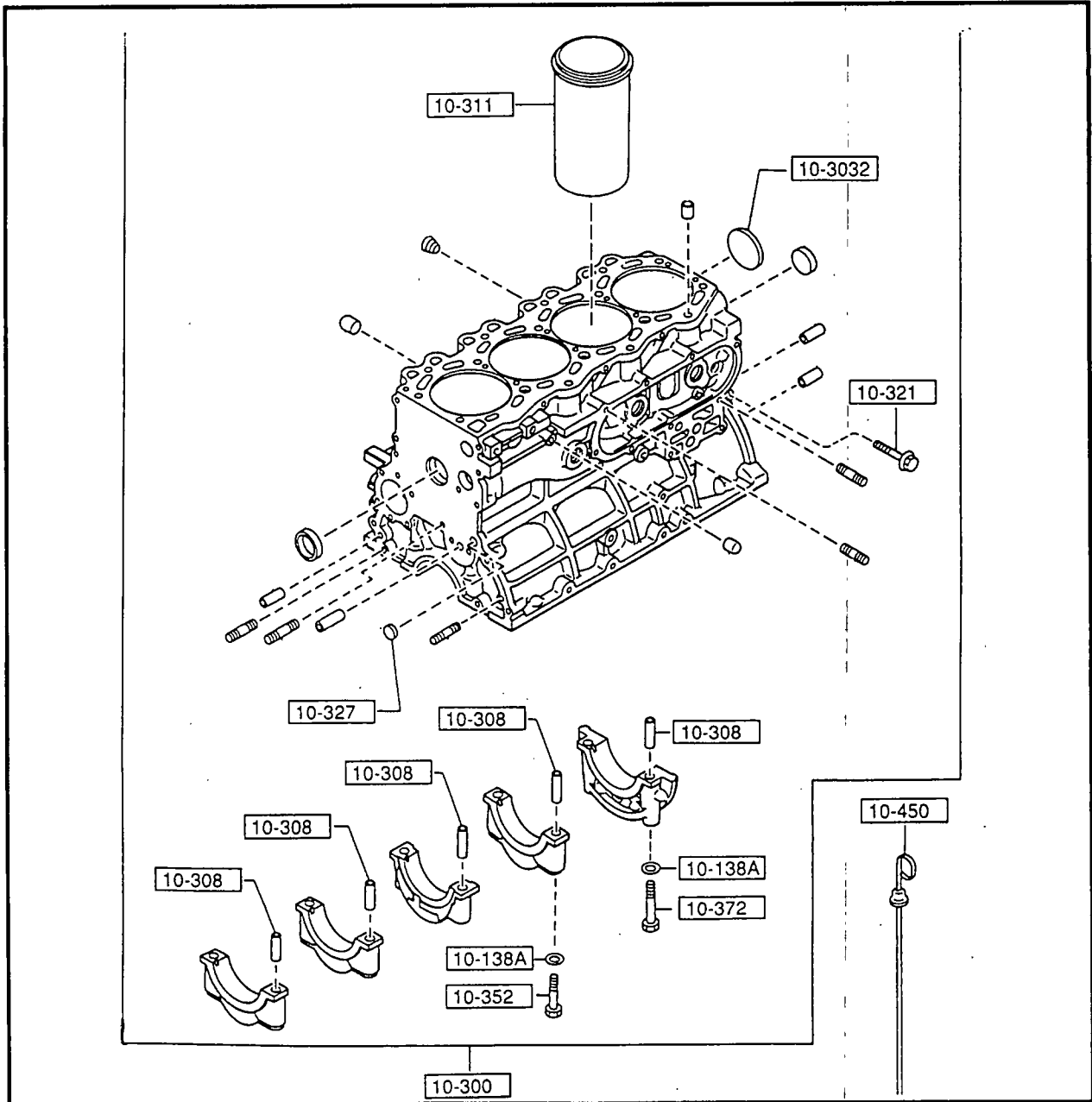

REF#	GENERAC#	DESCRIPTION	QTY
10-138A	144-57778	WASHER, PLAIN	10
10-300	203-70874	BLOCK, CYLINDER	1
10-3032	146-57778	PLUG, CAMSHAFT	1
10-308	147-57778	PIN, TUBULAR	10
10-311	148-57778	LINER, CYLINDER	4
10-321	133-67057	PLUG	1
10-327	135-67057	PLUG, BLIND	2
10-352	150-57778	BOLT, BEARING CAP	8
10-372	151-57778	BOLT	2
10-450	103-70874	GAUGE, OIL LEVEL	1

CYLINDER HEAD AND COVER

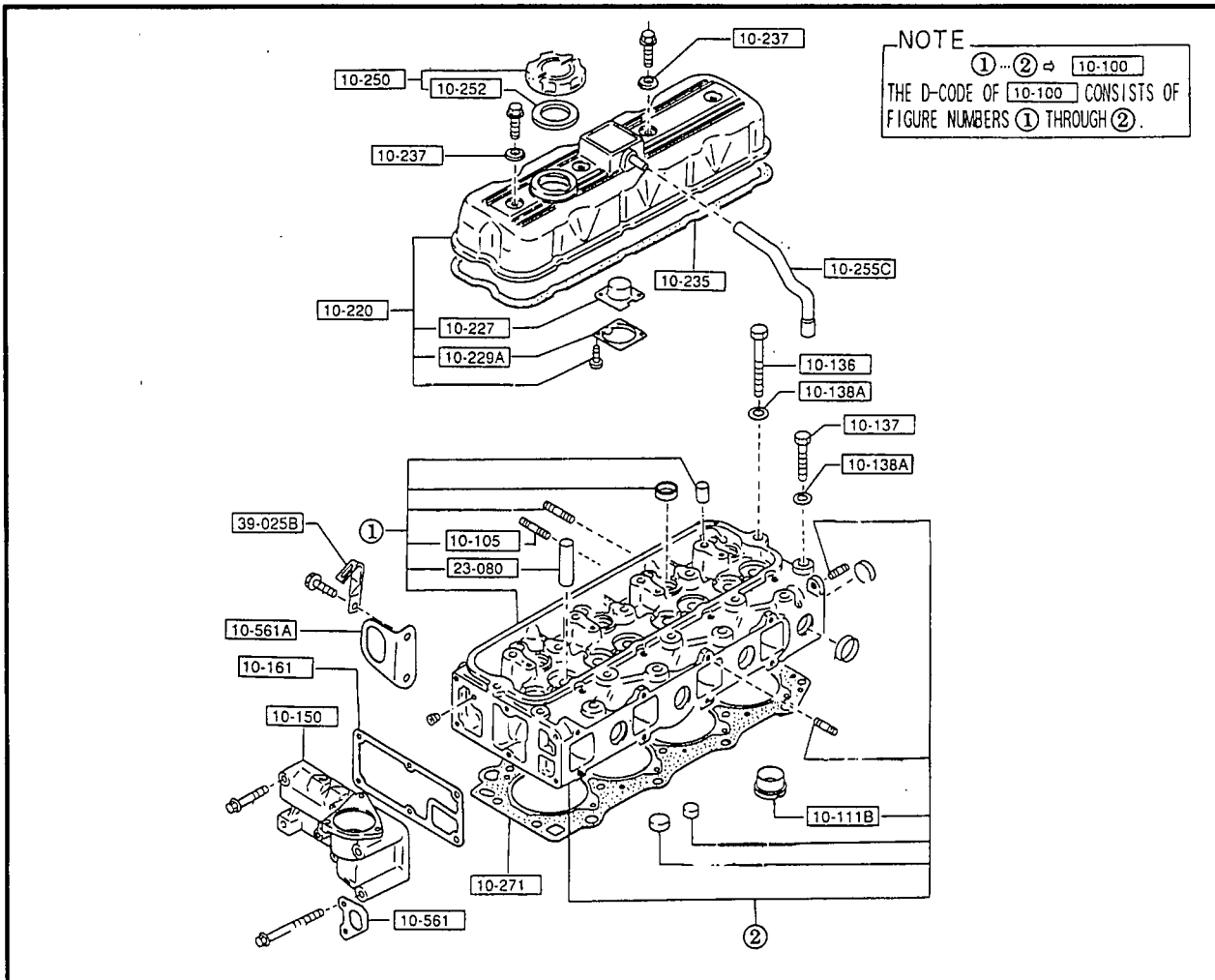

REF#	GENERAC#	DESCRIPTION	QTY
10-100	194-70874	HEAD, CYLINDER	1
10-105	195-70874	STUD, EXHAUST MANIFOLD	4
10-111B	196-70874	INSERT	4
10-136	130-57778	BOLT, CYLINDER HEAD	11
10-137	131-57778	BOLT, CYLINDER HEAD	7
10-138A	144-57778	WASHER, PLAIN	18
10-150	133-57778	CASING, THERMOSTAT	1
10-161	197-70874	GASKET, THERMOSTAT	1
10-220	198-70874	COVER, CYLINDER HEAD	1
10-227	136-57778	PLATE, BAFFLE	1
10-229A	137-57778	PLATE, OIL BEFFLE	1
10-235	199-70874	GASKET, HEAD COVER	1
10-237	138-57778	WASHER, SEALING HEAD COVER	4
10-250	119-67057	CAP, OIL FILLER	1
10-252	120-67057	GASKET	1
10-255C	139-57778	HOSE, BREATHER	1
10-271	201-70874	GASKET, CYLINDER HEAD	1
10-561	140-57778	HANGER, ENGINE	1
23-080	202-70874	GUIDE, VALVE	8
39-025B	143-57778	CLIP	1

OIL PAN AND TIMING COVER ACCESSORIES

REF#	GENERAC#	DESCRIPTION	QTY
10-380	204-70874	BLOCK, OIL PAN UP	1
10-400	101-70874	PAN, OIL	1
10-404	150-67057	PLUG, DRAIN	1
10-406	152-67057	CAP, SEALING	1
10-431	158-57778	GASKET, OIL PAN	1
10-431S	205-70874	GASKET SET, OIL PAN	1
10-4322	206-70874	GASKET (R) OIL PAN	1
10-500A	104-70874	CASE, TIMING GEAR	1
10-503	105-70874	PIN, TOP INDICATOR	1
10-507	164-57778	SEAL, OIL	1
10-511A	165-57778	GASKET, TIMING CASE	1
10-5352	207-70874	GASKET, GEAR COVER	1
10-600	166-57778	COVER, TIMING GEAR	1
10-611A	167-57778	GASKET, TIMING COVER	1
10-7012	168-57778	COVER, INJECTION PUMP	1
10-710	169-57778	JET, OIL	4
10-715A	208-70874	GASKET, OIL JET	8
10-730A	145-67057	VALVE, OIL JET	4
10-901A	106-70874	HOUSING, FLYWHEEL	1
16-111	187-67057	COVER, PEEPING HOLE	1
23-0451	189-67057	TUBE, SILICON	1

PISTON, CRANKSHAFT AND FLYWHEEL

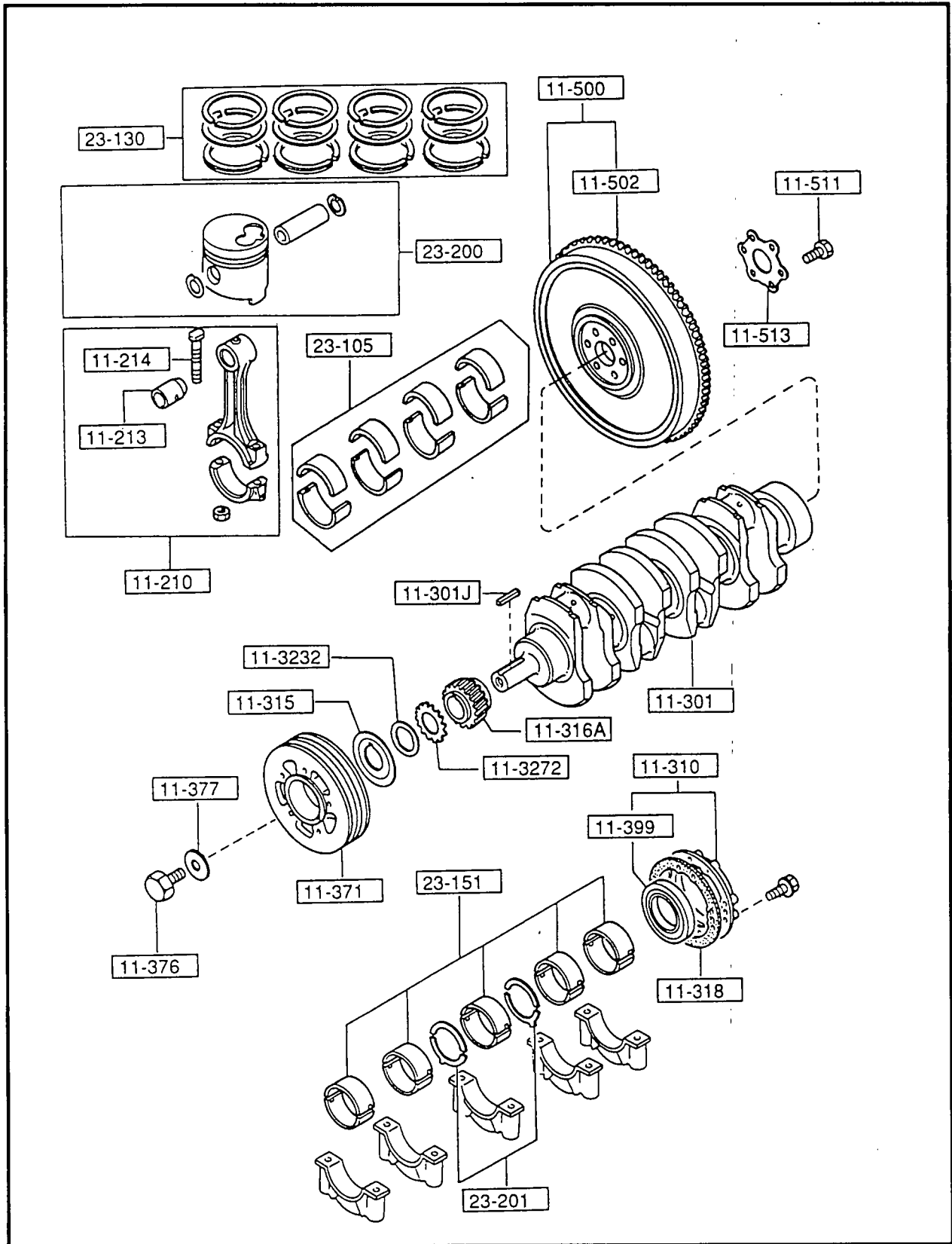

PISTON, CRANKSHAFT AND FLYWHEEL

REF#	GENERAC#	DESCRIPTION	QTY
11-210	210-70874	ROD, CONNECTING	4
11-213	177-57778	BUSHING, CONNECTING ROD	4
11-214	211-70874	BOLT, CONNECTING ROD	8
11-301	180-57778	CRANKSHAFT	1
11-301J	212-70874	KEY, WOODRUFF PULLEY	1
11-310	213-70874	COVER, REAR	1
11-315	182-57778	PLATE, BAFFLE	1
11-316A	214-70874	GEAR, CRANKSHAFT	1
11-318	215-70874	GASKET, REAR COVER	1
11-3232	216-70874	SPRING, FRICTION GEAR	1
11-3272	217-70874	GEAR, FRICTION	1
11-371	186-57778	PULLEY, CRANKSHAFT	1
11-376	218-70874	BOLT, PULLEY	1
11-377	219-70874	WASHER, PLAIN	1
11-399	220-70874	SEAL, OIL	1
11-500	107-70874	FLYWHEEL	1
11-502	193-57778	FLYWHEEL RING GEAR	1
11-511	109-70874	FLYWHEEL LOCK BOLT	6
11-513	110-70874	WASHER, PLAIN	1
23-105	108-57778	CONNECTING ROD BEARING SET (STD)	1
23-105	196-57778	CONNECTING ROD BEG SET (.25 U.S.)	AR
23-105	197-57778	CONNECTING ROD BEG SET (.50 U.S.)	AR
23-105	198-57778	CONNECTING ROD BRG SET (.76 U.S.)	AR
23-130	105-57778	RING SET, PISTON (STD)	1
23-151	106-57778	MAIN BEARING SET (STD)	1
23-151	199-57778	MAIN BEARING SET (.25 U.S.)	AR
23-151	200-57778	MAIN BEARING SET (.50 U.S.)	AR
23-151	201-57778	MAIN BEARING SET (.76 U.S.)	AR
23-200	221-70874	PISTON SET (STD)	4
23-201	107-57778	THRUST BEARING SET	1

VALVE SYSTEM

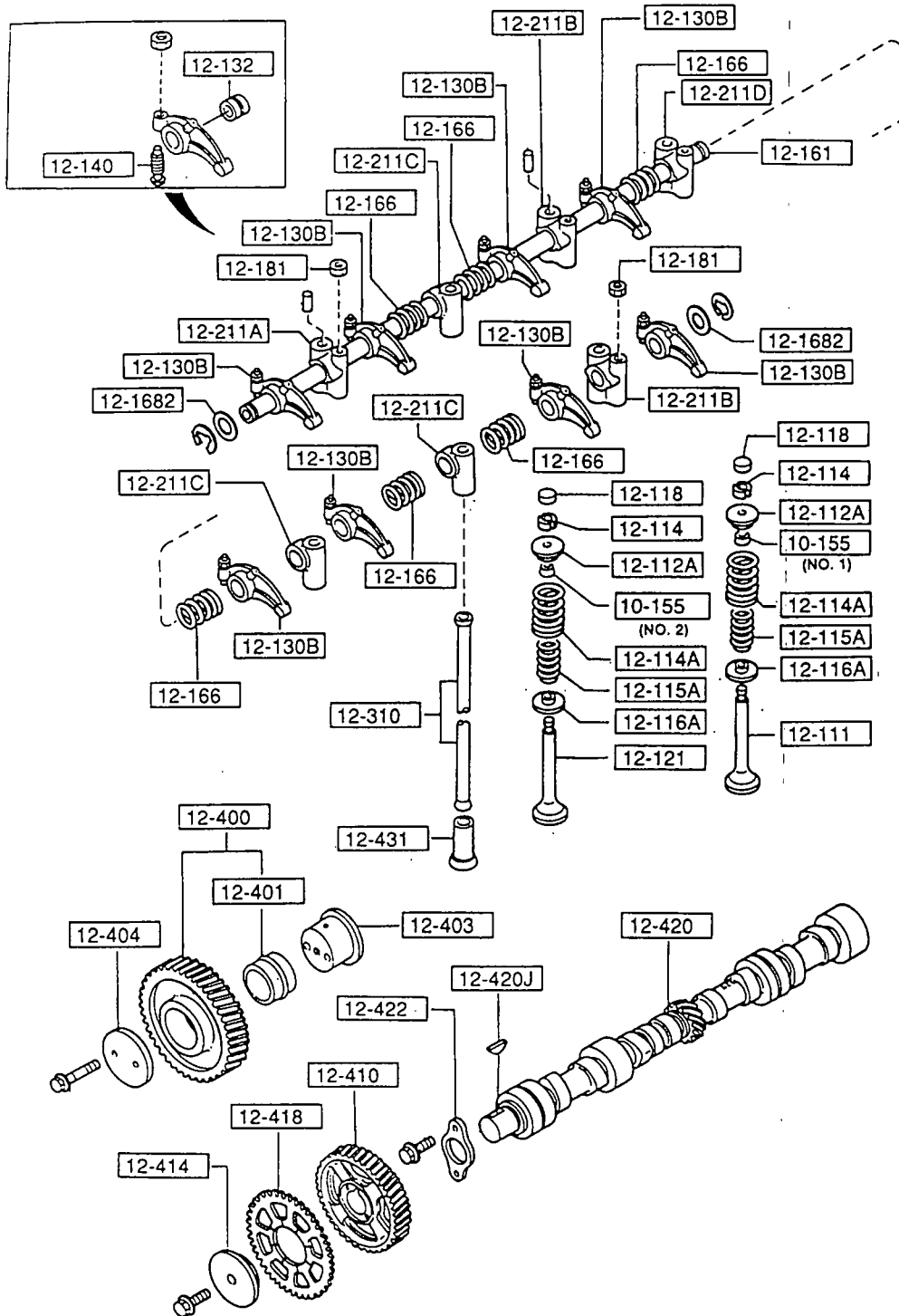

VALVE SYSTEM

REF#	GENERAC#	DESCRIPTION	QTY
10-155	222-70874	SEAL, VALVE	4
12-111	223-70874	VALVE, INTAKE	4
12-112A	203-57778	SEAT, VALVE SPRING UP	8
12-114	224-70874	COTTER, VALVE	16
12-114A	204-57778	OUTER VALVE SPRING	8
12-115A	205-57778	INNER VALVE SPRING	8
12-116A	206-57778	LOWER VALVE SPRING SEAT	8
12-118	208-57778	CAP, VALVE	8
12-121	293-70874	VALVE, EXHAUST	4
12-130B	210-57778	ROCKER ARM	8
12-132	225-70874	ROCKER ARM BUSHING	8
12-140	226-70874	TAPPET ADJUSTING SCREW	8
12-161	227-70874	SHAFT, ROCKER ARM INTAKE	1
12-166	214-57778	SPRING, ROCKER ARM	6
12-1682	215-57778	WASHER	2
12-181	216-57778	NUT	2
12-211A	217-57778	BRACKET, ROCKER	1
12-211B	218-57778	BRACKET, ROCKER	2
12-211C	219-57778	BRACKET, ROCKER	3
12-211D	220-57778	BRACKET, ROCKER	1
12-310	221-57778	PUSH ROD	8
12-400	230-70874	GEAR, IDLE	1
12-401	223-57778	BUSH, IDLE GEAR	1
12-403	294-70874	SPINDLE, IDLE GEAR	1
12-404	225-57778	PLATE, THRUST	1
12-410	231-70874	GEAR, CAM	1
12-414	227-57778	WASHER, LOCK	1
12-418	249-55441	GEAR, FRICTION	1
12-420	228-57778	CAMSHAFT	1
12-420J	229-57778	KEY, WOODRUFF	1
12-422	230-57778	PLATE, THRUST	1
12-431	231-57778	TAPPET (LIFTER)	8

INTAKE MANIFOLD AND RELATED PARTS

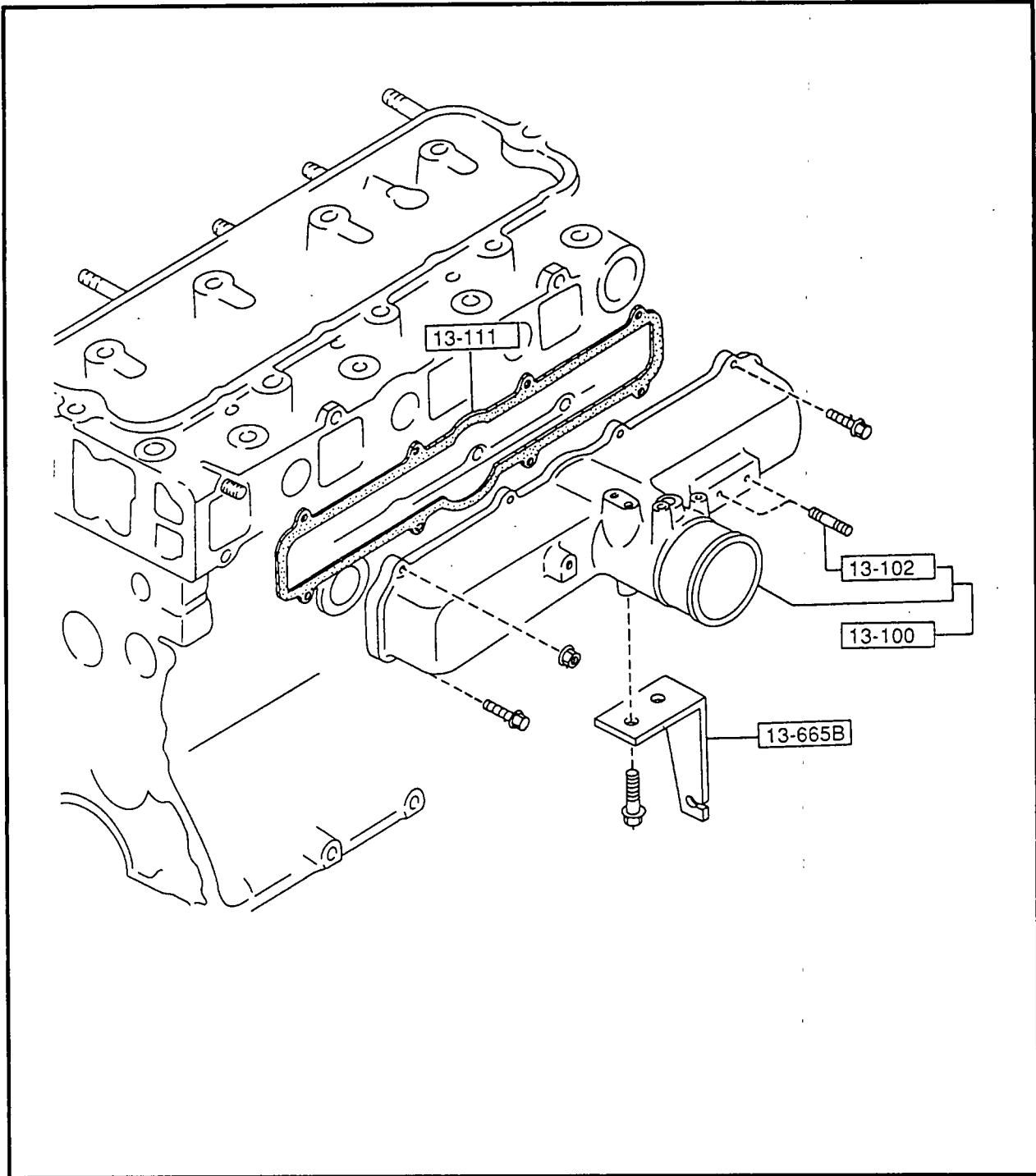

REF#	GENERAC#	DESCRIPTION	QTY
13-100	233-57778	MANIFOLD, INTAKE	1
13-102	234-70874	STUD	2
13-111	235-70874	GASKET, INTAKE MANIFOLD	1
13-665B	115-70874	BRACKET, ACCEL WIRE	1

EXHAUST MANIFOLD AND RELATED PARTS

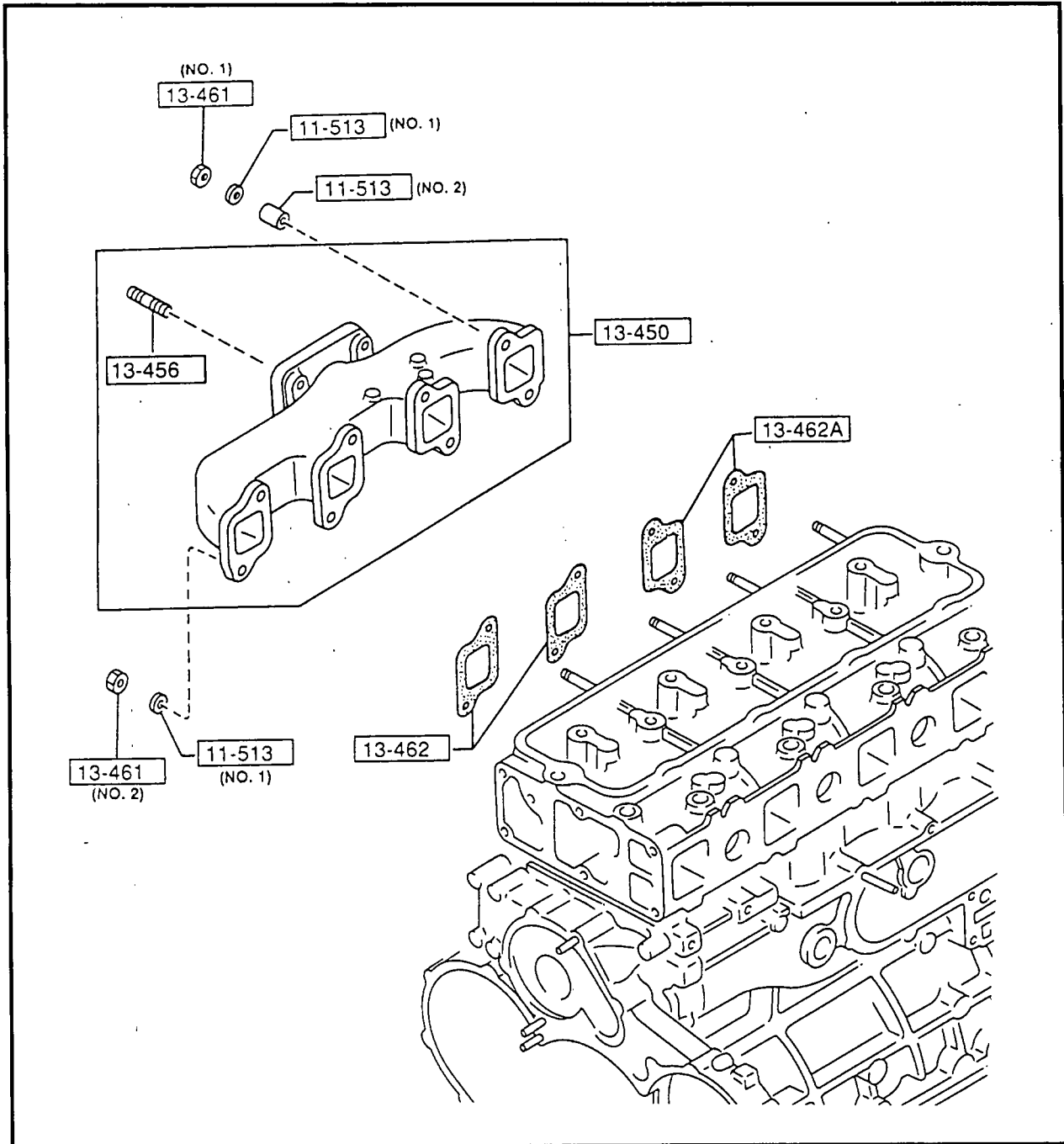

REF#	GENERAC#	DESCRIPTION	QTY
11-513	242-67057	WASHER, PLAIN	8
13-450	236-70874	MANIFOLD, EXHAUST	1
13-456	237-70874	STUD	4
13-461	245-67057	NUT, EXHAUST MANIFOLD	4
13-462	238-57778	GASKET, EXHAUST MANIFOLD	2
13-462A	238-57778	GASKET, EXHAUST MANIFOLD	2
13-4752	57594	GASKET, ELBOW	1

FUEL SYSTEM

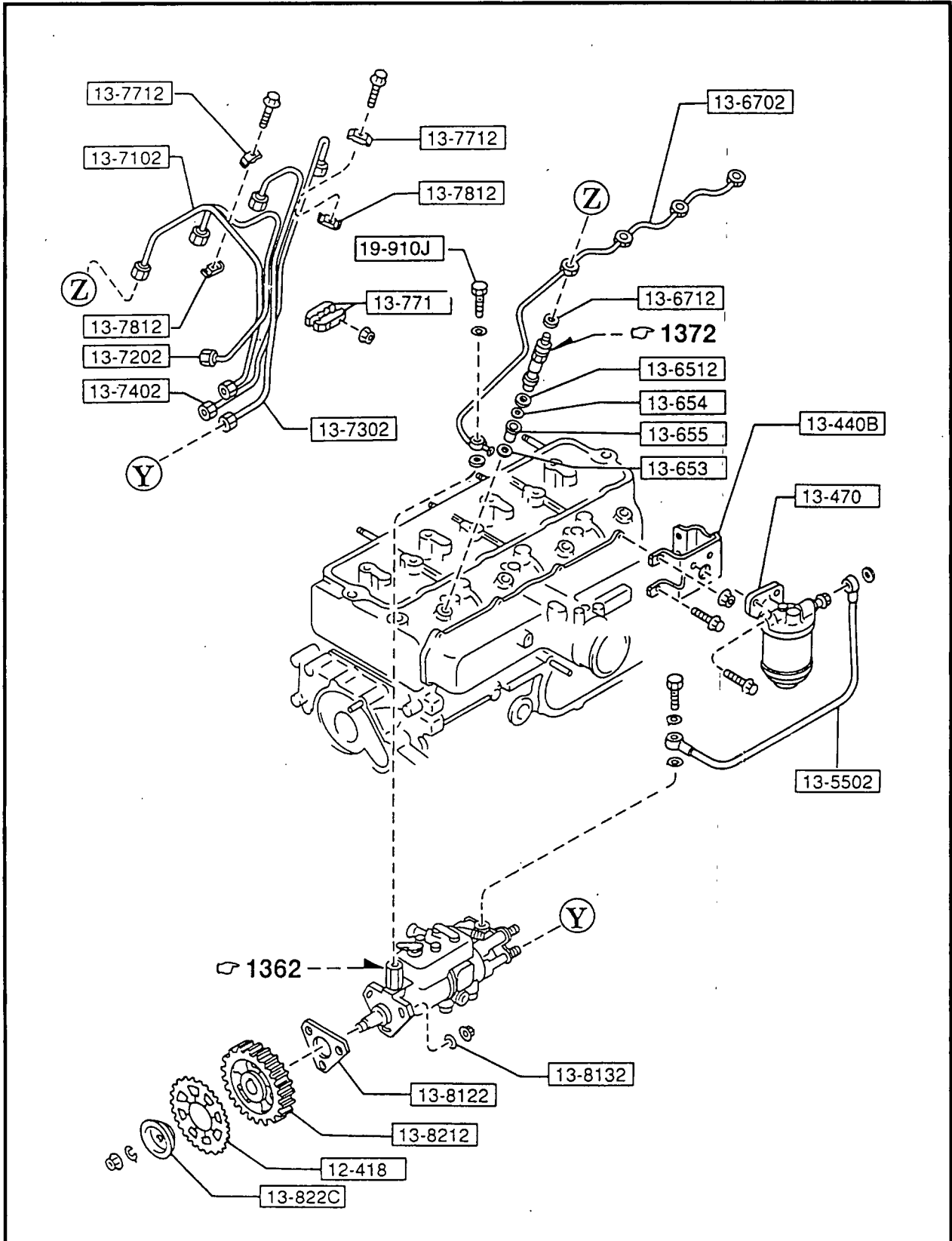

FUEL SYSTEM

REF#	GENERAC#	DESCRIPTION	QTY
12-418	240-70874	GEAR, FRICTION	1
13-440B	112-70874	BRACKET, FUEL FILTER	1
13-470	100-67057	FUEL FILTER	1
13-5502	114-70874	PIPE	1
13-6512	251-67057	WASHER, NOZZLE	4
13-653	269-55441	GASKET	4
13-655	246-57778	SHIELD, HEAT	4
13-6702	116-70874	PIPE, FUEL LEAK	1
13-6712	254-67057	GASKET, LEAK PIPE	4
13-7102	118-70874	PIPE, # 1 FUEL INJECTION	1
13-7202	119-70874	PIPE, # 2 FUEL INJECTION	1
13-7302	120-70874	PIPE, # 3 FUEL INJECTION	1
13-7402	121-70874	PIPE, # 4 FUEL INJECTION	1
13-771	241-70874	CLIP, INJECTION PIPE	2
13-7712	242-70874	CLIP, PIPE	2
13-7812	243-70874	CLIP, INJECTION PIPE	2
13-8002	100-70874	FUEL INJECTION PUMP	1
13-8122	123-70874	GASKET, INJECTION PUMP	1
13-8132	124-70874	WASHER, PLAIN	3
13-8212	125-70874	GEAR, INJECTION PUMP	1
13-822C	126-70874	WASHER, PLAIN	1
19-910J	244-70874	BOLT, CONNECTOR	1
23-570A	142-70874	FUEL FILTER ELEMENT	1

NOZZLE HOLDER AND SEDIMENTER

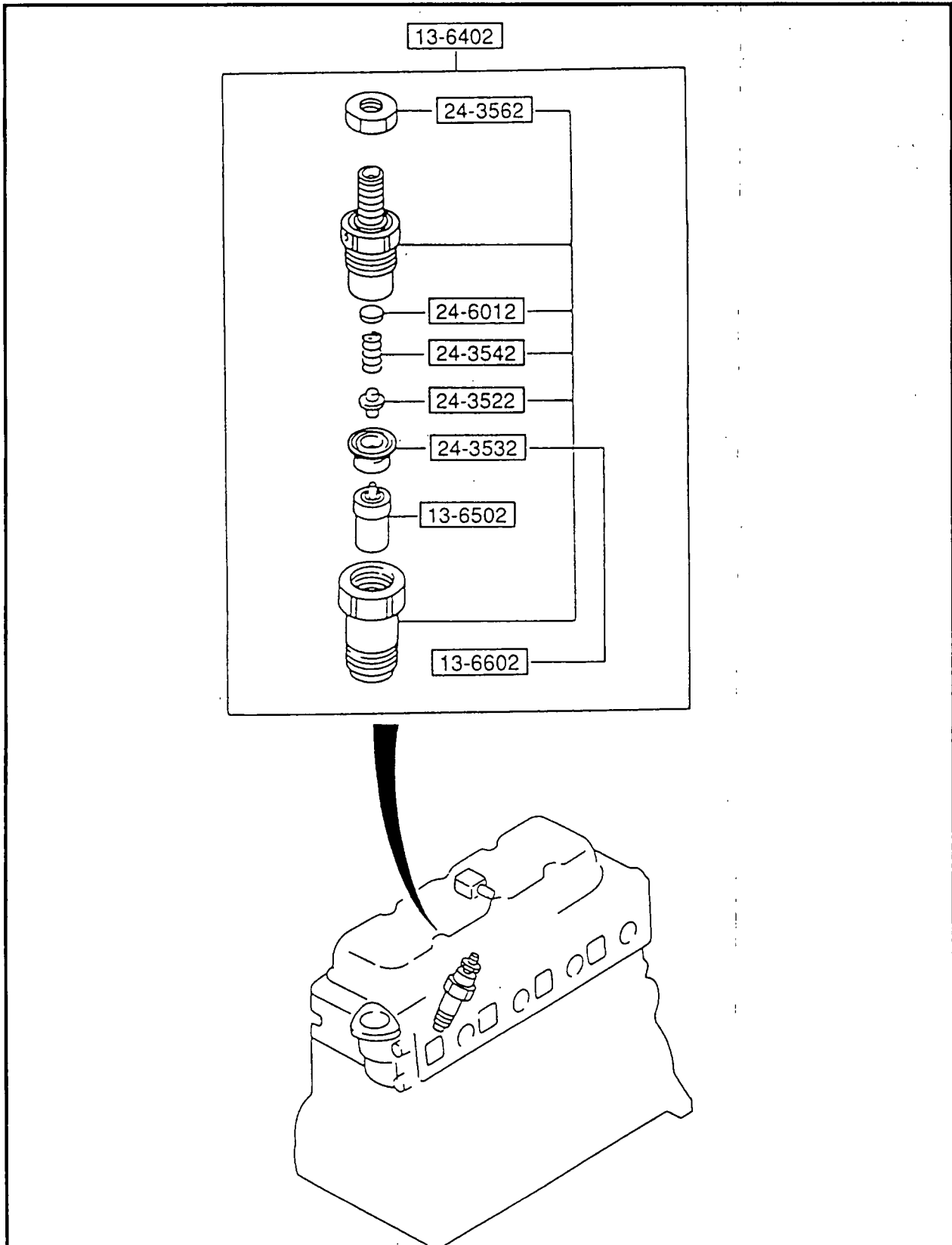

NOZZLE HOLDER AND SEDIMENTER

REF#	GENERAC#	DESCRIPTION	QTY
13-6402	118-57778	HOLDER, NOZZLE	4
13-6502	474-55441	NOZZLE	4
13-6602	398-57778	HOLDER, NOZZLE	4
24-3522	272-87057	ROD, PUSH-NOZZLE HOLDER	4
24-3532	273-87057	SHEET, NOZZLE SPRING	4
24-3542	274-87057	SPRING	4
24-3562	275-87057	NUT, SCREW CAP	4
24-6012	403-57778	SHIM .50 mm	4
24-6012	404-57778	SHIM .54 mm	4
24-6012	405-57778	SHIM .58 mm	4
24-6012	406-57778	SHIM .62 mm	4
24-6012	407-57778	SHIM .66 mm	4
24-6012	408-57778	SHIM .70 mm	4
24-6012	409-57778	SHIM .74 mm	4
24-6012	410-57778	SHIM .78 mm	4
24-6012	411-57778	SHIM .82 mm	4
24-6012	412-57778	SHIM .86 mm	4
24-6012	413-57778	SHIM .90 mm	4
24-6012	414-57778	SHIM .94 mm	4
24-6012	415-57778	SHIM .98 mm	4
24-6012	416-57778	SHIM 1.02 mm	4
24-6012	417-57778	SHIM 1.06 mm	4
24-6012	418-57778	SHIM 1.10 mm	4
24-6012	419-57778	SHIM 1.14 mm	4
24-6012	420-57778	SHIM 1.18 mm	4
24-6012	421-57778	SHIM 1.22 mm	4
24-6012	422-57778	SHIM 1.26 mm	4
24-6012	423-57778	SHIM 1.30 mm	4
24-6012	424-57778	SHIM 1.34 mm	4
24-6012	425-57778	SHIM 1.38 mm	4
24-6012	426-57778	SHIM 1.42 mm	4
24-6012	427-57778	SHIM 1.46 mm	4
24-6012	428-57778	SHIM 1.50 mm	4
24-6012	429-57778	SHIM 1.54 mm	4

OIL PUMP AND FILTER RELATED PARTS

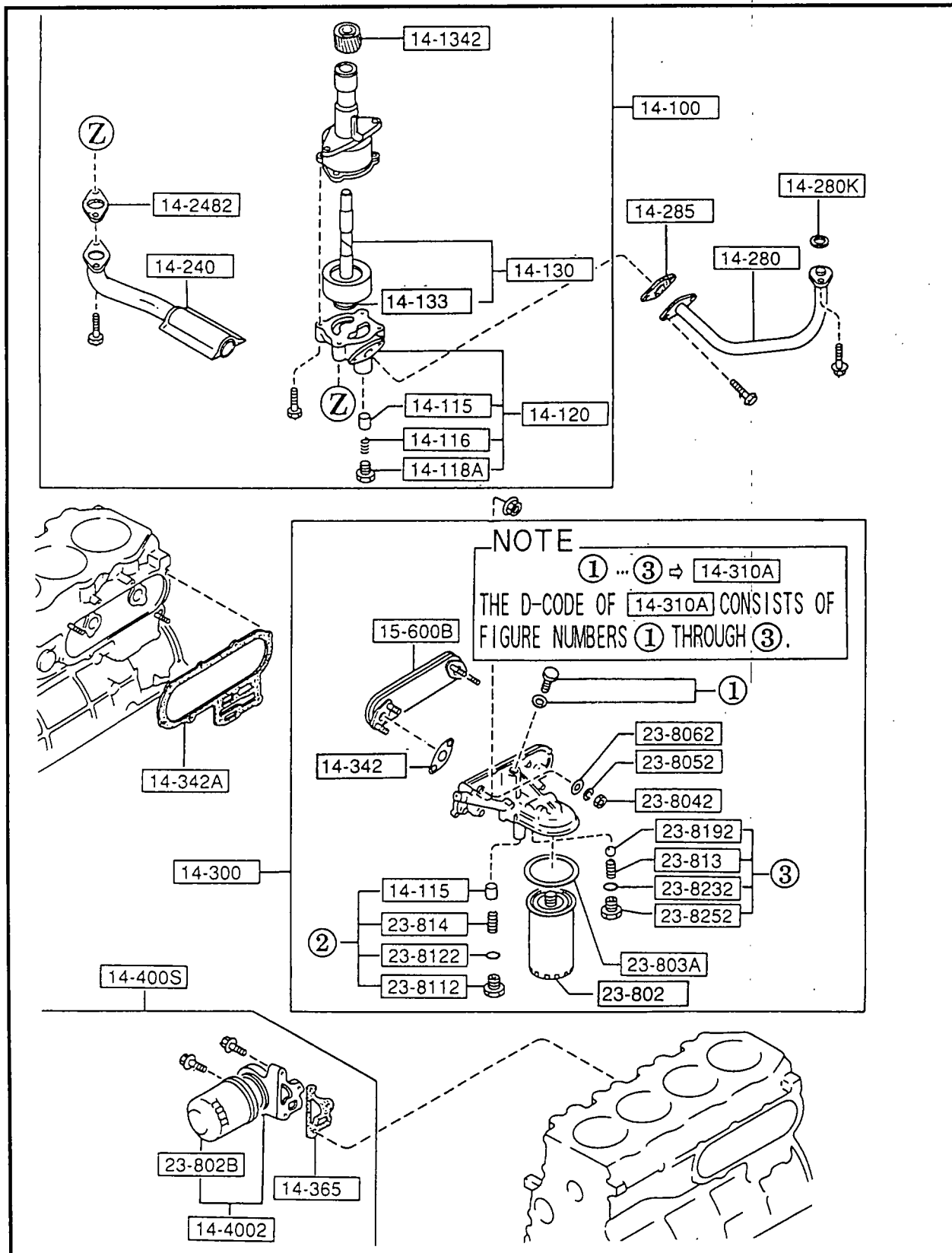

OIL PUMP AND FILTER RELATED PARTS

REF#	GENERAC#	DESCRIPTION	QTY
14-100	173-70874	OIL PUMP	1
14-115	289-57057	PLUNGER CONTROL	2
14-116	252-70874	SPRING, PRESSURE	1
14-118A	433-57778	PLUG	1
14-120	434-57778	COVER, OIL PUMP	1
14-130	254-70874	SHAFT DRIVE	1
14-133	436-57778	PIN, GROOVED	2
14-1342	437-57778	GEAR DRIVE	1
14-240	256-70874	STRAINER, OIL	1
14-2482	257-70874	GASKET, SUCTION PIPE	1
14-280	441-57778	PIPE, OIL	1
14-280K	442-57778	O-RING	1
14-285	258-70874	GASKET, OIL PIPE	1
14-300	259-70874	FILTER, OIL	1
14-310A	260-70874	BODY, OIL FILTER	1
14-342	261-70874	GASKET	2
14-342A	262-70874	GASKET, OIL FILTER	1
14-365	263-70874	GASKET	1
14-400S	264-70874	FILTER SET, OIL BYPASS	1
14-4002	265-70874	FILTER, OIL BYPASS	1
15-600B	266-70874	COOLER, OIL	1
23-802	101-57778	OIL FILTER CARTRIDGE	1
23-802B	268-70874	CARTRIDGE, OIL FILTER BYPASS	1
23-803A	269-70874	GASKET	1
23-8042	450-57778	NUT	4
23-8052	451-57778	WASHER, SPRING	4
23-8062	452-57778	WASHER	4
23-8112	305-67057	PLUG	1
23-8122	307-67057	O-RING	1
23-813	270-70874	SPRING	1
23-814	457-57778	SPRING, VALVE	1
23-8192	459-57778	BALL, STEEL	1
23-8232	460-57778	O-RING	1
23-8252	461-57778	PLUG	1

COOLING SYSTEM AND RELATED PARTS

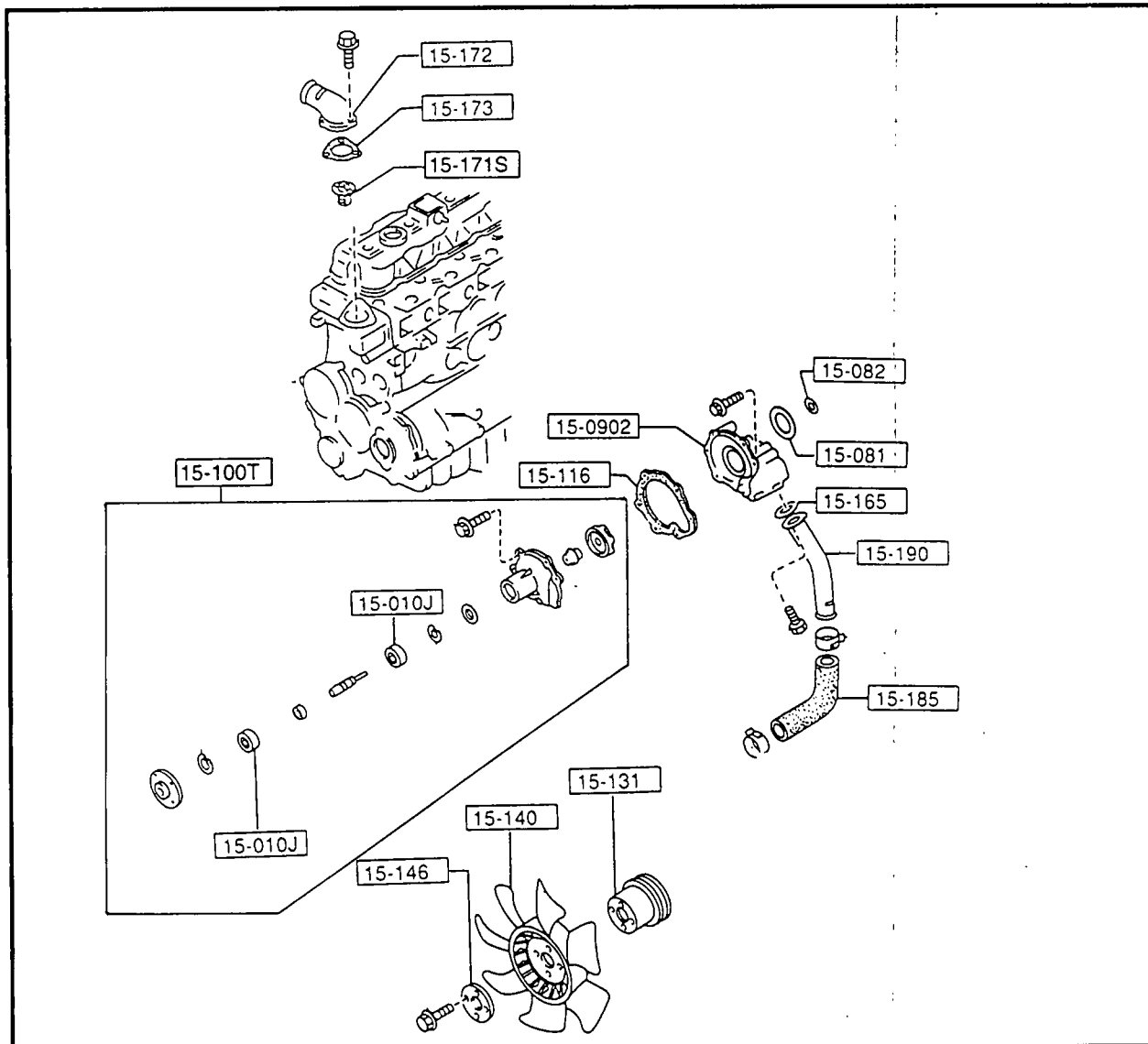

REF#	GENERAC#	DESCRIPTION	QTY
15-010J	462-57778	BEARING, BALL	2
15-081	465-57778	GASKET	1
15-082	466-57778	GASKET	1
15-0902	467-57778	BODY, WATER PUMP	1
15-100T	292-70874	HOUSING SET, BEARING WATER PUMP	1
15-116	470-57778	GASKET, WATER PUMP	1
15-131	474-57778	PULLEY, WATER PUMP	1
15-140	475-57778	FAN, COOLING	1
15-146	271-70874	WASHER, FAN	1
15-165	272-70874	GASKET, WATER PUMP INLET	1
15-171S	273-70874	THERMOSTAT SET	1
15-172	476-57778	COVER, THERMOSTAT	1
15-173	477-57778	GASKET, THERMOSTAT COVER	1
15-185	478-57778	HOSE, WATER	1
15-190	274-70874	PIPE, WATER	1

ENGINE ELECTRICAL SYSTEM

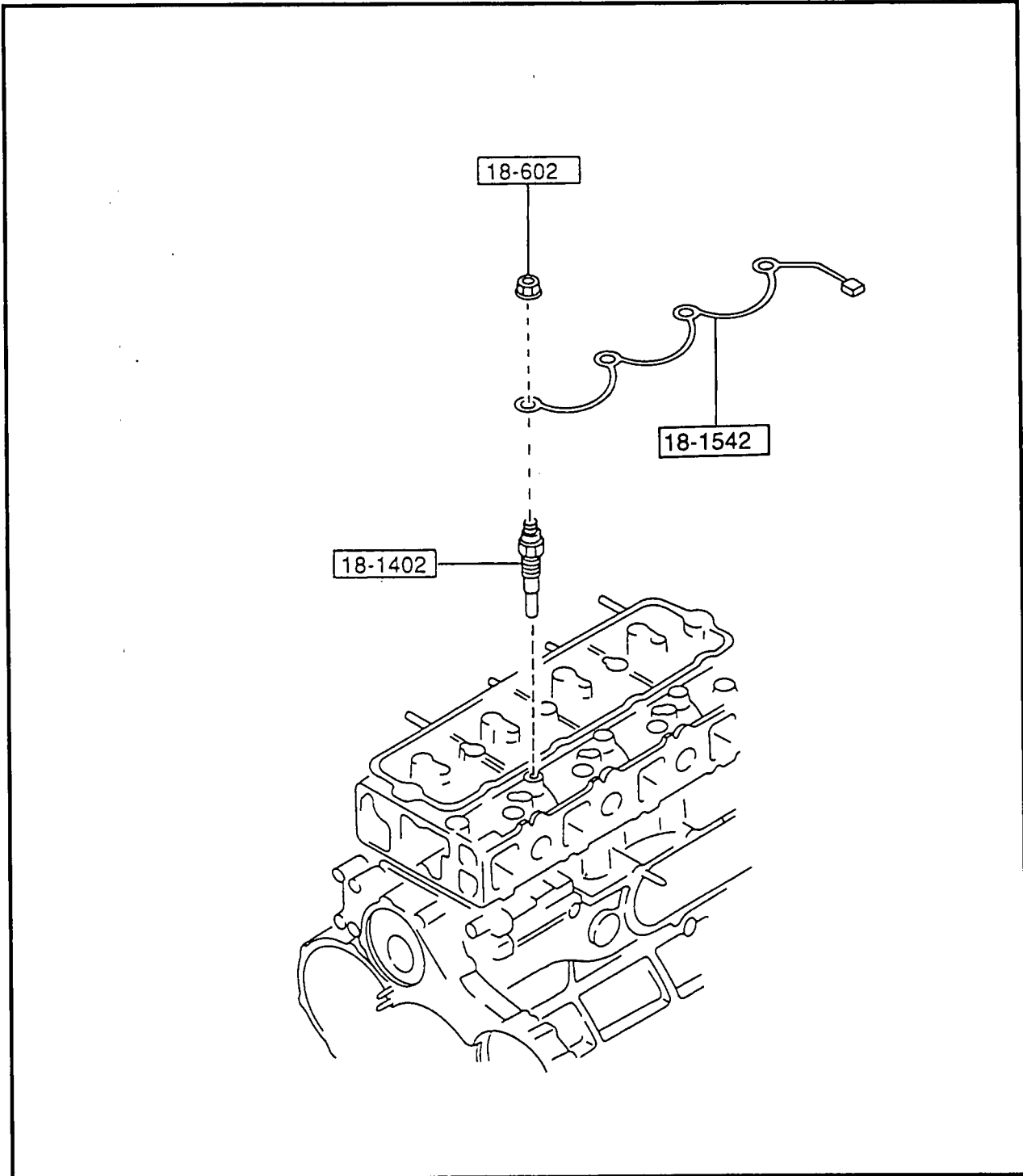

REF#	GENERAC#	DESCRIPTION	QTY
18-1402	482-57778	GLOW PLUGS	4
18-1542	275-70874	GLOW PLUG CONNECTOR	1
18-602	334-67057	NUT, FLANGE GLOW PLUG	4

TURBOCHARGER AND AIR FILTER RELATED PARTS

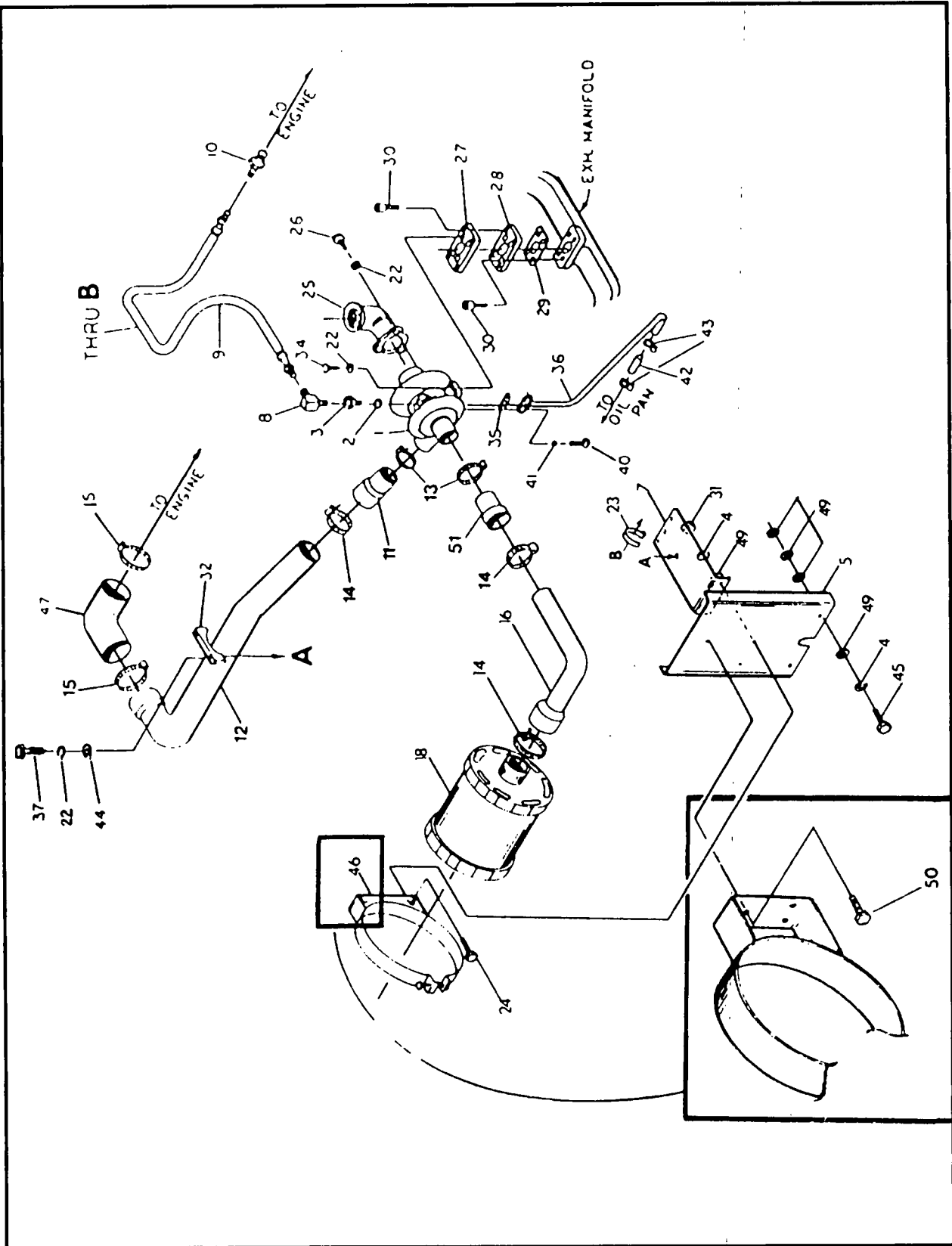

TURBOCHARGER AND AIR FILTER RELATED PARTS

REF#	GENERAC#	DESCRIPTION	QTY
1	64075	TURBOCHARGER	1
2	64093	SEAL (COPPER WASHER)	1
3	64092	ADAPTOR M10 TO 1/8" NPT	1
4	46526	LOCK WASHER M10	5
5	73352	BRACKET, AIR CLEANER SUPPORT	1
7	71805	SUPPORT, TURBO INTAKE TUBE	1
8	64094	ADAPTOR, 1/8" NPT X 1/2"-20 X37"	1
9	64947	OIL LINE, ENGINE TO TURBOCHARGER	1
10	64944	ADAPTOR 3/8" NPT X 1/2"-20 X 37"	1
11	59999G	TURBO REDUCER CONNECTOR 2" X 1-3/4"	1
12	64941	TUBE, AIR INTAKE	1
13	35685	CLAMP, 2-1/4" MAXIMUM	2
14	42561	CLAMP, 2-3/4" MAXIMUM	3
15	39294	CLAMP, 3-1/4" MAXIMUM	2
16	73356	CONNECTION, AIR CLEANER HOSE	1
18	73267	AIR CLEANER	1
22	22129	LOCK WASHER, M8	9
23	29333	TIE WRAP 7" LONG	2
24	49814	HHCS M10-1.50 X 25 mm	2
25	62979	ADAPTOR, TURBOCHARGER TO EXHAUST	1
26	43107	HHCS M8-1.25 X 25 mm	3
27	63508	ADAPTOR, UPPER TURBOCHARGER	1
28	64943	ADAPTOR, LOWER TURBOCHARGER	1
29	57594	GASKET, EXHAUST MANIFOLD	1
30	48527	SHCS 3/8"-16 X 3/4"	8
31	45772	NUT, HEX M10-1.50	3
32	44209	SADDLE, U-BOLT	1
34	39253	CAPSCREW, M8-1.25 X 20 mm	4
35	64417	GASKET, OIL RETURN	1
36	64946	LINE, OIL RETURN	1
37	23258	CAPSCREW, 5/16"-18 X 3-1/4"	2
39	58943D	PIPE, FLEXIBLE EXHAUST 2" NPT X 10.75"	1
40	47411	CAPSCREW, M6-1.00 X 16 mm	2
41	22097	LOCK WASHER, M6	2
42	64948	REDUCER, 5/8" X 1/2"	1
43	57822	CLAMP, 1" MAXIMUM	2
44	22145	FLAT WASHER 5/16"	2
45	52211	CAPSCREW, M10-1.25 X 40 mm	2
46	73354	STRAP, AIR CLEANER	1
47	57759	ELBOW, 90 DEGREE 2-1/2" I.D.	1
49	22131	FLAT WASHER, M10	11
50	51756	CAPSCREW, HEX HEAD M10-1.50 X 20 mm	1
51	64085	COUPLING, REDUCER-RUBBER	1

ENGINE FINISH PARTS

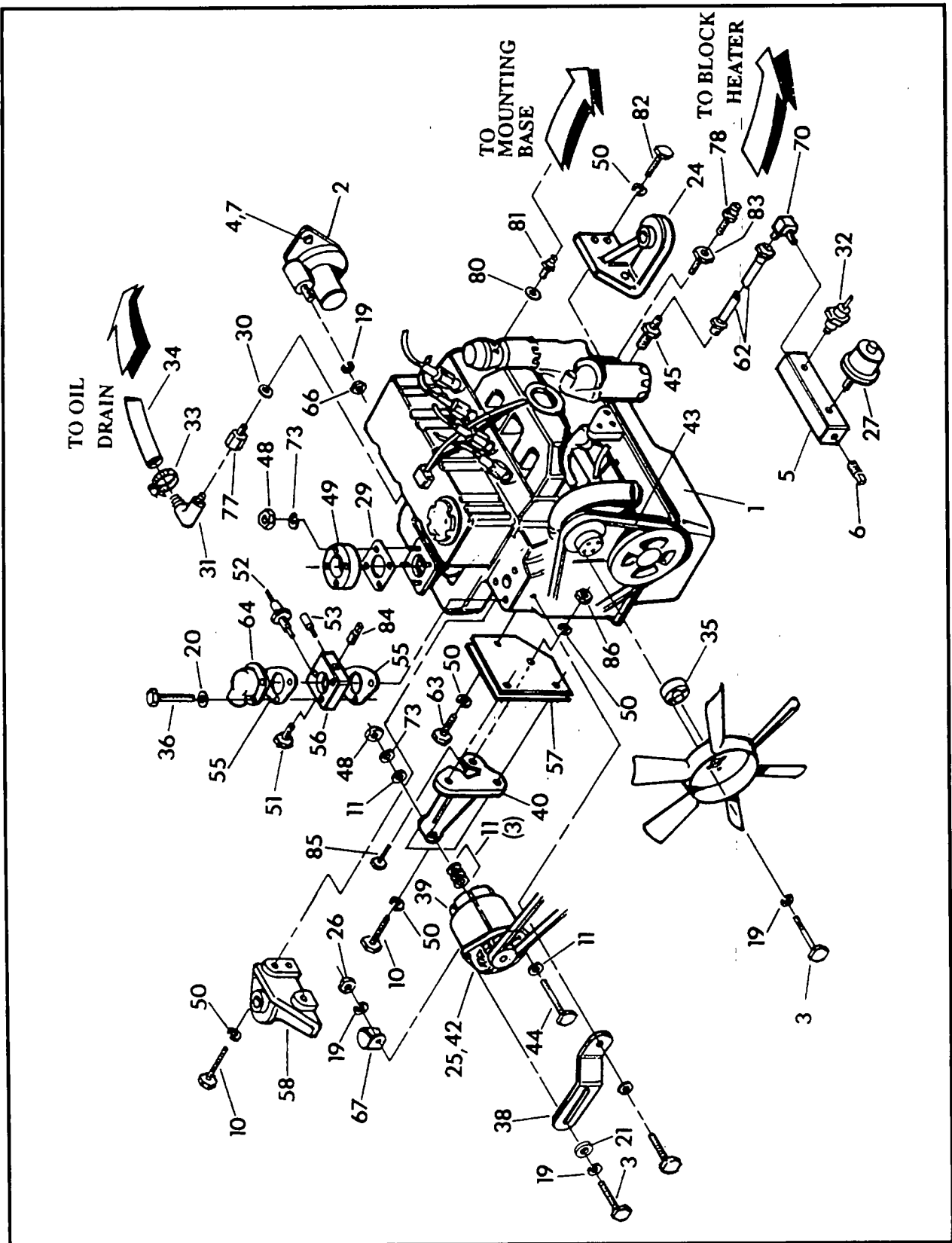

ENGINE FINISH PARTS

REF#	GENERAC#	DESCRIPTION	QTY
1	70874	ENGINE, 3.0 LITER DIESEL	1
2	57589	STARTER ASSEMBLY	1
3	39287	CAPSCREW, HEX HEAD M8-1.25 X 45 mm	5
4	53607	CAPSCREW, HEX HEAD M12-1.75 X 35 mm	3
5	66248	MANIFOLD, OIL SENDER	1
6	61012	PLUG, PIPE 1/8" NPT	1
7	51769	LOCK WASHER M12	1
10	52211	CAPSCREW, HEX HEAD M10-1.25 X 40 mm	5
11	22131	FLAT WASHER, M10	5
19	22129	LOCK WASHER	6
20	22145	FLAT WASHER, 5/16"	7
21	50190	FLAT WASHER, 10 GAUGE X .34 X 1.0	1
24	69579	ENGINE MOUNT	1
25	50619	FAN, GENERATOR	1
26	45771	NUT, HEX M8-1.25	1
27	53666	SENDER, OIL PRESSURE	1
29	57594	GASKET, EXHAUST MANIFOLD	1
30	57772	WASHER, (NYLON)	1
31	34339	ELBOW, BARBED 90 DEGREE 3/8" X 5/8"	1
32	60108	SWITCH, OIL PRESSURE	1
33	57823	CLAMP, HOSE # 10	1
34	57448	HOSE, 5/8" I.D. X 11" LONG	1
35	57722	SPACER, FAN	1
36	52265	CAPSCREW, HEX HEAD M8-1.25 X 65 mm	3
38	58903	STRAP, DC ALTERNATOR ADJUSTING	1
39	50618	ALTERNATOR, D.C.	1
40	55517	BRACKET, D.C. ALTERNATOR MOUNTING	1
42	57771	PULLEY, D.C. ALTERNATOR	1
43	58012	V-BELT	1
44	30210	CAPSCREW, HEX HEAD 3/8"-16 X 5"	1
45	42574	ADAPTOR	1
48	22241	NUT, HEX 3/8"-16	5
49	55531	FLANGE, EXHAUST ADAPTOR	1
50	46526	LOCK WASHER, M10	12
51	57522	SWITCH, WATER LEVEL	1
52	35606	SWITCH, WATER TEMPERATURE	1
53	53667	SENDER, WATER TEMPERATURE	1
55	57750	GASKET, THERMOSTAR	2
56	57756	SPACER, THERMOSTAT HOUSING	1
57	50039	ADAPTOR, ALTERNATOR BRACKET	2
58	69575	ENGINE MOUNT	1
62	64095	LINE, OIL	1
63	52212	CAPSCREW, HEX HEAD M10-1.25 X 25 mm	1
64	57778	COVER, THERMOSTAR HOUSING	1
67	55934D	CLAMP, HOSE 1-1/16 X 13/32"	1
70	66235	ELBOW	1
73	22237	LOCK WASHER 3/8"	5
77	59619	ADAPTOR, OIL DRAIN	1
78	44117	FITTING, BARBED STRAIGHT 1/4" X 5/8"	1
80	55853	WASHER, SEAL	1
81	55852	FITTING, BARBED STRAIGHT 5/16"	1
82	52830	CAPSCREW, HEX HEAD M10-1.25 X 45 mm	3
83	62303	ADAPTOR, 120-B	1
84	31919	PIPE PLUG, 3/8" SOCKET	1
85	62963	CAPSCREW, HEX HEAD M10-1.25 X 30 mm	1
86	46525	HEX NUT, 10mm-1.25	1

