

0E5226

GENERAC[®]
POWER SYSTEMS, INC.

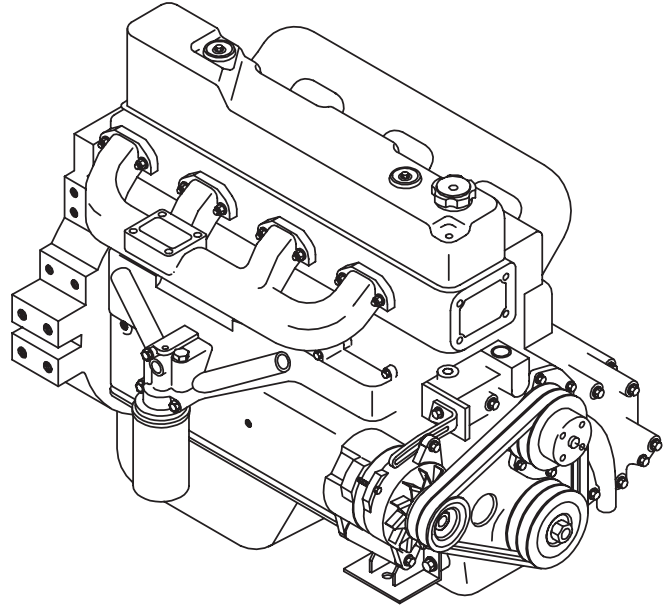

3.9 LITER

D I E S E L

ENGINE
PARTS
MANUAL

3.9L DIESEL TABLE OF CONTENTS

QUICK REFERENCE GUIDE	2
SERVICE RECOMMENDATIONS	4
ENGINE OVERHAUL GASKET KIT	8
SHORT ENGINE ASSEMBLY	9
CYLINDER HEAD ASSEMBLY	10
CYLINDER BLOCK ASSEMBLY	11
LINER AND PISTON KIT	12
CRANKSHAFT ASSEMBLY	13
ROCKER COVER AND BREATHER	14
CYLINDER HEAD	15
CYLINDER BLOCK	16
OIL PAN AND GAUGE	18
FLYWHEEL AND HOUSING	19
PISTON AND CONNECTING ROD	20
CAMSHAFT AND VALVE	21
TIMING GEAR	22
ATTACHING PARTS	23
ENGINE MOUNTING & SUPPORT	24
OIL PUMP AND STRAINER	25
OIL FILTER	26
OIL COOLER	27
OIL LINE	28
FUEL FILTER AND HOSE	29
FUEL INJECTION PUMP GENERAL	30
FUEL INJECTION PUMP	31
INJECTION PUMP GOVERNOR	34
FUEL FEED PUMP	38
COUPLING	39
INJECTION PIPE & NOZZLE	40
FUEL RETURN HOSE	41
WATER PUMP AND BELT	42
WATER PIPE AND THERMOSTAT	43
MANIFOLDS & TURBOCHARGER	44
STARTER, GLOW PLUGS & ALTERNATOR	45
ENGINE COMMON PARTS	46
RADIATOR	48
ELECTRONIC GOVERNOR	50
EXHAUST	51
WATER SEPARATOR	52
BLOCK HEATER	53

LEGEND

**“AR” AS REQUIRED
(STD) STANDARD SIZE
“O.S.” OVERSIZE
“U.S.” UNDERSIZE**

NOTICE!

THE INFORMATION IN THIS MANUAL IS KNOWN TO BE ACCURATE AS OF THE DATE OF RELEASE SHOWN ON THE COVER. HOWEVER, ENGINEERING CHANGES CAN OCCUR WITHOUT NOTICE. TO OBTAIN THE PROPER PARTS, PLEASE BE SURE TO USE THE MODEL NUMBER OF THE UNIT BEING SERVICED WHEN ORDERING FROM THIS MANUAL.

3.9L DIESEL QUICK REFERENCE GUIDE

SPECIFICATIONS:

CRANKCASE OIL CAPACITY:
COOLING SYSTEM CAPACITY:

6.0 U.S. GALLONS (22.7 LITERS)
11.2 U.S. GALLONS (42.4 LITERS)

RECOMMENDED FLUIDS

COOLANT:

USE A 50/50 MIXTURE OF LOW SILICATE ETHYLENE GLYCOL BASE ANTI-FREEZE AND SOFT WATER. (IF DESIRED, A HIGH QUALITY RUST INHIBITOR MAY BE ADDED TO THE RECOMMENDED COOLANT MIXTURE.) WHEN ADDING COOLANT, ALWAYS ADD THE RECOMMENDED 50/50 MIXTURE.

ENGINE OIL:

USE A HIGH QUALITY DETERGENT OIL HAVING AAPI CLASSIFICATION "FOR SERVICE CC OR CD." THE SAE VISCOSITY RATING OF THE OIL SHOULD BE CAREFULLY SELECTED, BASED ON THE PREVAILING AMBIENT TEMPERATURE RANGE ANTICIPATED BEFORE THE NEXT OIL CHANGE. RECOMMENDED SAE VISCOSITY GRADES ARE AS FOLLOWS:

TEMPERATURE	RECOMMENDED OIL GRADE
ABOVE 90°F	SAE 40
32°F TO 90°F	SAE 30
12°F TO 32°F	SAE 20

3.9L DIESEL QUICK REFERENCE GUIDE

QUICK REFERENCE ENGINE PARTS

PART NUMBER	DESCRIPTION	QTY
0D58250105	GASKET KIT, ENG OVERHAUL	1
0D58250103	SLEEVE & PISTON KIT (FOR ONE ENGINE)	1
0D58250139	BEARING SET, CRKSHFT	1
0D58250142	OIL SEAL, CRKSHFT, RR	1
0D58250211	OIL PUMP ASY, ENG	1
0D58250227	OIL FILTER	1
0D58250250	FUEL FILTER 1	
0D58250261	PUMP ASY, INJ PUMP FUEL FEED	1
0D58250448	NOZZLE & HOLDER ASY, FUEL, INJ	4
0D58250476	WATER PUMP ASY	1
0D58250477	BELT, ALTERNATOR & OTHERS, 1140X2	1
0D58250495	GLOW PLUG	4
0D58250481	THERMOSTAT KIT	1
090635	AIR CLEANER, 7-3/4	1

3.9L DIESEL SERVICE RECOMMENDATIONS

40 KW - 400 KW STANDBY DIESEL ENGINE DRIVEN GENERATOR SETS

Following is a recommended maintenance schedule for Generac standby diesel engine driven generator sets from 40 kW to 400 kW in size. The established intervals in the schedule are the *maximum* recommended when the unit is used in an average service application. They will need to be decreased (performed more frequently) if the unit is used in a severe application. Use the unit hour meter or calendar time, whichever occurs first, from the previous maintenance interval to determine the next required maintenance interval.

Service Maintenance Interval Information:

The various service maintenance intervals are designated by interval numbers as follows:

- 1 An early inspection of the generator set to insure it is ready to operate when required and to identify any potential problem areas.

Performed monthly or following each 10 hours of operation of the unit and requires approximately .5 man-hours per unit to complete.

This inspection may be performed by the end user providing the following safety steps are taken to prevent the engine from starting automatically without warning:

To prevent injury, perform the following steps in the order indicated before starting any maintenance:

- **Disable the generator set from starting and/or connecting to the load by setting the control panel Auto-Off-Manual switch to the "OFF" position.**
- **Remove the control panel fuse.**
- **Turn off the battery charger.**
- **Remove the negative battery cable.**

The battery charger must be turned off BEFORE removing the battery cable to prevent an over current condition from burning out sensitive control panel components and circuits.

Following all maintenance, reverse these steps to insure the unit is returned to standby setup for normal operation when required.

- 2 A break-in service inspection of the generator set to insure it is ready to operate and carry the load when required, and to identify any potential problem areas.

*Performed **ONLY ONCE** following the first three months or the first 30 hours of operation after purchase of the unit and requires approximately 2.5 man-hours per unit to complete.*

This inspection contains some maintenance tasks which require special tools, equipment, and/or knowledge to accomplish and should be performed only by an authorized Generac Service Dealer.

- 3 An operational inspection of the generator set to insure it is ready to operate and carry the load when required, and to identify any potential problem areas.

Performed semi-annually or following each 50 hours of operation of the unit and requires approximately 1.5 man-hours per unit to complete.

This inspection contains some maintenance tasks which require special tools, equipment, and/or knowledge to accomplish and should be performed only by an authorized Generac Service Dealer.

- 4 A mid-level inspection of the generator set to insure it is ready to operate and carry the load when required, and to identify any potential problem areas.

Performed annually or following each 100 hours of operation of the unit and requires approximately 5.0 man-hours per unit to complete.

This inspection contains some maintenance tasks which require special tools, equipment, and/or knowledge to accomplish and should be performed only by an authorized Generac Service Dealer.

NOTE: Add 20% to all times for 8 cylinder or larger engines.

GENERAC POWER SYSTEMS, INC.

RECOMMENDED SCHEDULED MAINTENANCE PROGRAM

SERVICE WORK TO BE PERFORMED BY FACTORY-TRAINED PERSONNEL ONLY.

DEALER INFORMATION

NAME: _____
ACCOUNT #: _____
ADDRESS: _____
PHONE: _____
TECHNICIAN: _____
SIGNATURE: _____

OWNER INFORMATION

NAME: _____
ADDRESS: _____
SITE: _____
PHONE: _____
SIGNATURE: _____

PURCHASE DATE: _____ START-UP DATE: _____

APPLICATION: ___ Standby Power ___ Prime Power ___ Rental/Trailerized

GENERATOR & TRANSFER SWITCH INFORMATION

GENERATOR

MODEL NUMBER: _____
SERIAL NUMBER: _____

TRANSFER SWITCH

MODEL NUMBER: _____
SERIAL NUMBER: _____

HOUR METER READING at Completion of the Inspection: _____

▲ WARNING! ▲

To prevent injury, perform the following steps in the order indicated before starting any maintenance:

- Disable the generator set from starting and/or connecting to the load by setting the control panel Auto-Off-Manual switch to the "OFF" position.
- Remove the control panel fuse.
- Turn off the battery charger.
- Remove the negative battery cable.

NOTE:

















The battery charger must be turned off BEFORE removing the battery cable to prevent an over current condition from burning out sensitive control panel components and circuits.

Following all maintenance, reverse these steps to insure the unit is returned to standby setup for normal operation when required.

3.9L DIESEL SERVICE RECOMMENDATIONS

Maintenance Tasks	Level 1	Task Comp. (Date-Initials)	Level 2	Task Comp. (Date-Initials)	Level 3	Task Comp. (Date-Initials)	Level 4	Task Comp. (Date-Initials)
	Recommended to be done monthly/ 10 hrs.		Required to be done 3 months/ Break-in 30 hrs.		Required to be done Semi-annually/ 50 hrs.		Required to be done Annually/ 100 hrs.	
1. Disable the unit from operating per the first page warning.	○		○		○		○	
2. Check the engine oil level. Adjust as necessary.	○		○		○		○	
3. Check the engine coolant level. Adjust as necessary.	○		○		○		○	
4. Check the engine coolant thermal protection level. Correct as necessary.							○	
5. Check the diesel fuel supply level. Fill as necessary.	○		○		○		○	
6. Drain water and sediment from the diesel fuel tank.			○		○		○	
7. Drain water from the fuel line water separator if the unit is equipped with one.			○		○		○	
8. Check the air inlets and outlets for debris. Clean as necessary.	○		○		○		○	
9. Check the battery electrolyte level if accessible. Adjust as necessary.	○		○		○		○	
10. Check the battery posts, cables, and charger for loose connections, corrosion, and proper operation. Correct as necessary.	○		○		○		○	
11. Check the unit wiring for loose connections, corrosion, and damage. Correct as necessary.							○	
12. Check the engine accessory drive belts for wear, weather cracking, and damage. Replace as necessary.							○	
13. Visually inspect the unit looking for leaks, wear or damage, loose connections or components, and corrosion. Correct as necessary.	○		○		○		○	
14. Test the engine and transfer switch safety devices. Correct and/or adjust as necessary.							○	

3.9L DIESEL SERVICE RECOMMENDATIONS

Maintenance Tasks	Level 1 Recommended to be done monthly/ 10 hrs.	Task Comp. (Date-Initials)	Level 2 Required to be done 3 months/ Break-in 30 hrs.	Task Comp. (Date-Initials)	Level 3 Required to be done Semi-annually/ 50 hrs.	Task Comp. (Date-Initials)	Level 4 Required to be done Annually/ 100 hrs.	Task Comp. (Date-Initials)
15. Initiate an automatic start and transfer of the unit to site load and exercise it for at least 1 hour looking for leaks, loose connections or components, and abnormal operating conditions. Correct as necessary.								
16. Start and exercise the unit at full rated load (use a load bank if the site load is not enough) for at least 2 hours looking for leaks, loose connections or components, and abnormal operating conditions. Correct as necessary.								
17. Change the engine oil.								
18. Replace the engine oil filter(s).								
19. Replace the engine fuel filter(s) and re-prime the fuel system.								
20. Replace the engine air filter(s).								
21. Perform a 5 minute no-load operational run of the unit looking for any post service problems.								
22. Return the unit to standby setup for operation when required.								

3.9L DIESEL — ENGINE OVERHAUL GASKET KIT

01070

エンジンオーバーホールキットの部品番号は標準エンジン用です。標準と異なる装置が装着されている場合は、構成部品に過不足が生じますので予めご了承ください。

The part number of engine overhaul gasket kit is that of the kit used for the standard engine. Please note that if the engine is provided with equipment other than the standard one, there is a kit component shortage or overage.

ITEM	PART NUMBER	DESCRIPTION	QTY
01070	0D58250105	GASKET KIT, ENG OVERHAUL	1

3.9L DIESEL — SHORT ENGINE ASSEMBLY

01010A

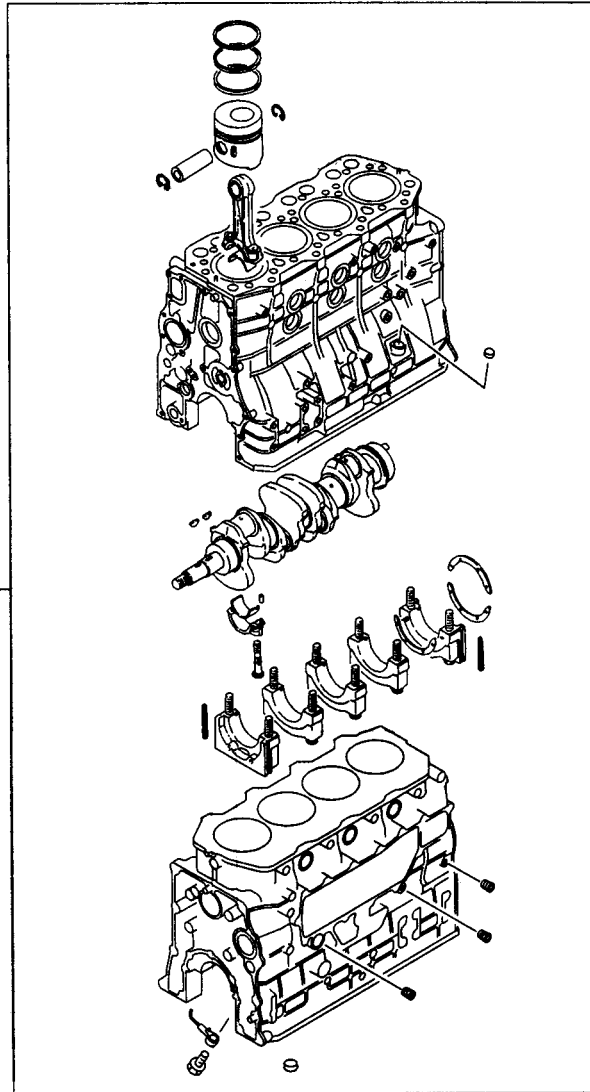

ITEM	PART NUMBER	DESCRIPTION	QTY
01010A	0D58250100	ENGINE ASSY, SHORT	1

3.9L DIESEL — CYLINDER HEAD ASSEMBLY

01200A

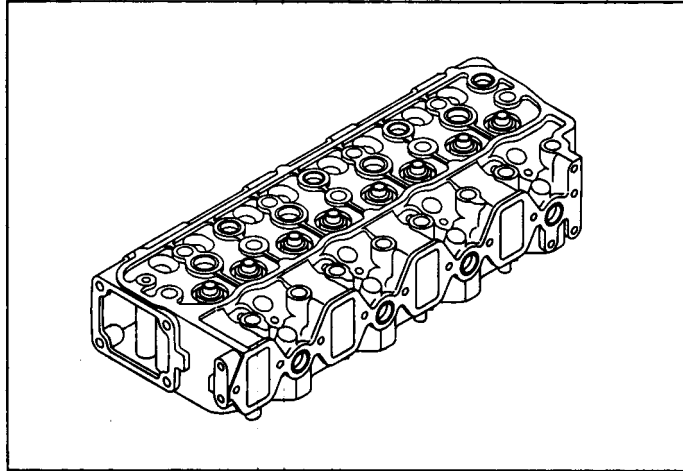

ITEM	PART NUMBER	DESCRIPTION	QTY
01200A	0D58250101	HEAD ASSY, ENG CYLINDER	1

3.9L DIESEL — CYLINDER BLOCK ASSEMBLY

01300A

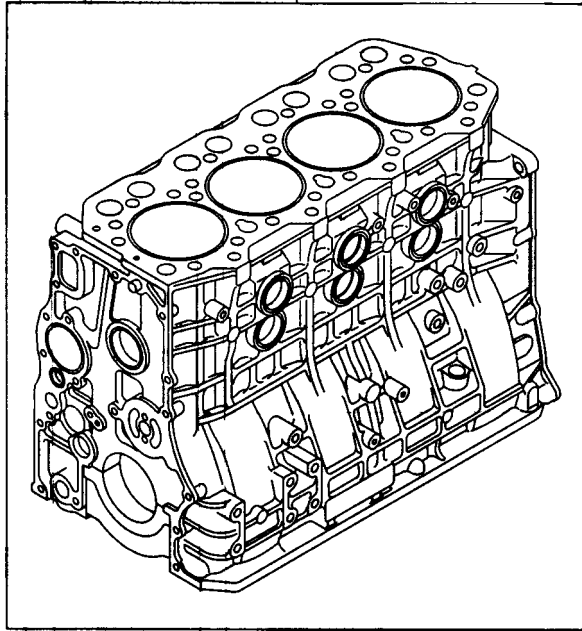

ITEM	PART NUMBER	DESCRIPTION	QTY
01300A	0D58250102	BLOCK ASSY, CYLINDER	1

3.9L DIESEL — LINER AND PISTON KIT

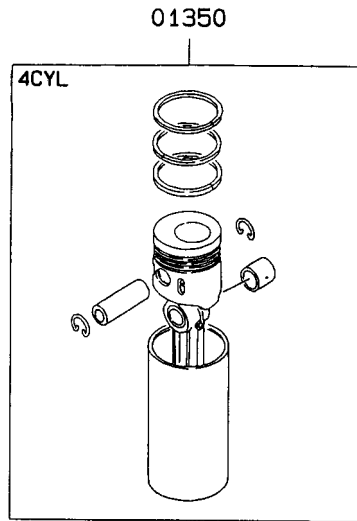

ITEM	PART NUMBER	DESCRIPTION	QTY
01350	0D58250103	SLEEVE & PISTON KIT (FOR ONE ENGINE)	1

3.9L DIESEL — CRANKSHAFT ASSEMBLY

03000A

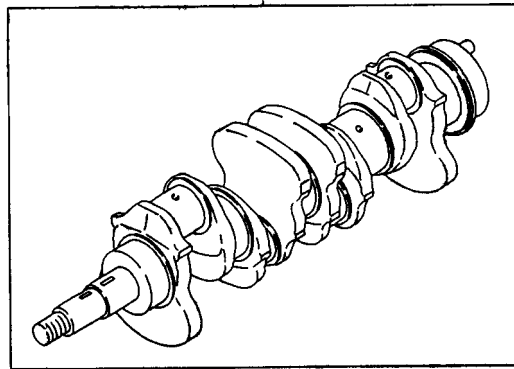

ITEM	PART NUMBER	DESCRIPTION	QTY
03000A	0D58250104	CRANKSHAFT ASSY	1

3.9L DIESEL — ROCKER COVER AND BREATHER

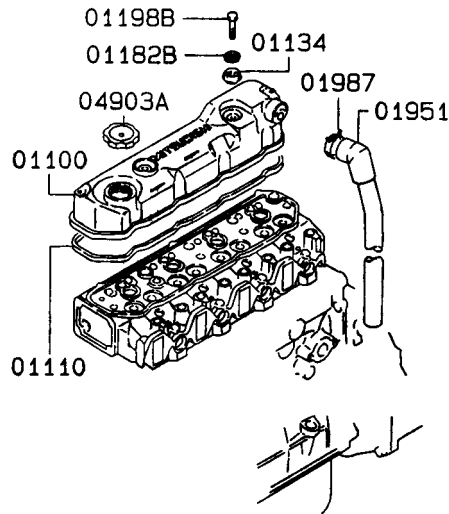

ITEM	PART NUMBER	DESCRIPTION	QTY
01100	0D58250106	COVER, ROCKER	1
01110	0D58250107	GASKET, ROCKER COVER	1
01134	0D57030110	SEAL, RUBBER	2
01182B	0D57030111	WASHER	2
01198B	0D58250108	BOLT	2
01951	0D58250109	HOSE, 31, 4 X 725	1
01987	0D58250110	CLIP, ENG BREATHER	1
04903A	0D57030121	CAP ASY, ENG OIL FILLER	1

3.9L DIESEL — CYLINDER HEAD

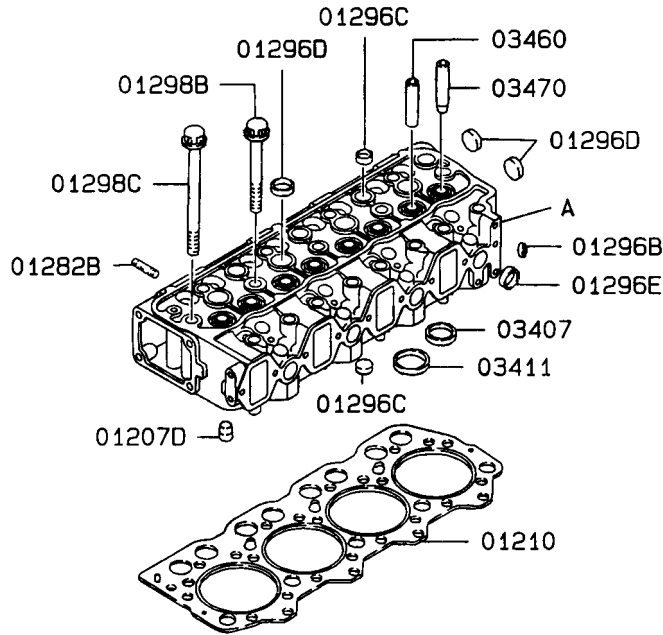

ITEM	PART NUMBER	DESCRIPTION	QTY
01207D	0D58250111	DIRECTOR, CYL HEAD WATER	1
01210	0D58250112	GASKET, CYL HEAD	1
01282B	0D58250113	STUD, 10 X 48	8
01296B	0D58250114	CAP, SEALING, 14	4
01296C	0A53990114	CAP, SEALING, D=22	7
01296D	0D58250115	CAP, SEALING, D=28	6
01296E	0A53990113	CAP, SEALING, 25	4
01298B	0D58250116	BOLT, 14 X 122.5	12
01298C	0D58250117	BOLT, 14 X 180.5	5
03407	0D58250118	SEAT, EXHAUST VALVE	4
03411	0D58250119	SEAT, INLET VALVE	4
03460	0D57030132	GUIDE, INLET VALVE	4
03470	0D57030133	GUIDE, EXHAUST VALVE	4

3.9L DIESEL — CYLINDER BLOCK

1/2

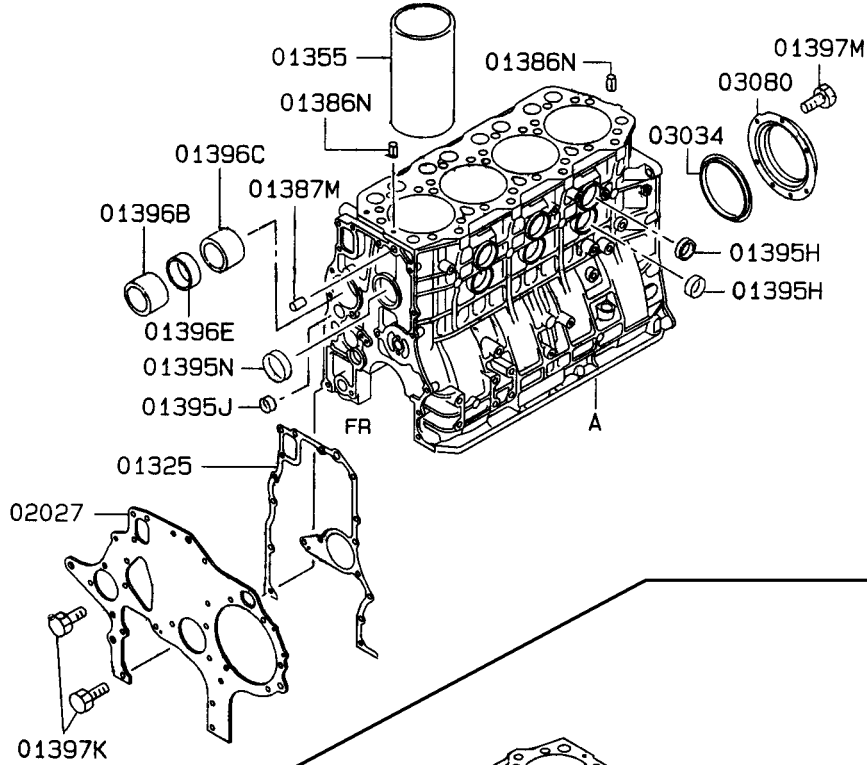

2/2

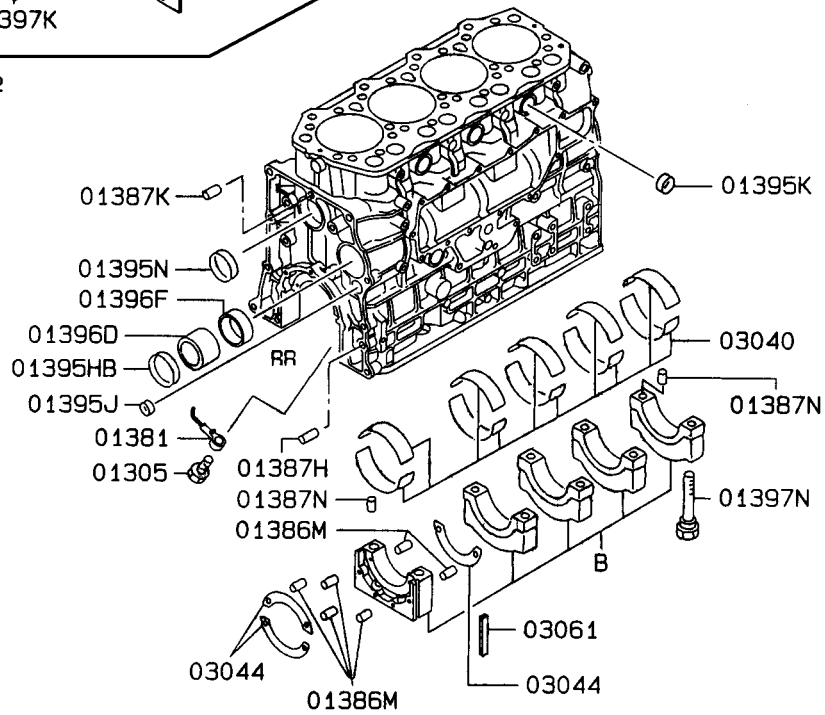

3.9L DIESEL — CYLINDER BLOCK

ITEM	PART NUMBER	DESCRIPTION	QTY
01305	0D58250120	CHECK VALVE	4
01325	0D58250121	GASKET, CYL BLOCK FR PLATE	1
01355	0D58250122	SLEEVE, CYLINDER, STD	4
01381	0D58250123	OIL JET, CYL BLOCK	4
01386M	0D57030143	SPRING PIN, 4X10	6
01386N	0D58250124	SPRING PIN, 6X16	2
01387H	0D57030145	PIN, DOWEL, 12X17	1
01387K	0D57030146	PIN, DOWEL, 12X34	1
01387M	0D58250125	PIN, DOWEL,, 12X24	1
01387N	0D58250126	PIN, DOWEL, 10X16	4
01395H	0D58250127	CAP, SEALING, D=40	6
01395HB	0D58250128	CAP, SEALING, D=57	1
01395J	0A53990114	CAP, SEALING, D=22	2
01395K	0D58250115	CAP, SEALING, D=28	3
01395N	0D58250129	CAP, SEALING, D=50	2
01396B	0D58250130	BUSHING, CYL BLOCK	1
01396C	0D58250131	BUSHING, CYL BLOCK	1
01396D	0D58250132	BUSHING, CYL BLOCK	1
01396E	0D58250133	BUSHING, CYL BLOCK	1
01396F	0D58250134	BUSHING, CYL BLOCK	1
01397K	0D57030175	BOLT, FLANGE, 8X18	5
01397M	0D58250135	BOLT, FLANGE, 6X12	7
01397N	0D58250136	BOLT, 14X101	10
02027	0D58250137	PLATE, CYL BLOCK, FR	1
03034	0D58250138	OIL SLINGER, CRKSHFT, RR	1
03040	0D58250139	BEARING SET, CRKSHFT	1
03044	0D58250140	PLATE, CRKSHFT THRUST	3
03061	0D58250141	SEAL, RUBBER	2
03080	0D58250142	OIL SEAL, CRKSHFT, RR	1

3.9L DIESEL — OIL PAN AND GAUGE

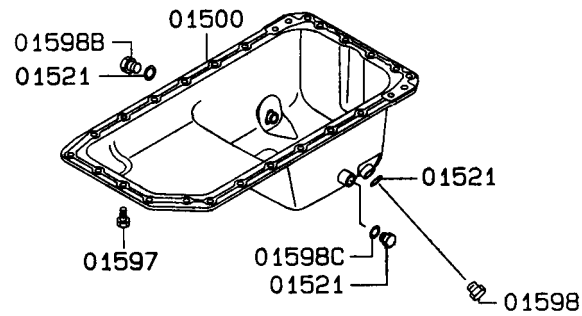
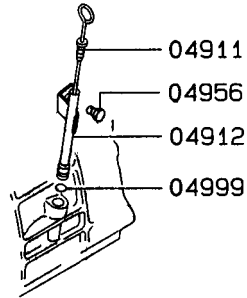

ITEM	PART NUMBER	DESCRIPTION	QTY
01500	0D58250143	OIL PAN, ENG	1
01521	0A53990146	GASKET, ENG OIL PAN DRN PLUG	1
01597	0D57030276	BOLT, FLANGE, 8X12	25
01598	0A53990147	PLUG, SCREW, 18	1
01598B	0D58250144	PLUG, SCREW, 14	1
01598C	0A53990468	PLUG, SCREW, 16	1
04911	0D58250145	GAUGE, ENG OIL LEVEL	1
04912	0D58250146	GUIDE, ENG OIL LEVEL GAUGE	1
04956	0D57030115	BOLT, FLANGE, 10X16	1
04999	0D58250148	O-RING, 11	1

3.9L DIESEL — FLYWHEEL AND HOUSING

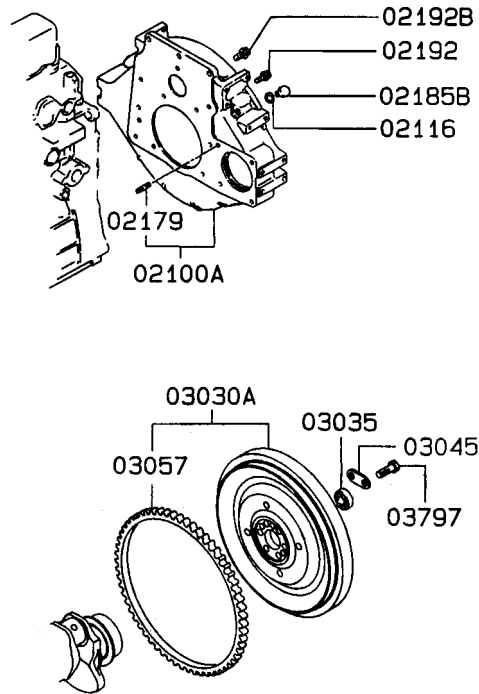

ITEM	PART NUMBER	DESCRIPTION	QTY
02100A	0D58250149	HOUSING ASY, FLYWHEEL	1
02116	0A53990432	GASKET, FLYWHEEL HOUSING	1
02179	0D58250150	STUD, 12X35	1
02185B	0A53990468	PLUG, SCREW, 16	1
02192	0D58250152	BOLT, FLANGE, 10X28	12
02192B	0D58250153	BOLT, FLANGE, 12X30	2
03030A	0D58250154	FLYWHEEL ASY	1
03035	0D58250155	BEARING, FLYWHL DRIVE PINION	1
03045	0D58250156	PLATE, FLYWHEEL BOLT LOCK	3
03057	0D57030198	RING GEAR, FLYWHEEL	1
03797	0D58250157	BOLT, 14X38	6

3.9L DIESEL — PISTON AND CONNECTING ROD

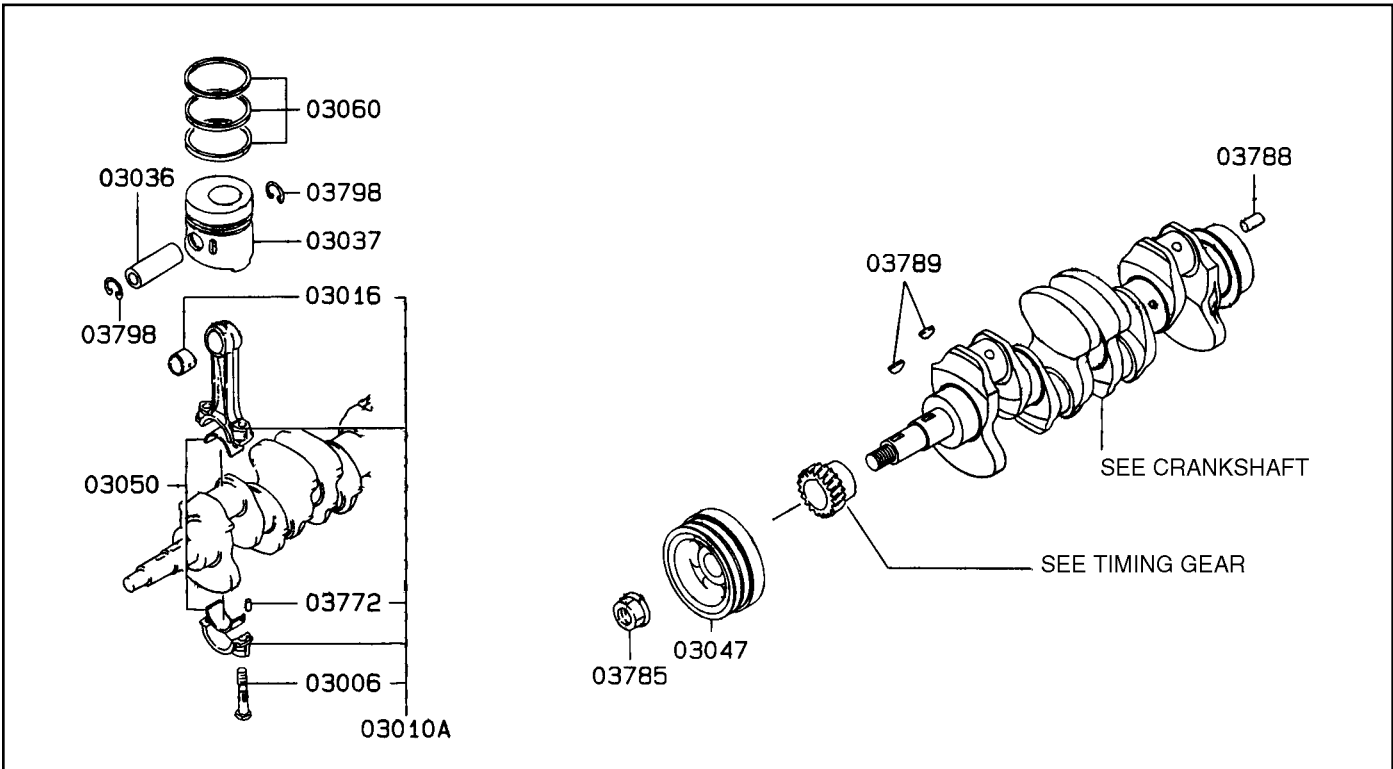

ITEM	PART NUMBER	DESCRIPTION	QTY
03006	0D57030205	BOLT, CONNECTING ROD	8
03010A	0D58250158	CONNECTING ROD ASY	4
03016	0D58250159	BUSHING, CONNECTING ROD	4
03036	0D58250160	PIN, PISTON	4
03037	0D58250161	PISTON, STD	4
03047	0D58250162	PULLEY, CRANKSHAFT	1
03050	0D58250163	BEARING SET, CONNECTING ROD	1
03060	0D58250164	RING SET, PISTON, STD	1
03772	0D57030219	PIN, DOWEL, 4X10	8
03785	0D58250165	NUT, FLANGE, 24	1
03788	0D57030202	PIN, DOWEL, 14X28	1
03789	0D58250166	KEY, WOODRUFF, 7X22	2
03798	0D58250167	SNAP RING, PISTON	8

3.9L DIESEL — CAMSHAFT AND VALVE

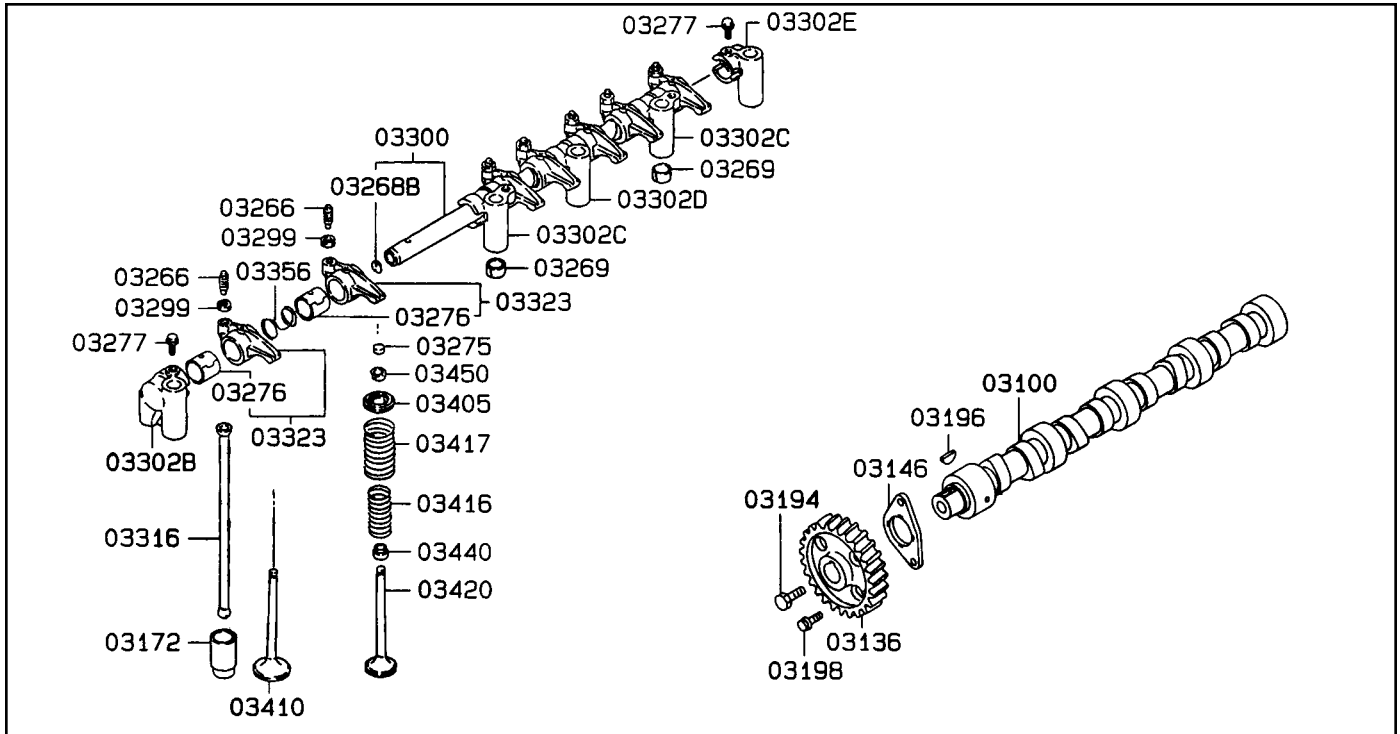

ITEM	PART NUMBER	DESCRIPTION	QTY
03100	0D58250168	CAMSHAFT	1
03136	0D58250169	GEAR, CAMSHAFT	1
03146	0D58250170	PLATE, CAMSHAFT THRUST	1
03172	0D58250171	TAPPET, VALVE	8
03194	0A45310163	PLUG, CAMSHAFT	1
03196	0D58250166	KEY, WOODRUFF, 7X22	1
03198	0D57030175	BOLT, FLANGE, 8X18	2
03266	0D58250172	SCREW, 8X32	8
03268B	0D58250173	PLUG, EXPANSION, 12	2
03269	0D58250174	SPRING PIN, 10X17	2
03275	0D58250175	CAP, VALVE GEAR TRAIN	8
03276	0D58250176	BUSHING, VALVE GEAR TRAIN	8
03277	0D57030114	BOLT, FLANGE, 6X12	2
03299	0D58250177	NUT, JAM, 8	8
03300	0D58250178	SHAFT, ROCKER ARM	1
03302B	0D58250179	BRACKET, ROCKER SHAFT	1
03302C	0D58250180	BRACKET, ROCKER SHAFT	2
03302D	0D58250181	BRACKET, ROCKER SHAFT	1
03302E	0D58250182	BRACKET, ROCKER SHAFT	1
03316	0D58250183	PUSH ROD, ROCKER ARM	8
03323	0D58250184	ROCKER ARM, INLET & EXH VALVE	8
03356	0D58250185	SPRING, ROCKER SHAFT	4
03405	0D57030247	RETAINER, VALVE SPRING	8
03410	0D58250186	VALVE, INLET	4
03416	0D58250187	SPRING, VALVE, INR	8
03417	0D58250188	SPRING, VALVE, OTR	8
03420	0D58250189	VALVE, EXHAUST	4
03440	0D57030252	SEAL, VALVE STEM	8
03450	0D57030253	LOCK, VALVE SPRING RETAINER	16

3.9L DIESEL — TIMING GEAR

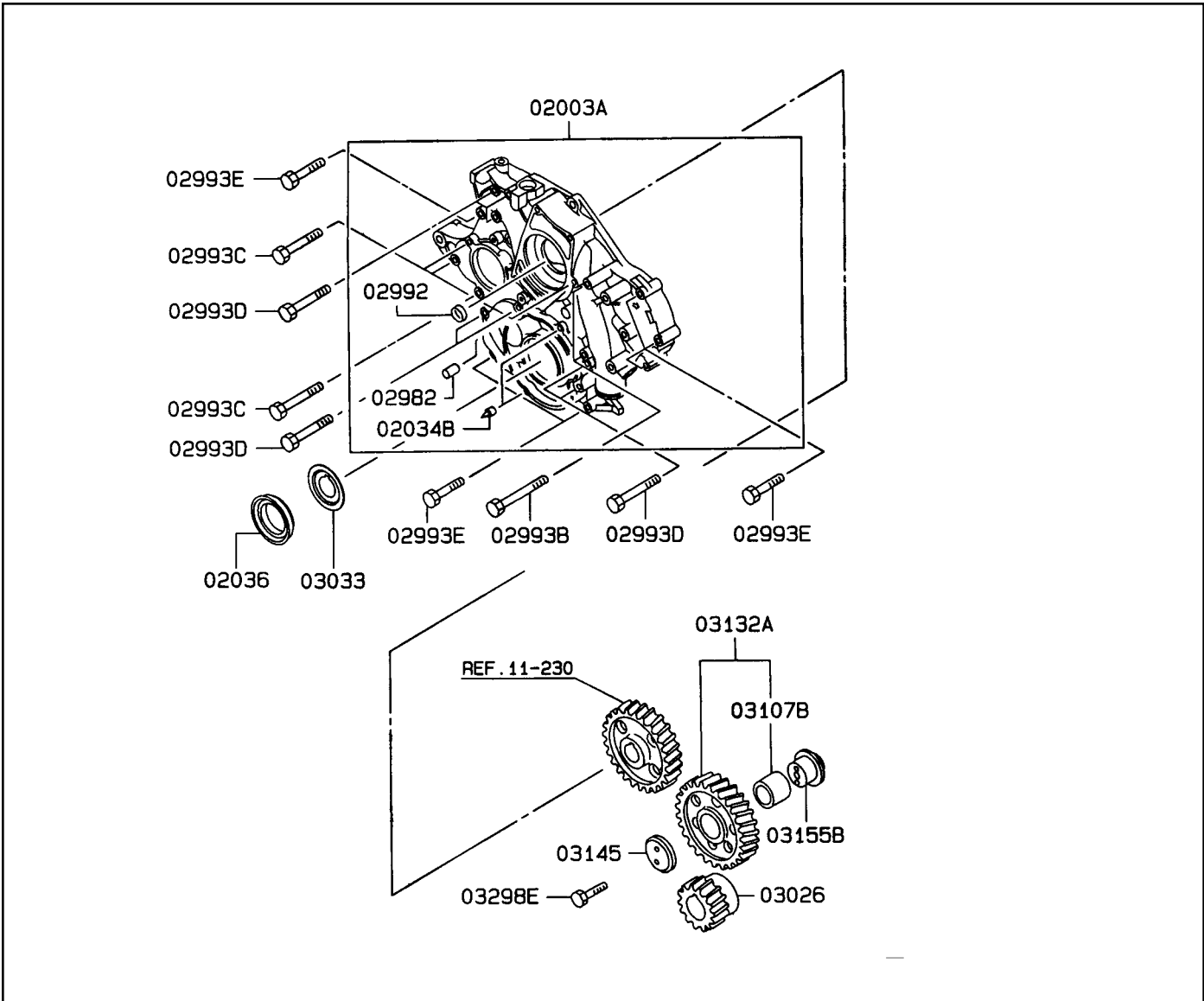

ITEM	PART NUMBER	DESCRIPTION	QTY
02003A	0D58250190	CASE ASY, TIMING GEAR	1
02034B	0D58250191	POINTER, TIMING GEAR CASE	2
02036	0D58250192	OIL SEAL, TIMING GEAR CASE	1
02982	0D58250125	PIN, DOWEL, 12X24	1
02992	0A53990114	CAP, D=22	1
02993B	0D58250193	BOLT, FLANGE, 8X100	2
02993C	0D57030362	BOLT, FLANGE, 8X75	4
02993D	0D57030444	BOLT, FLANGE, 8X80	7
02993E	0D58250194	BOLT, FLANGE, 8X60	6
03026	0D58250195	GEAR, CRANKSHAFT	1
03033	0D58250196	OIL SLINGER, CRKSHFT, FR	1
03107B	0D58250197	BUSHING, TIMING GEAR TRAIN	1
03132A	0D58250198	GEAR ASY, CAM IDLER	1
03145	0D58250199	PLATE, CAM IDLER GEAR THRUST	1
03155B	0D58250200	SHAFT, CAM IDLER GEAR	1
03298E	0D58250201	BOLT, FLANGE, 8X50	2

3.9L DIESEL — ATTACHING PARTS

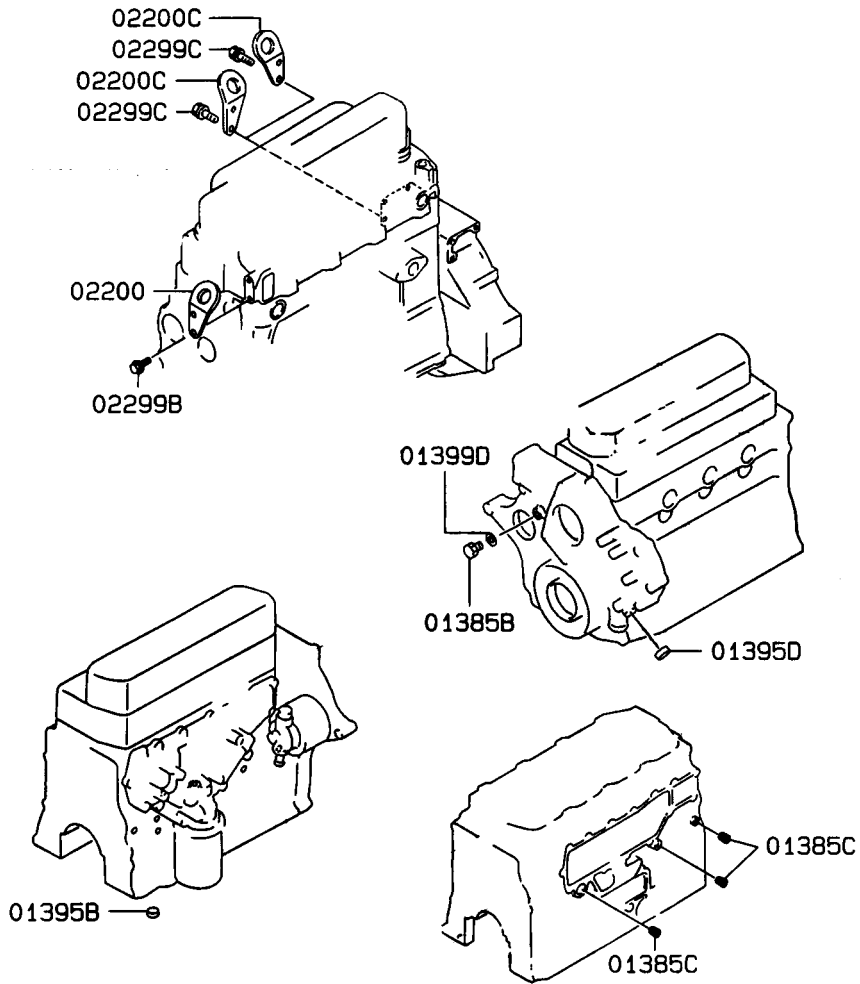

ITEM	PART NUMBER	DESCRIPTION	QTY
01385B	0D58250202	PLUG, SCREW, 16	1
01385C	0D58250203	PLUG, TAPER, 1/8	2
01395B	0D57030154	CAP, SEALING, 30	1
01395D	0D58250204	CAP, SEALING, D=17.2	1
01399D	0A53990432	GASKET, CYLINDER BLOCK	1
02200	0D58250205	ENGINE HANGER	1
02200C	0D58250206	ENGINE HANGER	1
02299B	0D57030228	BOLT, FLANGE, 8X16	2
02299C	0D58250207	BOLT, FLANGE, 10X20	2

3.9L DIESEL — ENGINE MOUNTING & SUPPORT

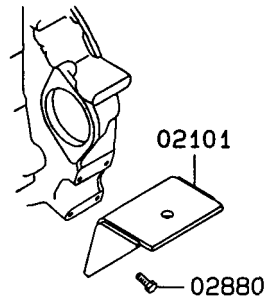
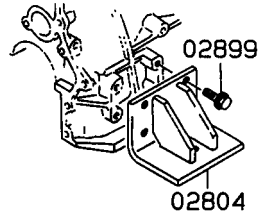

ITEM	PART NUMBER	DESCRIPTION	QTY
02101	0D58250208	BRACKET, FLYWHL HSG ENG MTG	2
02804	0D58250209	BRACKET, CYL BLOCK ENG MTG	2
02880	0D58250207	BOLT, FLANGE, 10X20	8
02899	0D58250207	BOLT, FLANGE, 10X20	8

3.9L DIESEL — OIL PUMP AND STRAINER

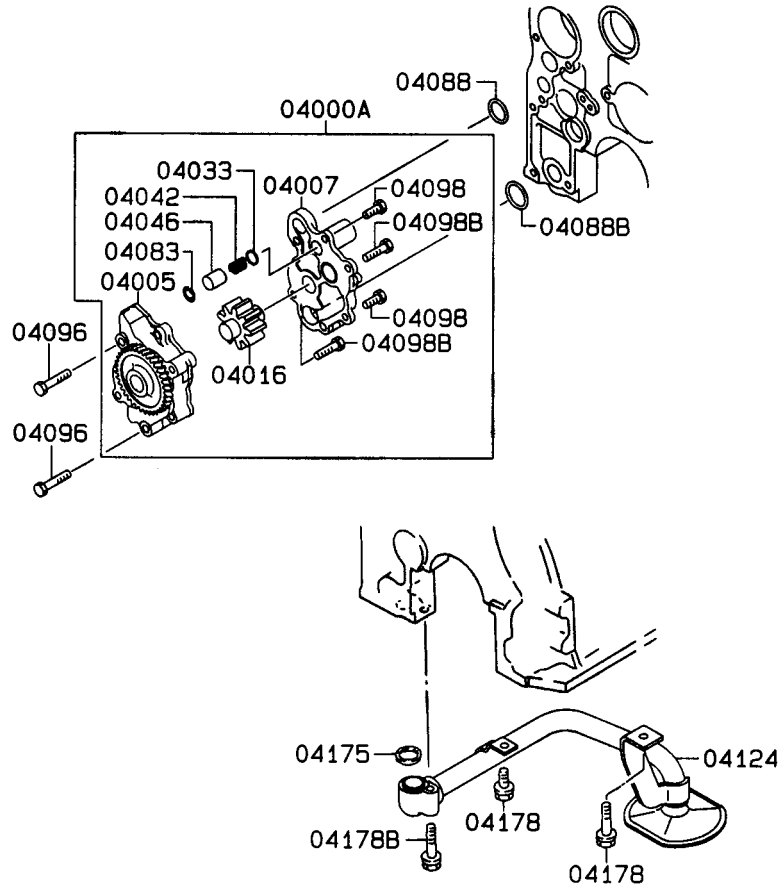

ITEM	PART NUMBER	DESCRIPTION	QTY
04000A	0D58250211	OIL PUMP ASY, ENG	1
04005	0D58250212	GEAR & CASE KIT, ENG OIL PUMP	1
04007	0D58250213	COVER, ENG OIL PUMP	1
04016	0D58250214	GEAR, ENG OIL PUMP DRIVEN	1
04033	0D58250215	SEAT, ENG OIL PUMP RELIEF VALVE	1
04042	0D58250216	SPRING, ENG OIL PUMP RELIEF VALVE	1
04046	0D58250217	VALVE, ENG OIL PUMP RELIEF	1
04083	0D58250218	SNAP RING, ENG OIL PUMP INR	1
04088	0D58250219	O-RING, 26.2	1
04088B	0D58250220	O-RING, 30.2	1
04096	0D58250221	BOLT, FLANGE, 8X55	2
04098	0D58250222	BOLT, 8X20	2
04098B	0D58250223	BOLT, 8X30	2
04124	0D58250224	STRAINER, ENG OIL PAN	1
04175	0D58250219	O-RING, 26.2	1
04178	0D58250226	BOLT, FLANGE, 8X14	2
04178B	0D57030303	BOLT, FLANGE, 8X40	2

3.9L DIESEL — OIL FILTER

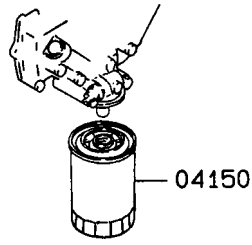

ITEM	PART NUMBER	DESCRIPTION	QTY
04150	0D58250227	OIL FILTER	1

3.9L DIESEL — OIL LINE

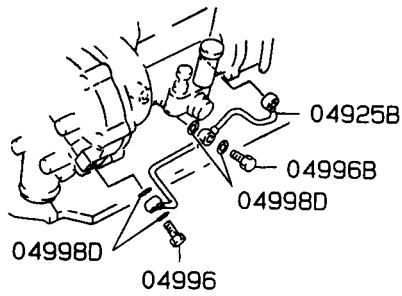

4D34-T

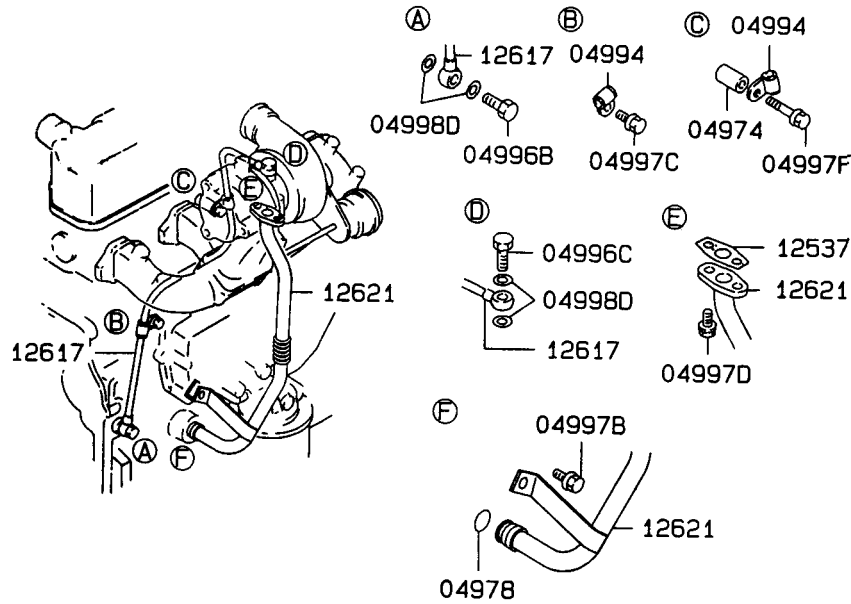

ITEM	PART NUMBER	DESCRIPTION	QTY
04925B	0D58250245	TUBE, ENGINE OIL LINE	1
04974	0D58250246	SPACER, ENG OIL LINE	1
04978	0D58250247	O-RING, ENG OIL LINE	1
04994	0D58250248	CLAMP, ENG OIL LINE	2
04996	0D58250249	EYEBOLT, ENG OIL LINE	1
04996B	0D58250381	EYEBOLT, ENG OIL LINE	2
04996C	0D57030344	EYEBOLT, ENG OIL LINE	1
04997B	0D57030228	BOLT, ENG OIL LINE	1
04997C	0D57030276	BOLT, ENG OIL LINE	1
04997D	0D57030114	BOLT, ENG OIL LINE	2
04997F	0D58250496	BOLT, ENG OIL LINE	1
04998D	0A53990255	GASKET, ENG OIL LINE	8
12537	0D58250497	GASKET, T/C OIL RETURN TUBE	1
12617	0D58250498	TUBE, T/C OIL FEED	1
12621	0D58250499	TUBE, T/C OIL RETURN	1

3.9L DIESEL — FUEL FILTER AND HOSE

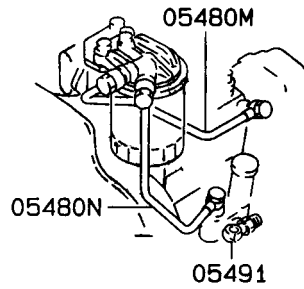
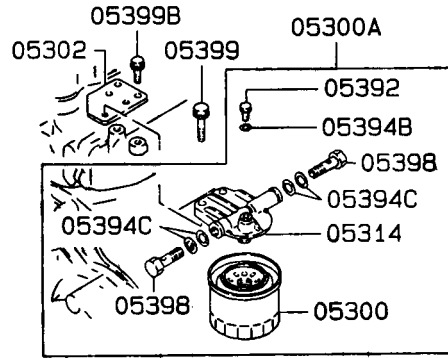

ITEM	PART NUMBER	DESCRIPTION	QTY
05300	0D58250250	FUEL FILTER	1
05300A	0D58250251	FUEL FILTER ASY	1
05302	0D58250252	BRACKET, FUEL FILTER	1
05314	0D58250253	HEAD, FUEL FILTER	1
05392	0D58250254	PLUG, SCREW, 8X9	1
05394B	0A53990247	GASKET	1
05394C	0A53990246	GASKET	4
05398	0A53990248	EYEBOLT, 14X26	2
05399	0D57030360	BOLT, FLANGE, 10X25	2
05399B	0D58250255	BOLT, FLANGE, 10X22	2
05480M	0D58250256	TUBE, FUEL LINE	1
05480N	0D58250257	TUBE, FUEL LINE	1
05491	0D58250258	JOINT, FUEL LINE	1

3.9L DIESEL — FUEL INJECTION PUMP GENERAL

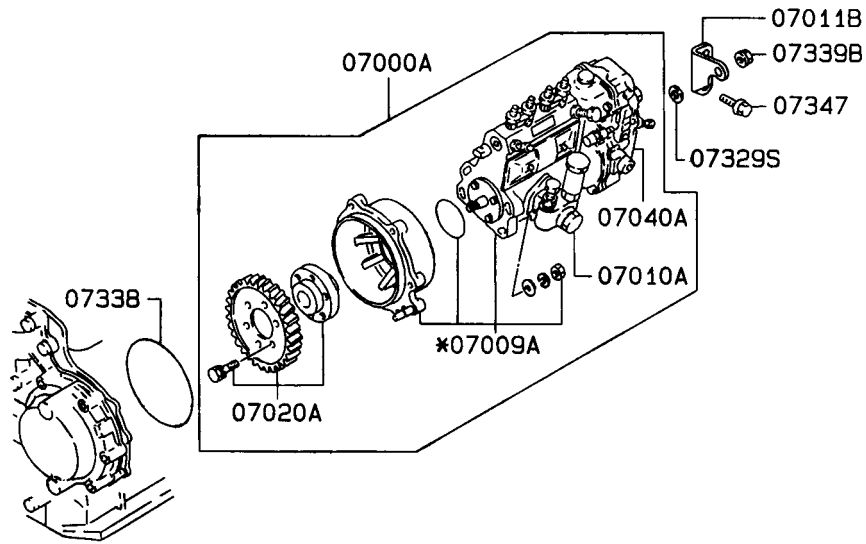

ITEM	PART NUMBER	DESCRIPTION	QTY
03118	0D58250259	GEAR, INJ PUMP DRIVE	1
07000A	0D58250260	PUMP ASY, FUEL INJ	1
07010A	0D58250261	PUMP ASY, INJ PUMP FUEL FEED	1
07011B	0D58250262	BRACKET, INJ PUMP	1
07040A	0D58250266	GOVERNOR ASY, INJ PUMP	1
07329S	0D58250269	WASHER, PLAIN, 10.5	1
07338	0D58250270	O-RING, 75	1
07339B	0D57030326	NUT, FLANGE, 10	1
07347	0D58250207	BOLT, FLANGE, 10X20	2

3.9L DIESEL — FUEL INJECTION PUMP (CONT'D)

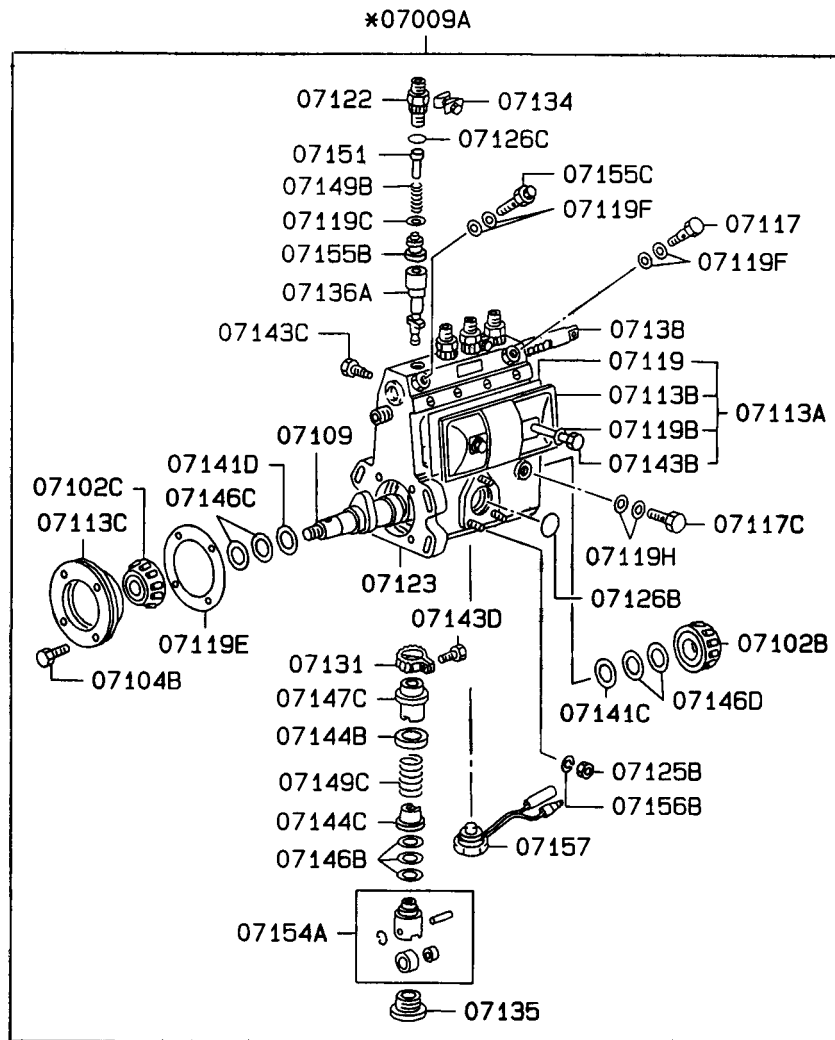

ITEM	PART NUMBER	DESCRIPTION	QTY
07126C	0D58250296	O-RING	4
07131	0D58250297	PINION, INJ PUMP BODY	4
07134	0D58250298	PLATE, INJ PUMP BODY	2
07135	0D58250299	PLUG	3
07136A	0D58250300	PLUNGER ASY, INJ PUMP BODY	4
07138	0D58250301	RACK, INJ PUMP BODY	1
07141C	0D58250302	RING, INJ PUMP BODY	1
07141D	0D58250303	RING, INJ PUMP BODY	1
07143B	0D58250304	SCREW	2
07143C	0D58250305	SCREW	1
07143D	0D58250306	SCREW	4
07144B	0D58250307	SEAT, INJ PUMP BODY	4
07144C	0D58250308	SEAT, INJ PUMP BODY	4

3.9L DIESEL — FUEL INJECTION PUMP (CONT'D)

ITEM	PART NUMBER	DESCRIPTION	QTY
07146B	0D58250309	SHIM, T=0.10	AR
	0D58250310	SHIM, T=0.13	AR
	0D58250311	SHIM, T=0.15	AR
	0D58250312	SHIM, T=0.20	AR
	0D58250313	SHIM, T=0.30	AR
	0D58250314	SHIM, T=0.40	AR
	0D58250315	SHIM, T=0.50	AR
	0D58250316	SHIM, T=0.60	AR
	0D58250317	SHIM, T=0.70	AR
	0D58250318	SHIM, T=0.80	AR
	0D58250319	SHIM, T=0.90	AR
	0D58250320	SHIM, T=1.00	AR
	0D58250321	SHIM, T=1.10	AR
	0D58250322	SHIM, T=1.20	AR
	0D58250323	SHIM, T=1.30	AR
07146C	0D58250324	SHIM, T=1.40	AR
	0D58250325	SHIM, T=0.03	AR
	0D58250326	SHIM, T=0.10	AR
	0D58250327	SHIM, T=0.12	AR
	0D58250328	SHIM, T=0.14	AR
	0D58250329	SHIM, T=0.16	AR
	0D58250330	SHIM, T=0.18	AR
	0D58250331	SHIM, T=0.30	AR
	0D58250332	SHIM, T=0.50	AR
	0D58250333	SHIM, T=1.00	AR
	0D58250334	SHIM, T=1.50	AR
07146D	0D58250335	SHIM, T=0.03	AR
	0D58250336	SHIM, T=0.10	AR
	0D58250337	SHIM, T=0.12	AR
	0D58250338	SHIM, T=0.14	AR
	0D58250339	SHIM, T=0.16	AR
	0D58250340	SHIM, T=0.18	AR
	0D58250341	SHIM, T=0.30	AR
	0D58250342	SHIM, T=0.50	AR
	0D58250343	SHIM, T=1.00	AR
	0D58250344	SHIM, T=1.50	AR
	0D58250345	SHIM, T=2.00	AR
07147C	0D58250346	SLEEVE, INJ PUMP BODY	4
07149B	0D58250347	SPRING, INJ PUMP BODY	4
07149C	0D58250348	SPRING, INJ PUMP BODY	4
07151	0D58250349	STOPPER, INJ PUMP BODY	4
07154A	0D58250350	TAPPET ASY, INJ PUMP BODY	4
07155B	0D58250351	VALVE, INJ PUMP BODY	4
07155C	0D58250352	VALVE, INJ PUMP BODY	1
07156B	0D58250353	WASHER	3
07157	0D58250354	PICKUP, INJ PUMP BODY	1

3.9L DIESEL — INJECTION PUMP GOVERNOR

1/2

07040A

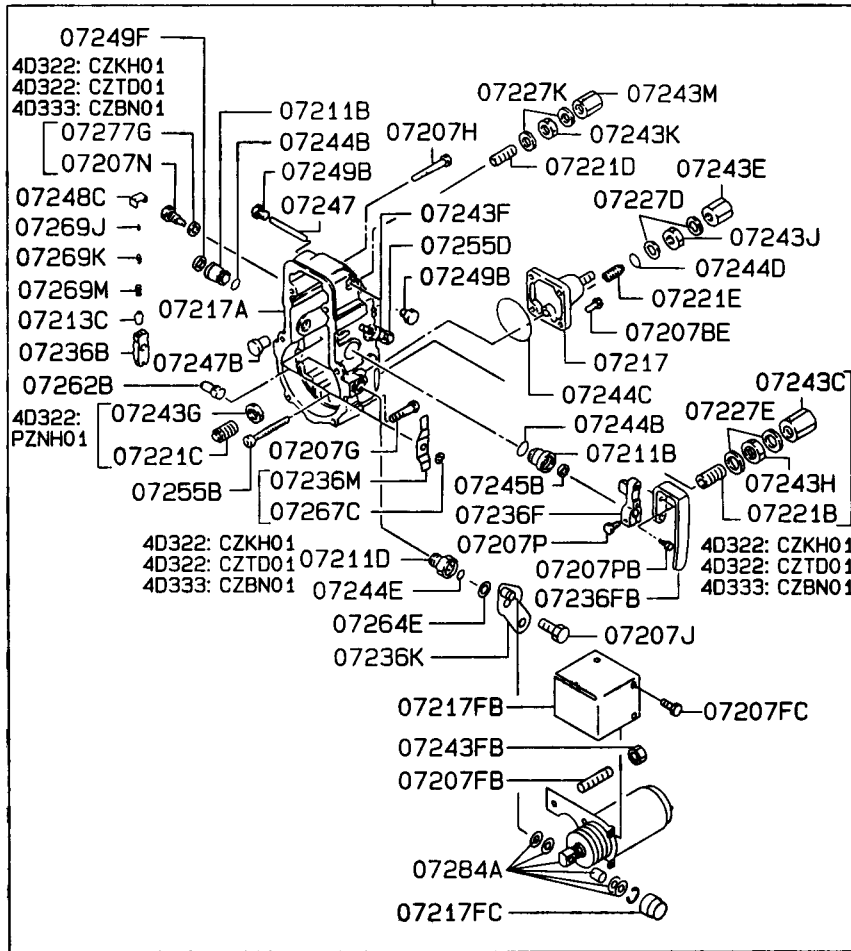

2/2

07040A

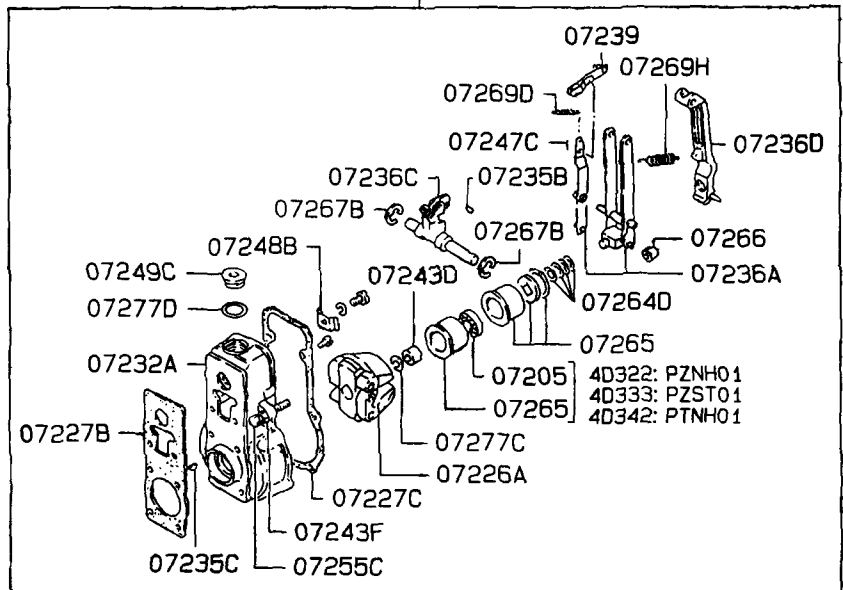

3.9L DIESEL — INJECTION PUMP GOVERNOR

ITEM	PART NUMBER	DESCRIPTION	QTY
07040A	0D58250266	GOVERNOR ASY, INJ PUMP	1
07205	0D58250355	BEARING, INJ PUMP GOVERNOR	1
07207BE	0D58250356	BOLT, WASHER ASY, D, 6X18	1
07207FB	0D58250357	BOLT, 6X29.6	3
07207FC	0D58250358	BOLT, L=8	3
07207G	0D58250359	BOLT, WASHER ASY, D, 6X40	4
07207H	0D58250360	BOLT, WASHER ASY, D, 6X50	2
07207J	0D58250361	BOLT, WASHER ASY, D, 6X12.5	1
07207N	0D58250500	BOLT, INJ PUMP GOV	1
07207P	0D58250362	BOLT, WASHER ASY, D, 6X22	1
07207PB	0D58250273	BOLT, WASHER ASY, D, 6X16	2
07211B	0D58250363	BUSHING, INJ PUMP GOVERNOR	2
07221C	0D58250502	DAMPER, INJ PUMP GOV	1
07211D	0D58250364	BUSHING, INJ PUMP GOVERNOR	1
07213C	0D58250365	CAP, INJ PUMP GOVERNOR	1
07217	0D58250366	COVER, INJ PUMP GOVERNOR	1
07217A	0D58250367	COVER ASY, INJ PUMP GOVERNOR	1
07217FB	0D58250368	COVER, INJ PUMP GOVERNOR	1
07217FC	0D58250369	COVER, INJ PUMP GOVERNOR	1
07221B	0D58250501	DAMPER, INJ PUMP GOV	1
07221D	0D58250370	DAMPER, INJ PUMP GOVERNOR	1
07221E	0D58250371	DAMPER, INJ PUMP GOVERNOR	1
07226A	0D58250372	FLYWEIGHT ASY, INJ PUMP GOVERNOR	1
07227B	0D58250373	GASKET, INJ PUMP GOVERNOR	1
07227C	0D58250374	GASKET, INJ PUMP GOVERNOR	1
07227D	0D58250375	GASKET, INJ PUMP GOVERNOR	2
07227E	0D58250503	GASKET, INJ PUMP GOV	2
07227K	0D58250376	GASKET, INJ PUMP GOVERNOR	2
07232A	0D58250377	HOUSING ASY, INJ PUMP GOVERNOR	1
07235B	0D58250378	KEY, INJ PUMP GOVERNOR	1
07235C	0D58250379	KEY, INJ PUMP GOVERNOR	1
07236A	0D58250380	LEVER ASY, INJ PUMP GOVERNOR	1
07236B	0D58250381	LEVER, INJ PUMP GOVERNOR	1
07236C	0D58250382	LEVER, INJ PUMP GOVERNOR	1
07236D	0D58250383	LEVER, INJ PUMP GOVERNOR	1
07236F	0D58250384	LEVER, INJ PUMP GOVERNOR	1
07236FB	0D58250385	LEVER, INJ PUMP GOVERNOR	1
07236K	0D58250386	LEVER, INJ PUMP GOVERNOR	1
07236M	0D58250504	LEVER, INJ PUMP GOV	1
07239	0D58250387	LEVER, INJ PUMP GOVERNOR	1
07243C	0D58250505	NUT, INJ PUMP GOV	1
07243D	0D58250388	NUT	1
07243E	0D58250389	NUT	1
07243F	0D58250390	NUT	2
07243FB	0D58250391	NUT	3
07243G	0D58250506	NUT, INJ PUMP GOV	1
07243H	0D58250507	NUT, INJ PUMP GOV	1
07243J	0D58250392	NUT	1
07243K	0D58250393	NUT	1
07243M	0D58250394	NUT	1
07244B	0D58250395	O-RING, 15.8	2
07244C	0D58250396	O-RING	1
07244D	0D58250397	O-RING, D=12.3	1

3.9L DIESEL — INJECTION PUMP GOVERNOR (CONT'D)

1/2

07040A

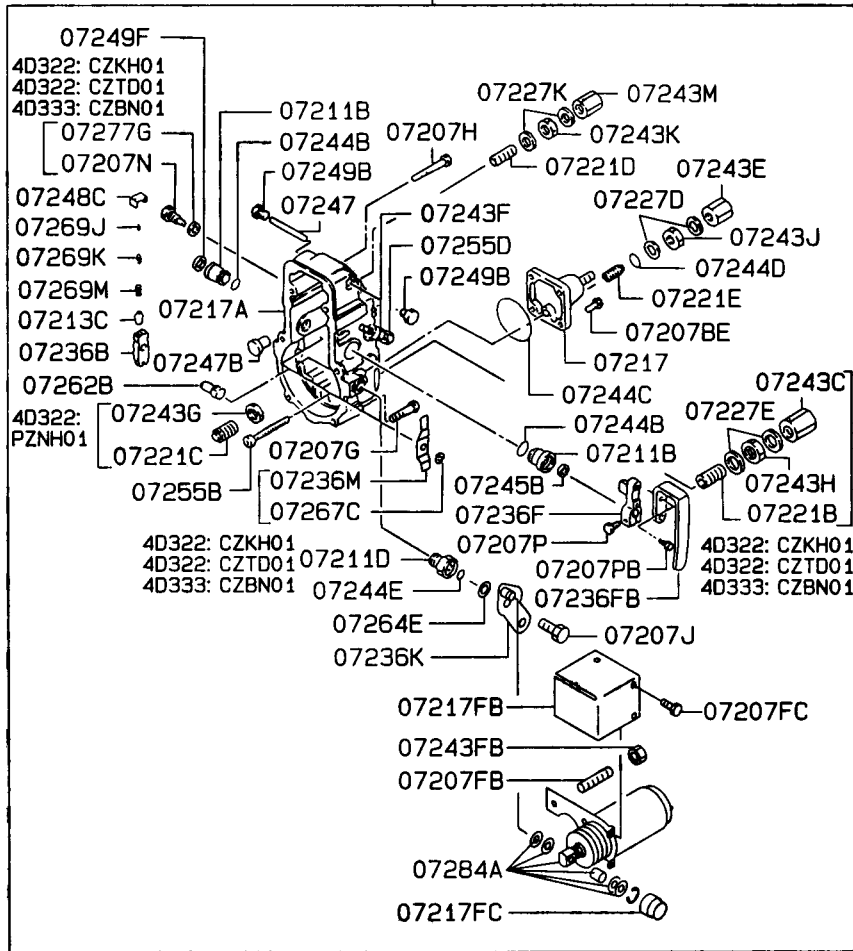

2/2

07040A

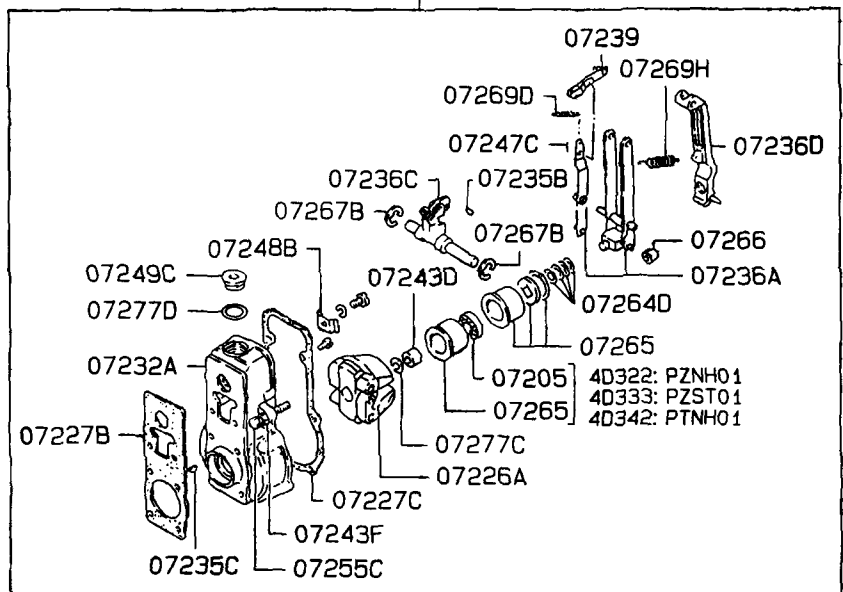

3.9L DIESEL — INJECTION PUMP GOVERNOR (CONT'D)

ITEM	PART NUMBER	DESCRIPTION	QTY
07244E	0D58250398	O-RING, 9	1
07245B	0D58250399	OIL SEAL	1
07247	0D58250400	PIN	1
07247B	0D58250401	PIN	1
07247C	0D58250402	PIN, SPLIT, 2X10	1
07248B	0D58250403	PLATE, INJ PUMP GOVERNOR	1
07248C	0D58250404	PLATE, INJ PUMP GOVERNOR	1
07249B	0D58250405	PLUG	2
07249C	0D58250406	PLUG	1
07249F	0D58250407	PLUG	1
07255B	0D58250408	SCREW	1
07255C	0D58250409	SCREW, 8X57	1
07255D	0D58250409	SCREW, 8X57	1
07262B	0D58250410	SHAFT, INJ PUMP GOVERNOR	1
07264D	0D58250411	SHIM, T=0.10	AR
	0D58250412	SHIM, T=0.20	AR
	0D58250413	SHIM, T=0.30	AR
	0D58250414	SHIM, T=0.40	AR
	0D58250415	SHIM, T=1.00	AR
07264E	0D58250416	SHIM, T=0.4	1
07265	0D58250417	SLEEVE, INJ PUMP GOVERNOR	1
07266	0D58250508	SLIDER, INJ PUMP GOV	1
07267B	0D58250418	SNAP RING, 15	2
07267C	0D58250509	SNAP RING, INJ PUMP GOV	1
07269D	0D58250419	SPRING, INJ PUMP GOVERNOR	1
07269H	0D58250420	SPRING, INJ PUMP GOVERNOR	1
07269J	0D58250421	SPRING, 3.6	1
07269K	0D58250422	SPRING, 6.6	1
07269M	0D58250423	SPRING, 8.6	1
07277C	0D58250424	WASHER, SPRING, T=2.50	1
07277G	0D58250510	WASHER, INJ PUMP GOV	1
07284A	0D58250426	SOLENOID ASY, INJ PUMP GOVERNOR	1

3.9L DIESEL — FUEL FEED PUMP

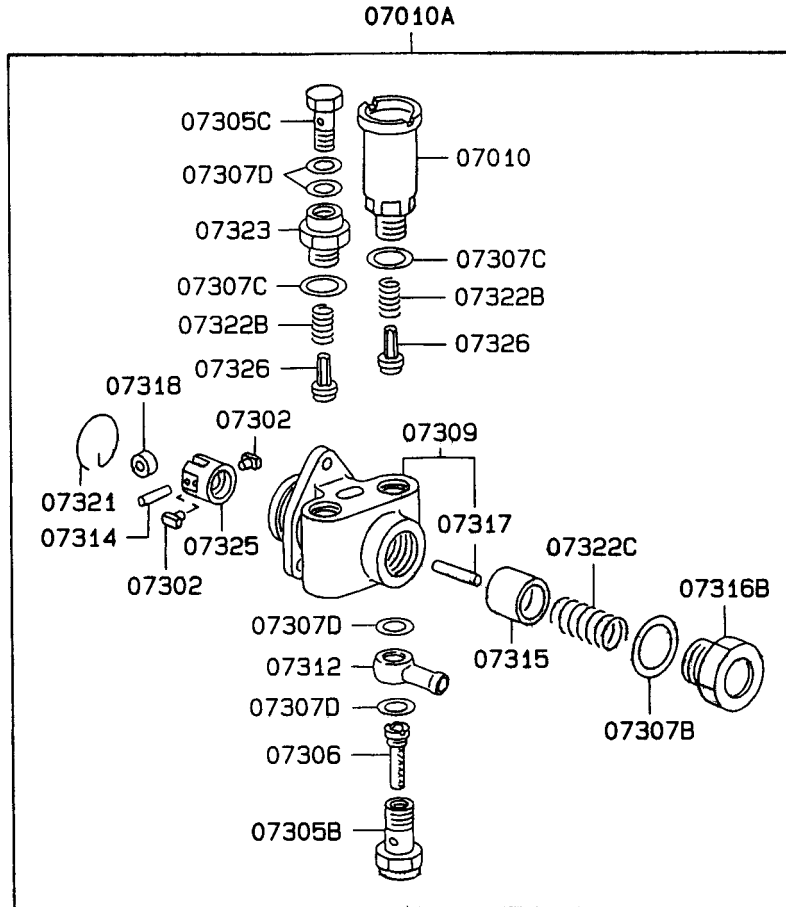

ITEM	PART NUMBER	DESCRIPTION	QTY
07010	0D58250427	PUMP, INJ PUMP FUEL FEED	1
07010A	0D58250261	PUMP ASY, INJ PUMP FUEL FEED	1
07302	0D58250428	BLOCK, INJ PUMP FUEL FEED PUMP	2
07305B	0D58250429	EYEBOLT	1
07305C	0D58250284	EYEBOLT	1
07306	0D58250430	FILTER, INJ PUMP FUEL FEED PUMP	1
07307B	0D58250431	GASKET, T=1.00	1
07307C	0D58250432	GASKET, INJ PUMP FUEL FEED PUMP	2
07307D	0D58250290	GASKET, INJ PUMP FUEL FEED PUMP	4
07309	0D58250433	HOUSING, INJ PUMP FUEL FEED PUMP	1
07312	0D58250434	NIPPLE, INJ PUMP FUEL FEED PUMP	1
07314	0D58250435	PIN	1
07315	0D58250436	PISTON, INJ PUMP FUEL FEED PUMP	1
07316B	0D58250437	PLUG	1
07317	0D58250438	PUSH ROD, INJ PUMP FUEL FEED PUMP	1
07318	0D58250439	ROLLER, INJ PUMP FUEL FEED PUMP	1
07321	0D58250440	SNAP RING	1
07322B	0D58250441	SPRING	2
07322C	0D58250442	SPRING	1
07323	0D58250443	SUPPORT, INJ PUMP FUEL FEED PUMP	1
07325	0D58250444	TAPPET, INJ PUMP FUEL FEED PUMP	1
07326	0D58250445	VALVE, INJ PUMP FUEL FEED PUMP	2

3.9L DIESEL — COUPLING

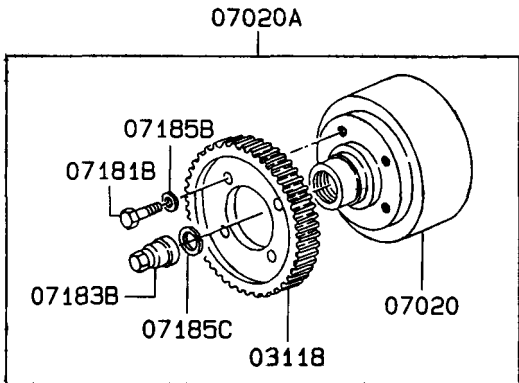

ITEM	PART NUMBER	DESCRIPTION	QTY
03118	0D58250511	GEAR, INJ PUMP DRIVE	1
07020	0D58250512	COUPLING, INJ PUMP	1
07020A	0D58250513	COUPLING ASSY, INJ PUMP	1
07181B	0D58250514	BOLT, INJ PUMP COUPLING	4
07183B	0D58250515	NUT, INJ PUMP COUPLING	1
07185B	0D58250446	WASHER, INJ PUMP COUPLING	1
07185C	0D58250447	WASHER, INJ PUMP COUPLING	1

3.9L DIESEL — INJECTION PIPE & NOZZLE

INJECTION TUBE

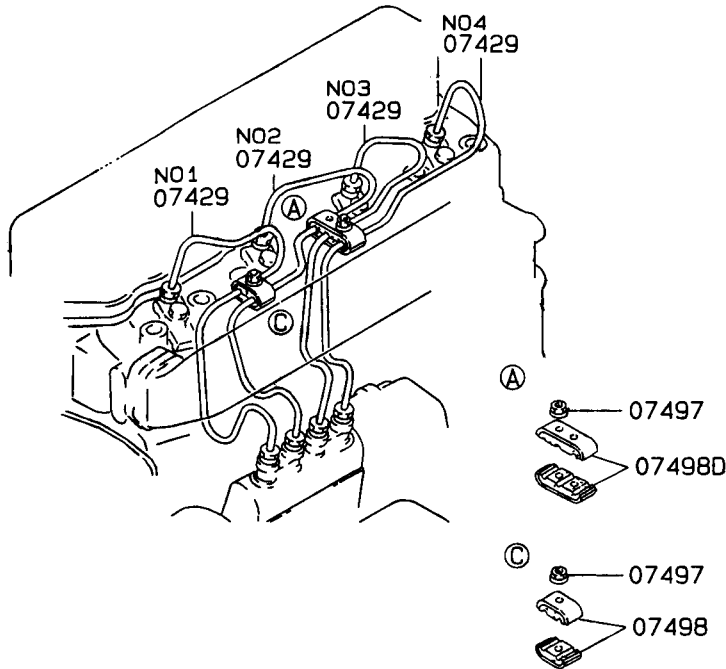

INJECTION NOZZLE

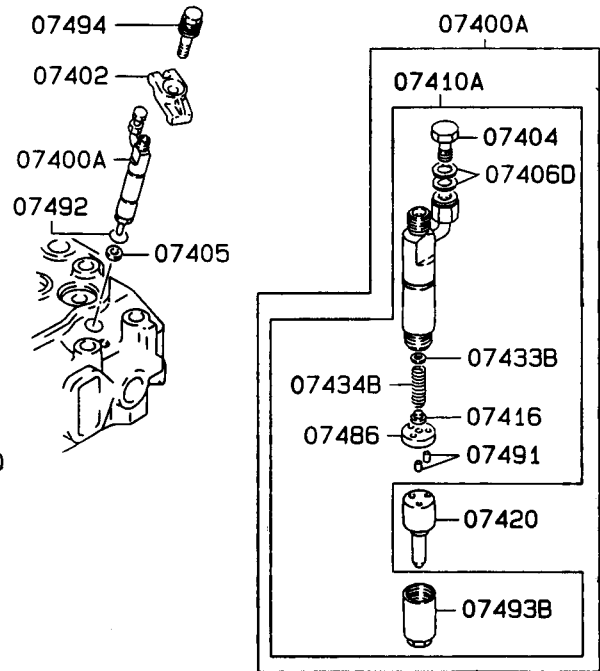

ITEM	PART NUMBER	DESCRIPTION	QTY
07400A	0D58250448	NOZZLE & HOLDER ASY, FUEL, INJ	4
07402	0D58250449	BRIDGE, FUEL INJ NOZZLE	4
07405	0D58250450	GASKET, FUEL, INJ NOZZLE	4
07410A	0D58250451	HOLDER ASY, FUEL INJ NOZZLE	4
07416	0D58250452	SEAT, FUEL INJ NOZZLE HOLDER	4
07420	0D58250453	NOZZLE, FUEL INJECTION	4
07429	0D58250516	TUBE, FUEL INJ NO. 1	1
	0D58250454	TUBE, FUEL INJ, 6.35X1.8X590, NO.2	1
	0D58250455	TUBE, FUEL INJ, 6.35X1.8X590, NO.3	1
	0D58250456	TUBE, FUEL INJ, 6.35X1.8X590, NO.4	1
07433B	0D58250457	SHIM, T=0.100	AR
	0D58250458	SHIM, T=0.200	AR
	0D58250459	SHIM, T=0.300	AR
	0D58250460	SHIM, T=0.400	AR
	0D58250461	SHIM, T=0.500	AR
	0D58250462	SHIM, T=0.520	AR
	0D58250463	SHIM, T=0.540	AR
	0D58250464	SHIM, T=0.560	AR
	0D58250465	SHIM, T=0.580	AR
07434B	0D58250466	SPRING, FUEL INJ NOZZLE HOLDER	4
07486	0D58250467	SPACER, FUEL INJ NOZZLE	4
07491	0D58250468	PIN, FUEL INJ NOZZLE	8
07492	0D58250469	O-RING, D=15	4
07493B	0D58250470	NUT	4
07494	0D58250471	BOLT, WASHER ASY, D, 10X50	4
07497	0D57030363	NUT, FLANGE, 6	2
07498	0D57030407	CLAMP, D=6X2	2
07498D	0D57030409	CLAMP, D=6X3	2

3.9L DIESEL — FUEL RETURN HOSE

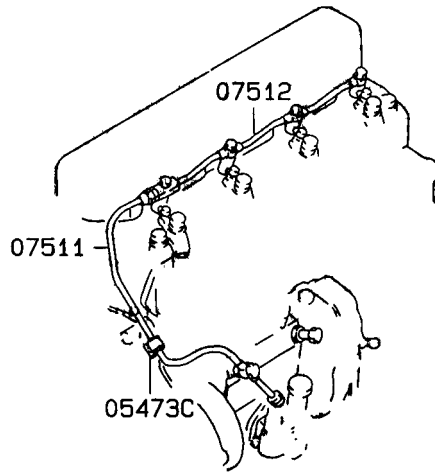

ITEM	PART NUMBER	DESCRIPTION	QTY
05473C	0D58250473	CLIP, D=12	1
07511	0D58250474	TUBE, INJ PUMP FUEL RETURN	1
07512	0D58250475	TUBE, FUEL INJ NOZZLE FUEL RETURN	1

3.9L DIESEL — WATER PUMP AND BELT

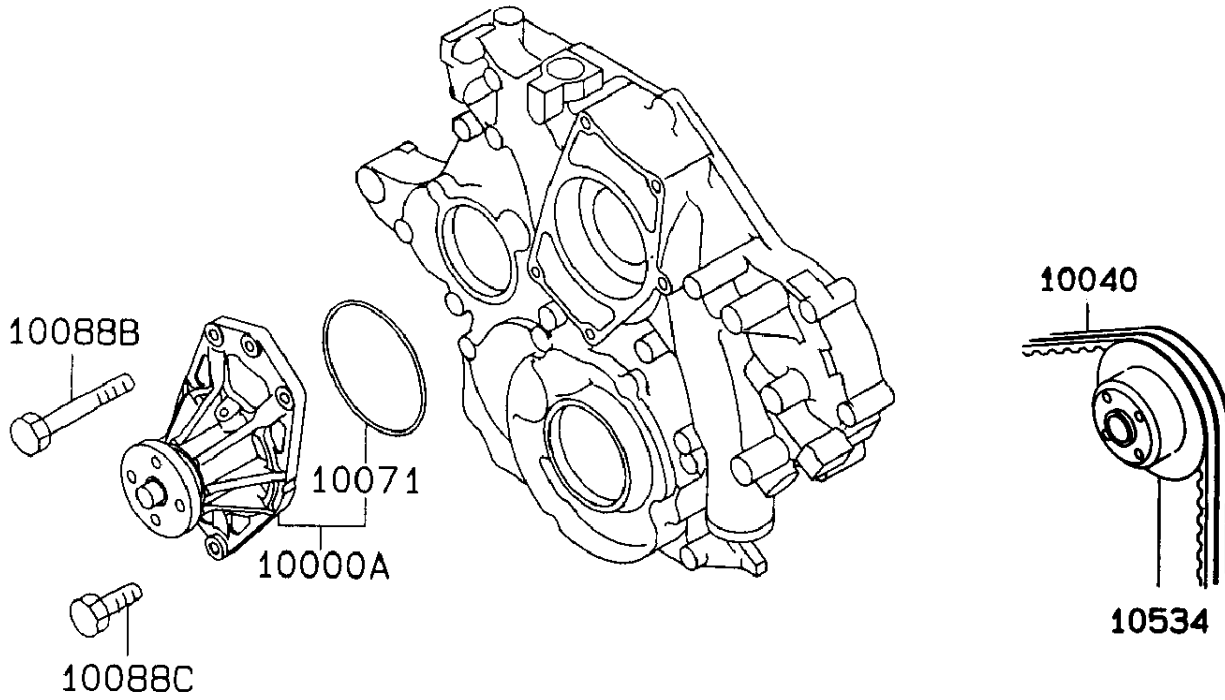

ITEM	PART NUMBER	DESCRIPTION	QTY
10000A	0D58250476	WATER PUMP ASY	1
10040	0D58250477	BELT, ALTERNATOR & OTHERS, 1140X2	1
10071	0D58250478	O-RING, D=100	1
10088B	0D57030302	BOLT, FLANGE, 8X30	2
10088C	0D58250243	BOLT, FLANGE, 8X90	2
10534	0D58250479	PULLEY, COOLING FAN	1

3.9L DIESEL — WATER PIPE AND THERMOSTAT

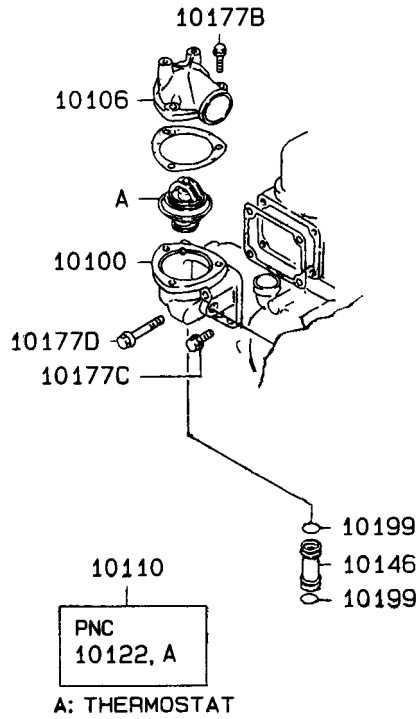

ITEM	PART NUMBER	DESCRIPTION	QTY
10100	0E2423	CASE, THERMOSTAT	1
10106	0D58250480	COVER, THERMOSTAT CASE	1
10110	0D58250481	THERMOSTAT KIT	1
10146	0D58250482	PIPE, THERM WATER BY-PASS	1
10177B	0D57030302	BOLT, FLANGE, 8X30	3
10177C	0A53990179	BOLT, FLANGE, 10X25	2
10177D	0D58250483	BOLT, FLANGE, 10X65	2
10199	0D58250517	O-RING, COOLING WATER LINE	2

3.9L DIESEL — MANIFOLDS & TURBOCHARGER

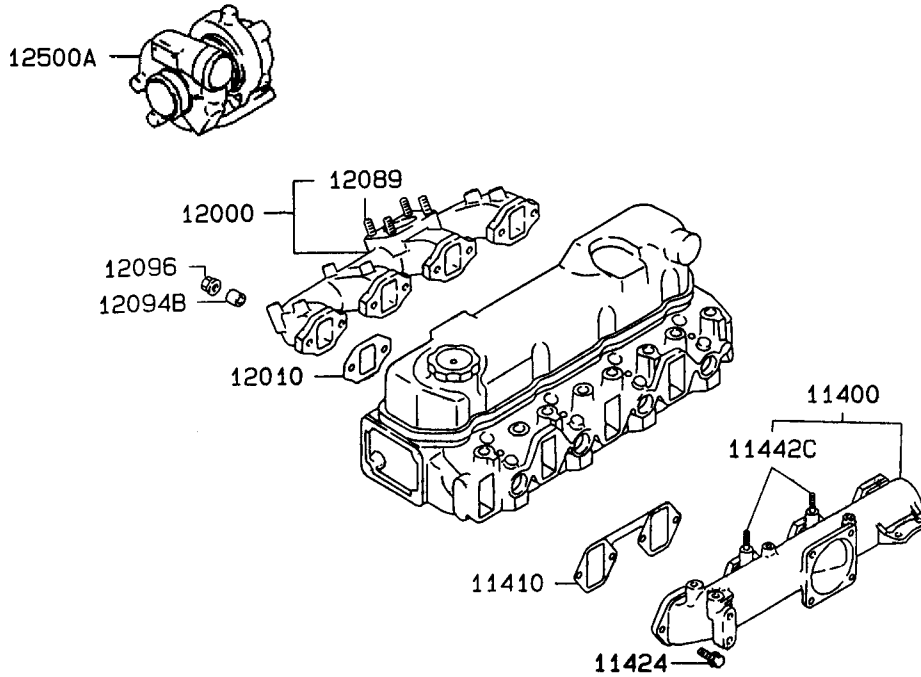

ITEM	PART NUMBER	DESCRIPTION	QTY
11400	0D58250484	MANIFOLD, INLET	1
11410	0D58250485	GASKET, INLET MANIFOLD	2
11424	0D58250486	BOLT, FLANGE, 8X20	8
11442C	0D58250487	STUD, 6X32	2
12000	0D58250488	MANIFOLD, EXHAUST	1
12010	0D58250489	GASKET, EXHAUST MANIFOLD	4
12089	0D57030449	STUD, 10X25	4
12094B	0D58250490	SPACER, T=21	8
12096	0D57030450	NUT, SELF LOCKING, FLANGE, 10	8
12500A	0D58250491	TURBO CHARGER ASY	1

3.9L DIESEL — STARTER, GLOW PLUGS & ALTERNATOR

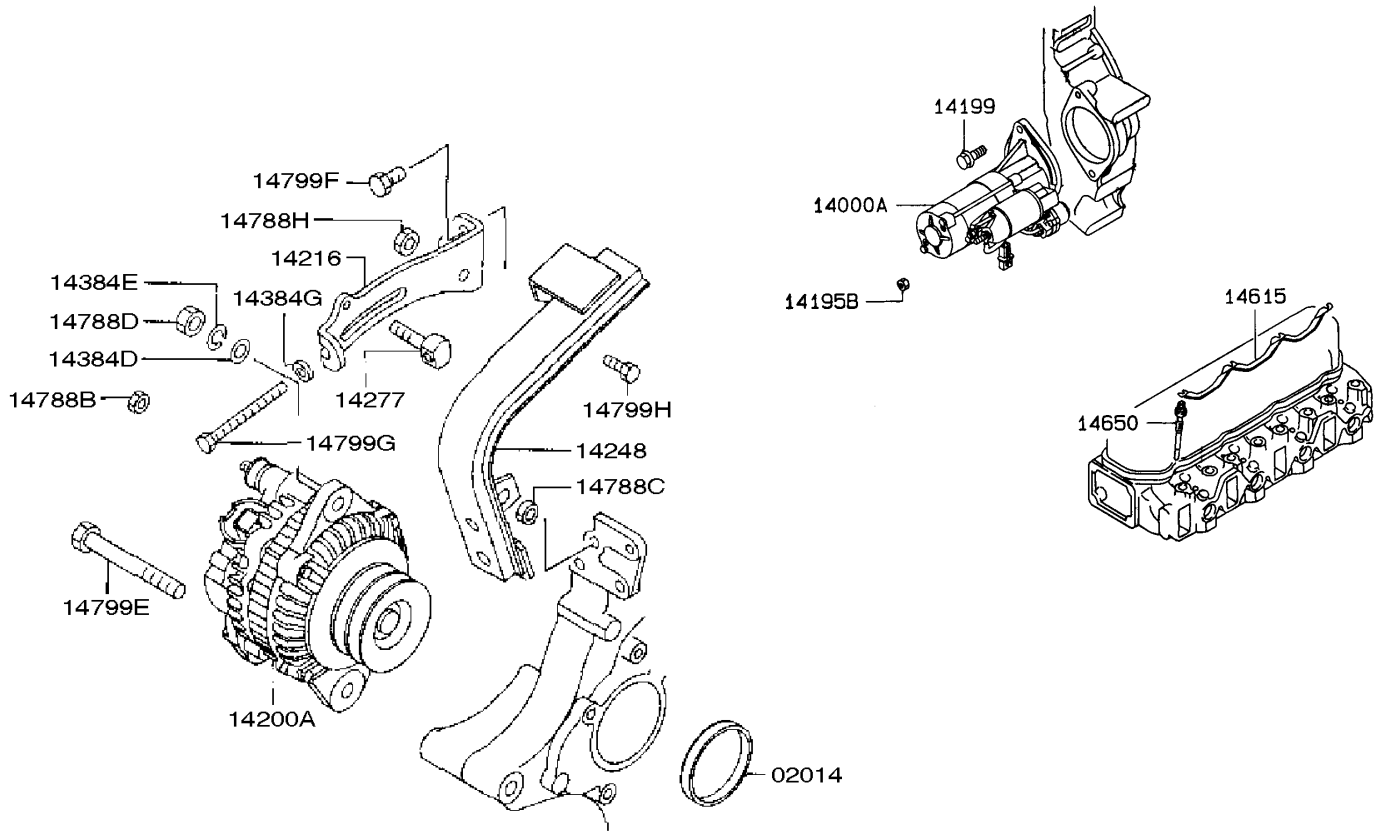

ITEM	PART NUMBER	DESCRIPTION	QTY
14000A	0D58250492	STARTER ASY	1
14195B	0D58250518	NUT, STARTER	1
14199	0D58250153	BOLT, STARTER	2
14615	0D58250519	PLATE, GLOW PLUG CONNECTING	1
14650	0D58250495	GLOW PLUG	4
14200A	0D58250494	ALTERNATOR ASSY	1
02014	0D58250493	COVER	1
14216	0D58250520	BRACE, ALT ADJUSTING	1
14248	0D58250521	COVER, ALT PULLEY	1
14277	0D58250522	SHAFT, ALT ADJUSTING	1
14384D	0D58250523	WASHER, ALT	1
14384E	0D57030184	WASHER, ALT	1
14384G	0D58250525	WASHER, ALT	1
14788B	0D57030472	NUT, ALT	1
14788C	0D57030466	NUT, ALT	1
14788D	0A53990186	NUT, ALT	1
14788H	0D57030326	NUT, ALT	1
14799E	0D57030474	BOLT, ALT	1
14799F	0D58250207	BOLT, ALT	2
14799G	0D58250524	BOLT, ALT	1
14799H	0D57030360	BOLT, ALT	1

3.9L DIESEL — ENGINE COMMON PARTS

ITEM	PART NUMBER	DESCRIPTION	QTY
1	0D5825	ENGINE 3.9L MITSUBISHI	1
2	0E1142	ADAPTER FLYWHEEL HSG. MACHINED	1
3	0A8240	FLEX PLATE SAE10	2
4	098184	FAN COOLING 26"	1
5	0D9220	SPACER FAN 3.9L 100K	1
6	0E2911	ARM THROTTLE CONTROL	1
7	049721	SCREW HHC M6-1.0 X 35 G8.8 BLK	1
8	022097	WASHER LOCK M6-1/4	4
9	049811	WASHER FLAT M6	1
10	097474	BANJO ASSY M14-1.5	1
11	0E3171	ADAPTER FUEL RETURN FITTING	1
12	055596	BARBED STR 3/8 NPT X 3/8	1
13	0D2244M	ASSY MAGPICKUP (3/8-24 MALE) (ELECTRONIC GOVERNOR)	2
		ASSY MAGPICKUP (3/8-24 MALE) (STANDARD GOVERNOR)	1
14	0E3101	ADAPTER MAG PICK UP	1
15	044117	BARBED STR 3/8 NPT X 5/8	2
16	065317	FITTING OIL DRAIN M18-1.5	1
17	0D4739	WASHER FLAT M18 COPPER 1.5THK	1
18	053666	SENDER OIL PRESSURE	1
19	029612	COUPLING FULL 1/8-27	1
20	035483	NIPPLE PIPE 1/8 NPT X 1-1/2	1
21	042574	ADAPTOR 1/8 NPTF TO 1/8-28	1
22	035430	PIPE TEE 1/8 NPT	1
23	0A8584	SWITCH OIL PRESSURE HOBBS	1
24	046526	WASHER LOCK M10	34
25	048527	SCREW SHC 3/8-16 X 3/4 G8.8 NZ	8
26	071623	SCREW SHC M10-1.5 X 55 G12.9	12
27	064416	SCREW HHC M10-1.5 X 45 G8.8	12
28	022131	WASHER FLAT 3/8-M10 ZINC	14
29	043107	SCREW HHC M8-1.25 X 25 G8.8	4
30	022129	WASHER LOCK M8-5/16	8
31	022145	WASHER FLAT 5/16-M8 ZINC	4
32	046579	SCREW SHC M8-1.25 X 60 G12.9	4
33	0E2463	GASKET THERMOSTAT CASE	1
34	0E2464	GASKET THERMOSTAT COVER	1
35	053667	SENDER WATER TEMP	1
36	0D9380	ADAPTER 1/8 NPT TO M16-1.5	1
37	0A6751	SW-TMP 245 DEG 3/8 NPT	1
38	0E3093	SOLENOID ASSY 24V SEALED CONN	1
39	082507	STGHT TYP SWVL .25-28	1
40	0E2907	BRACKET MOUNTING SHUT-DN SOLND	1
41	049954	BALL JOINT 1/4-28 R/H	1
42	047411	SCREW HHC M6-1.0 X 16 G8.8	2
43	022473	WASHER FLAT 1/4-M6 ZINC	2
44	036409	NUT HEX 1/4-28 STEEL	2
45	049813	NUT HEX M6 X 1.0 G8 YEL CHR	2
46	051756	SCREW HHC M10-1.5 X 20 G8.8	2
47	0E2423	THERMOSTAT HSG REWORKED 3.9L	1

3.9L DIESEL — RADIATOR

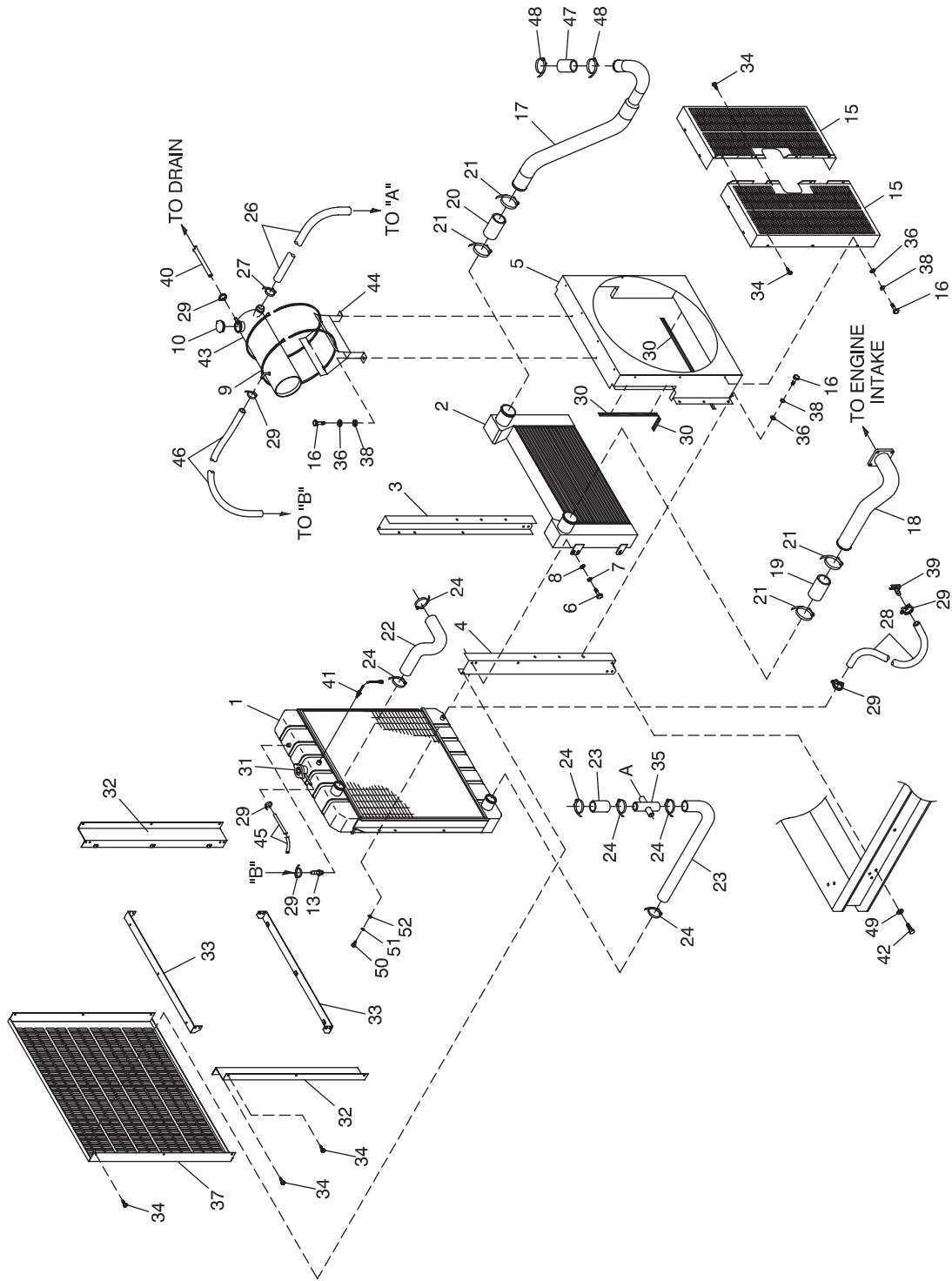

3.9L DIESEL — RADIATOR

ITEM	PART NUMBER	DESCRIPTION	QTY
1	0E1411B	RADIATOR W703 X H749 L-IN L-OUT	1
2	0A5160	ASSEMBLY CAC 19 CORE	1
3	0D9040A	RADIATOR SUPPORT RH 3.9L	1
4	0D9040	RADIATOR SUPPORT LH	1
5	0D9041	VENTURI FAN 3.9 100KW	1
6	049814	SCREW HHC M10-1.5 X 25 G8.8	6
7	046526	WASHER LOCK M10	6
8	022131	WASHER FLAT 3/8-M10 ZINC	6
9	086133G	CLAMP HI TORQUE 3.75 - 4.625	2
10	090283	CAP RADIATOR 13 PSI	1
11	059981	SCREW HHC M10-1.5 X 30 G10.9	8
12	045772	NUT HEX M10-1.5 G8 YEL CHR	6
13	035461	BARBED STR 1/4 NPT X 3/8	1
14	0D7872	LEVEL ONE GUARDING LH SIDE	1
15	0D9443	GUARD FAN 3.9L 100KW	2
16	045757	SCREW HHC M6-1.0 X 25 G8.8	20
17	0E2025	AIR TUBE CAC TO TURBO	1
18	0D9817	TUBE AIR INTAKE 3.9L 100KW	1
19	0A5260A	HOSE 3" ID X 3.0" LG	1
20	080773B	HOSE RES 3" TURBO	1
21	086133E	CLAMP HI TORQUE 2.75 - 3.625	6
22	0E2544	HOSE RADIATOR INLET 3.9L	1
23	0E2545	HOSE RADIATOR OUTLET 3.9L	1
24	086133D	CLAMP HI TORQUE 2.25 - 3.125	6
25	0D8518	RADIATOR HOSE TEE CONNECTOR	1
26	035587	HOSE 1IN ID CVR NEOP SAE-20R3 (48" LG)	1
27	057824	CLAMP HOSE #16 .87 - 1.50	2
28	047290	HOSE 3/8 ID SINGLE BRAID (28" LG)	1
29	040173	CLAMP HOSE #5.5 .62 - .62	5
30	052250	TAPE FOAM 1 X 1 (276" LG)	1
31	046627	CAP RADIATOR	1
32 *	0E2671	RH/LH SIDE AIR DUCT 3.9L MITSU	2
33 *	0E2673	TOP/BOTTOM AIR DUCT 3.9L MITSU	2
34 *	0A2110	SCREW SWAGE 1/4-20 X 1/2 Z/YC	14
35 *	080723B	HOSE TEE DUAL NIPPLE 5/8" & 1"	1
36	049811	WASHER FLAT M6	20
37 **	0E2674	STONE GUARD FRONT 3.9L MITSU	1
38	022097	WASHER LOCK M6-1/4	20
39	036865	DRAINCOCK	1
40	047290	HOSE 3/8 ID SINGLE BRAID (48" LG)	1
41	0E0561	ASSEMBLY WATER LEVEL SENSOR	1
42	051768	SCREW HHC M12-1.75 X 25 G8.8	6
43	0A2770	TANK SURGE	1
44	0E1972	SUPPORT SURGE TANK 4.8L	1
45	047290	HOSE 3/8 ID SINGLE BRAID (48" LG)	1
46	047290	HOSE 3/8 ID SINGLE BRAID (12" LG)	1
47	071296B	HOSE 2" ID X 4.0" LG	1
48	086133C	CLAMP HI TORQUE 1.75 - 2.625	2
49	051769	WASHER LOCK M12	6
50	059980	SCREW HHC M10-1.5 X 25 G10.9	3
51	046526	WASHER LOCK M10	3
52	022131	WASHER FLAT 3/8-M10 ZINC	3

* OPTIONAL AIR DUCT KIT (0E2676) PARTS.

** OPTIONAL STONE GUARD (0E2489) PARTS.

3.9L DIESEL — EXHAUST

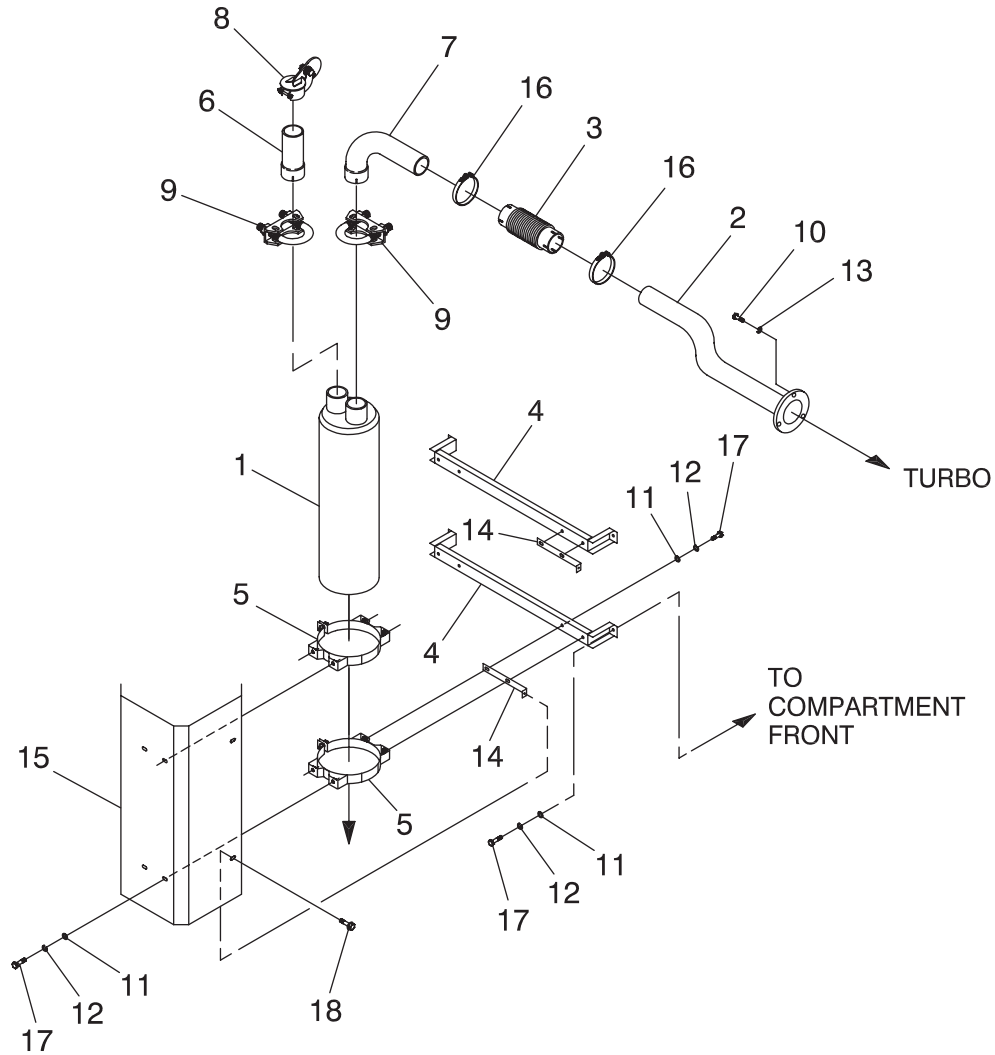

ITEM	PART NUMBER	DESCRIPTION	QTY
1	0C9652	MUFFLER 3 DIA INLET & OUTLET	1
2	0E3170	EXHAUST PIPE 3.9L ENCLOSED	1
3	0A5215C	PIPE FLEX 3"	1
4	0C2933	BRACKET MOUNTING	2
5	0C4114	CLAMP MUFFLER BAND	2
6	0C9640	TUBE STRAIGHT 3 DIA	1
7	0C9645	TUBE ELBOW 3 DIA (90 DEG)	1
8	059902	CAP RAIN 3.00 / 3.19	1
9	055978	BOLT U 3/8-16 X 3.25	2
10	053495	SCREW SHC M10-1.25 X 25 G12.9	3
11	022145	WASHER FLAT 5/16 ZINC	18
12	022129	WASHER LOCK M8-5/16	12
13	022237	WASHER LOCK 3/8	3
14	0C4170	BRACKET EXHAUST SHIELD	2
15	0C3094	HEAT SHIELD GEN 2	1
16	0C3433B	CLAMP BAND 3 DIA	2
17	042907	SCREW HHC M8-1.25 X 16 G8.8	12
18	0C2454	SCREW TH-FRM M6-1 X 16 N WA Z/JS	2

3.9L DIESEL — WATER SEPARATOR

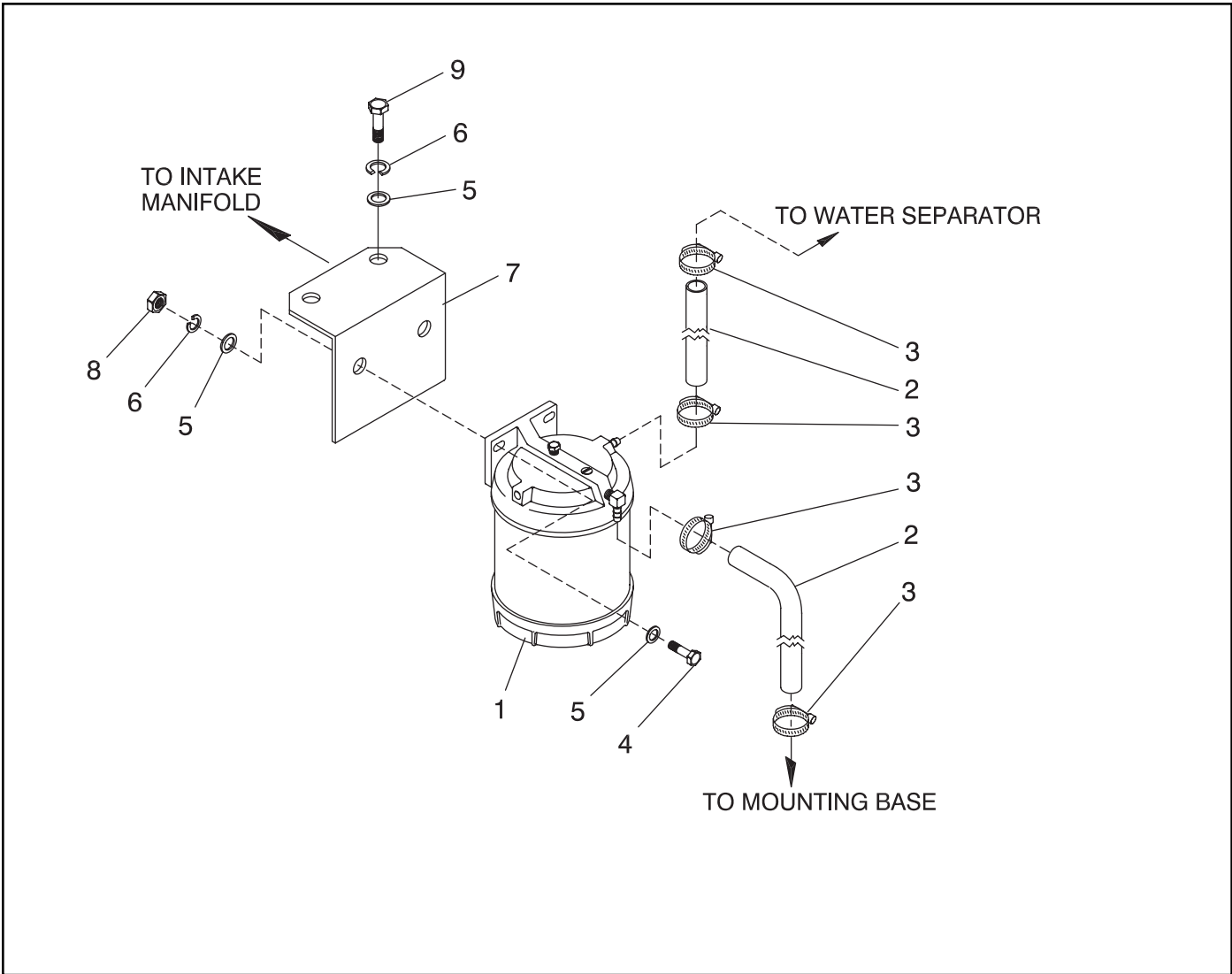

ITEM	PART NUMBER	DESCRIPTION	QTY
1	073847A	FILTER-WATER SEPERATOR	1
2	047290	HOSE-3/8" I.D. x 24" LONG	2
3	035472	CLAMP, HOSE #6 .43-.78	4
4	031578	SCREW, HHC 3/8"-16 x 1-1/2" LONG	2
5	022131	WASHER, FLAT-3/8"	6
6	022237	WASHER, LOCK-3/8"	4
7	0E3236	BRACKET, FUEL FILTER / HEATER	1
8	022241	HEX NUT, 3/8"-16	2
9	051756	SCREW, HHC M10-1.5 x 20	2

3.9L DIESEL — BLOCK HEATER

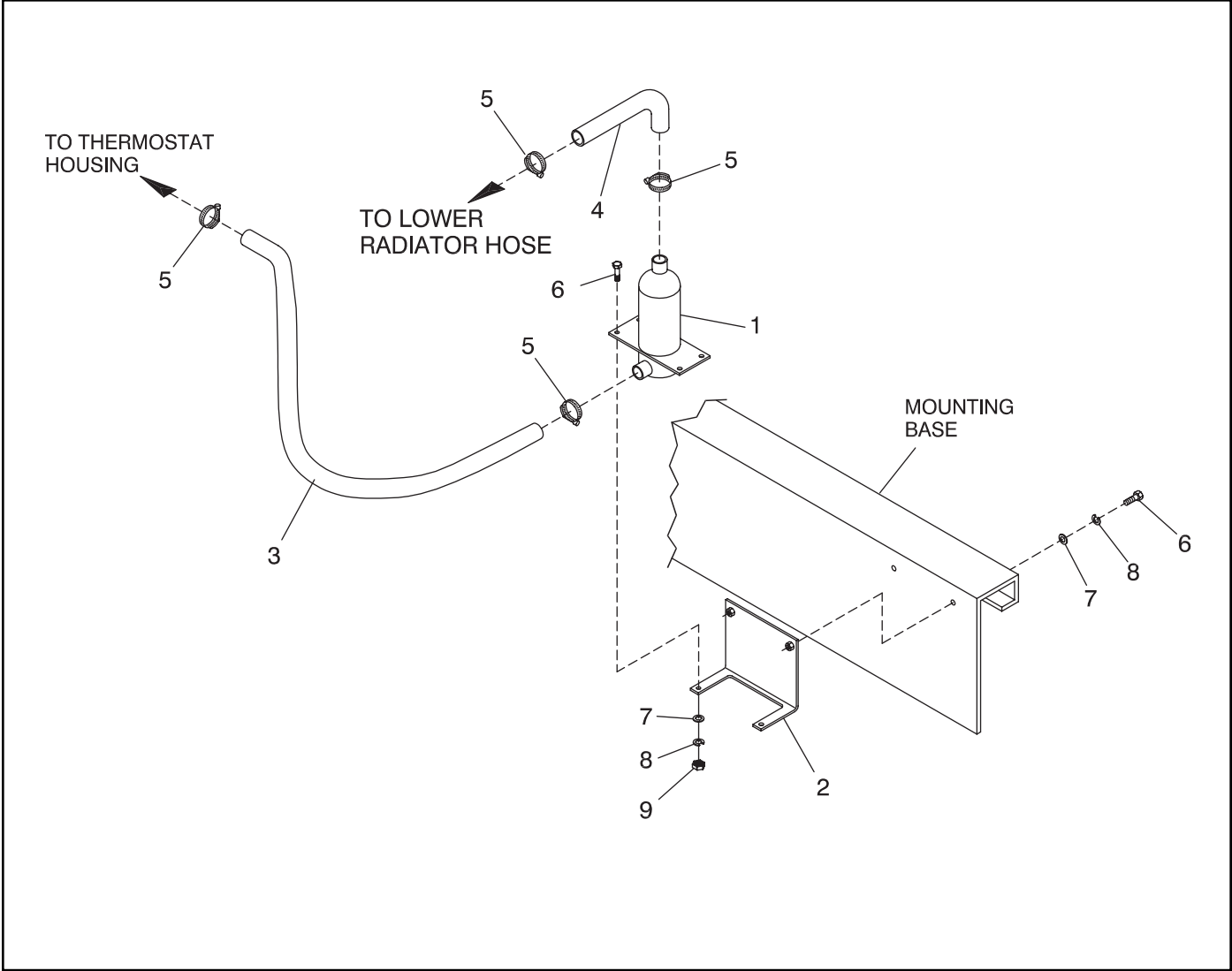

ITEM	PART NUMBER	DESCRIPTION	QTY
1	084918A	BLOCK HEATER 1000W 100-200V.	1
	084918B *	BLOCK HEATER 1000W 200-240V.	1
2	0E2057	BRACKET BLOCK HEATER	1
3	050967	HOSE 5/8 ID DIA 250F (24" LG)	1
4	0A6283	HOSE PREFORMED BLOCK HEATER	1
5	057822	CLAMP HOSE #8 .53-1.00	4
6	047411	SCREW HHC M6-1.0 X 16 G8.8	4
7	022473	WASHER FLAT 1/4-M6 ZINC	4
8	022097	WASHER LOCK M6-1/4	4
9	049813	NUT HEX M6-1.0 G8 YEL CHR	2

* USED ON 'R' VOLTAGE GENERATORS ONLY.

