

# Repair Parts MANUAL

---

3.0 Liter

## GAS/GASOLINE ENGINE

# GENERAC

---

*P. O. Box 8*  
*PHONE: (414) 544-4811*

*Waukesha, WI 53187*  
*FAX: (414) 544-4851*

---

# Table of Contents

<b>Quick Reference Parts Guide .....</b>	<b>Page 1</b>
<b>3.0 Liter Engine Torque Specifications .....</b>	<b>Page 1</b>
<b>Crankcase, Crankshaft, Camshaft, Piston &amp; Oil Pan .....</b>	<b>Page 2,3</b>
<b>Cylinder Head, Manifolds, Accessories .....</b>	<b>Page 4,5</b>
<b>Engine Common Parts- Starter Side .....</b>	<b>Page 6,7</b>
<b>Engine Common Parts- Manifold Side .....</b>	<b>Page 8,9</b>

# QUICK REFERENCE PARTS GUIDE

## Tuneup Parts

DESCRIPTION	PART NO.	QTY
OIL FILTER	44003	1
FUEL FILTER	53244	1
AIR FILTER	73267	1
DISTRIBUTOR CAP	215-88778	1
DISTRIBUTOR ROTOR	216-88778	1
SPARK PLUG	229-88778	4
IGNITION WIRES SET	249-88778	1
COIL WIRE	248-88778	1
DISTRIBUTOR IGNITION MODULE	222-88778	1

## Engine Parts

DESCRIPTION	PART NO.	QTY
PISTON W/PIN (STD)	101-88778	4
PISTON RING KIT (STD)	100-88778	4
REAR MAIN SEAL	169-88778	1
VALVE LIFTER	250-88778	4
CAM BEARING	120-88778	4
ROD BEARING KIT (STD)	105-88778	4
MAIN BEARING KIT (STD)	125-88778	1

## 3.0 Liter Engine Torque Specifications

Camshaft Sprocket.....	80 Inch-pounds
Connecting Rods.....	45 foot-pounds
Cylinder Head .....	90 Foot-Pounds
Cylinder Head Bolt (LH).....	85 Foot-Pounds
Flywheel .....	62 Foot-Pounds
Front Cover .....	30 Inch-pounds
Main Bearing Caps.....	62 Foot-Pounds
Oil Pan Bolts (Crankcase).....	80 Inch-Pounds
Oil Pan Bolts (Front Cover).....	45 Inch-pounds
Oil Pan Nuts .....	165 Inch-pounds
Oil Pan Studs to Seal.....	15 Foot-Pounds
Rocker Arm Cover.....	40 Inch-Pounds
Spark Plugs (Minimum).....	10 Inch-Pounds
Torsional Damper.....	50 Foot-Pounds
Water Pump.....	15 Foot-Pounds

Firing Order.....	1-3-4-2
Spark Plug Gap.....	0.040 inch

# CRANKCASE, CRANKSHAFT, CAMSHAFT, PISTON, PAN

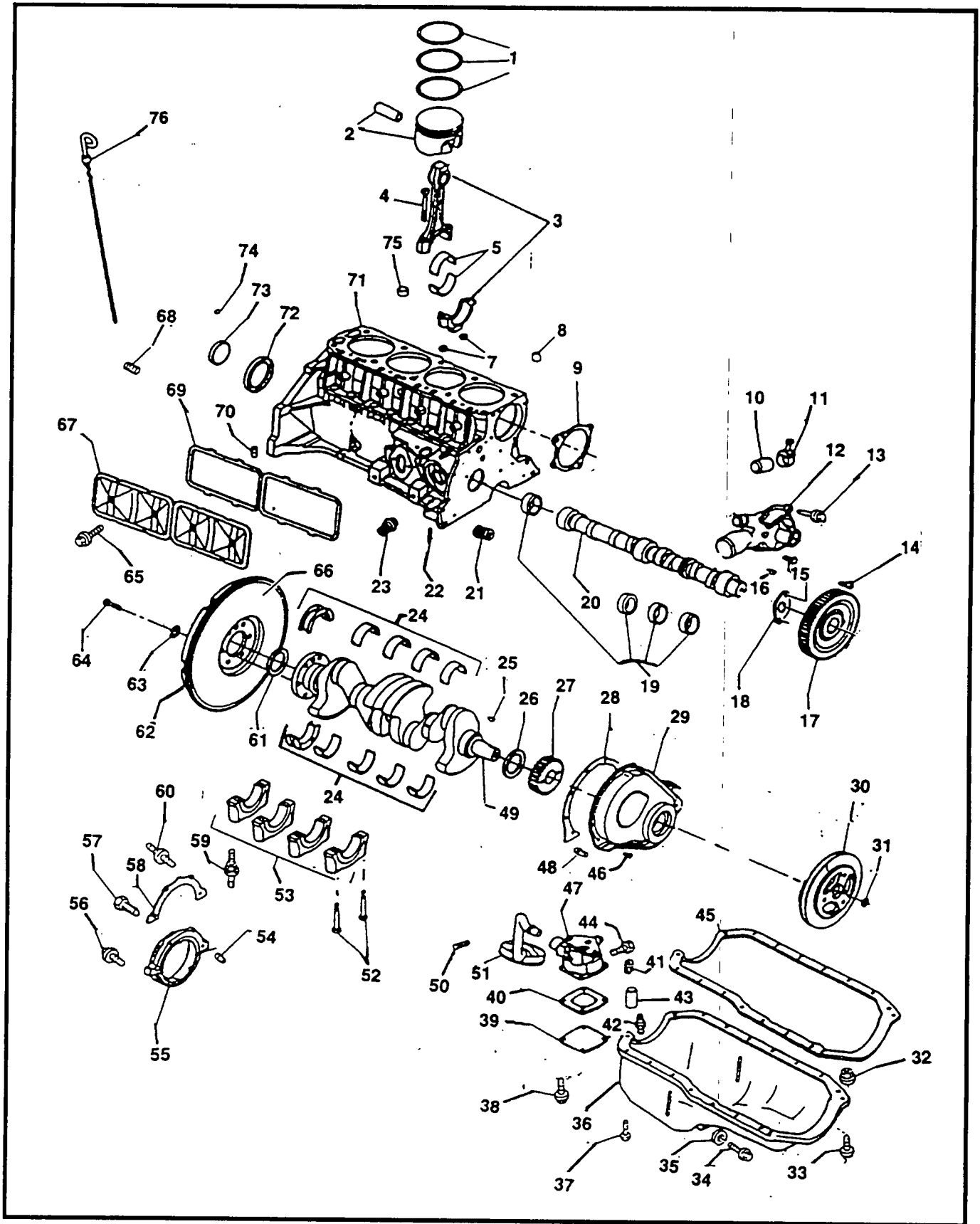

# CRANKCASE, CRANKSHAFT, CAMSHAFT, PISTON, PAN

ITEM	PART NO.	YEAR	DESCRIPTION	ITEM	PART NO.	YEAR	DESCRIPTION
1	100-88778	91-94	Piston Ring Kit (STD)	35	142-88778	91-94	Oil Drain Plug Gasket
2	101-88778	91-93	Piston w/Pin (STD)	36	143-88778	91-94	Oil Pan (Inc. Items 34,35)
	102-88778	94	Piston (w/Rod)	37	144-88778	91-94	Hex Bolt- 5/16"-18 x 5/8"
3	103-88778	91-94	Connecting Rod (Inc. Items 4,6,7)	38	145-88778	91-94	Round Head Screw 1/4"-20 x 3/4"
4	104-88778	91-94	Connecting Rod Bolt	39	146-88778	91-94	Oil Pump Cover
5	105-88778	91-94	Connecting Rod Bearing Kit (STD)	40	147-88778	91-94	Oil Pump Cover Gasket
	106-88778	91-94	Connecting Rod Bearing Kit (0.001 US)	41	148-88778	91-94	Oil Pressure Relief
7	107-88778	91-94	Hex Nut- 3/8"-24	42	149-88778	91-94	Oil Pressure Relief Valve Bore Plug
8	108-88778	91-94	Bearing- Oil Pump Drive Shaft	43	150-88778	91-94	Oil Pressure Relief Valve
9	109-88778	91-94	Gasket (w/Pump)	44	151-88778	91-93	Oil Pump Hex Bolt
10	110-88778	91-94	Water Outlet Cap		152-88778	94	Oil Pump Hex Bolt
11	111-88778	91-94	Clamp	45	153-88778	91-94	Oil Pan Gasket
12	112-88778	91-93	Water Pump	46	154-88778	91-94	Hex Bolt- 1/4"-20
	113088778	94	Water Pump	47	155-88778	91-94	Oil Pump
13	114-88778	91-94	Hex Bolt- 5/16"-18 x 7/8' (with pump)	48	156-88778	91-94	Cam Shaft Gear Lube Nozzle
	115-88778	91-94	Hex Bolt	49	157-88778	91-94	Engine Crankshaft
15	116-88778	91-94	Hex Bolt- 5/16"-18 x 1.5	50	158-88778	91-94	Oil Pressure Relief Valve Pin
16	117-88778	91-94	No. 9 Woodruff Key	51	159-88778	91-94	Oil Pump Screen
17	118-88778	91-94	Camshaft Gear	52	160-88778	91-94	Crankshaft Bearing Cap Bolt
18	119-88778	91-94	Camshaft Thrust Plate Kit	53	161-88778	91-94	Crankshaft Bearing Cap
19	120-88778	91-94	Camshaft Bearing	54	162-88778	91-94	Spring Pin
20	121-88778	91-94	Camshaft (Inc. Item 16)	55	163-88778	91-94	Crankshaft RR Oil Seal Retainer (Inc. Items 60,61)
21	122-88778	91-94	Oil Filter Bypass Valve	56	164-88778	91-94	Crankshaft RR Oil Seal Bolt
22	123-88778	91-94	Dowel Pin- 5/16" x 9/16"	57	165-88778	91-94	Crankshaft RR Oil Seal Housing Bolt
23	124-88778	91-94	Oil Filter Fitting	58	166-88778	91-94	Crankshaft RR Oil Seal Housing Gasket
24	125-88778	91-94	Crankshaft Bearing Kit (STD)	59	167-88778	91-94	Crankshaft Bearing Cap Stud
	126-88778	91-94	Crankshaft Bearing Kit (0.001 US)	60	168-88778	91-94	Crankshaft Oil Seal Stud
	127-88778	91-94	Crankshaft Bearing Kit (0.010 US)	61	169-88778	91-94	Crankshaft RR Oil Seal
	128-88778	91-94	Crankshaft Bearing Kit (0.020 US)	62	170-88778	91-94	Flywheel Ring Gear
	129-88778	91-94	Crankshaft Bearing Kit (0.030 US)	63	171-88778	91-94	Ext. Tooth Lockwasher
	130-88778	91-94	Crankshaft Bearing Kit (RR)- (STD)	64	172-88778	91-94	Flywheel Bolt
	131-88778	91-94	Crankshaft Bearing Kit (RR)- 0.001 US)	65	173-88778	91-94	Push Rod Cover Valve Bolt
25	132-88778	91-94	No. 9 Woodruff Key	66	174-88778	91-94	Engine Flywheel
26	133-88778	91-94	Crankshaft Oil Seal (Timing Gear Cover)	67	176-88778	91-94	Valve Push Rod Cover
27	134-88778	91-94	Crankshaft Gear	68	177-88778	91-94	Dowel Pin
28	135-88778	91-94	Engine Front Cover Gasket	69	178-88778	91-94	Valve Push Rod Cover Gasket
29	136-88778	91-94	Engine Front Cover (Inc. Items 26,31)	70	179-88778	91-94	Auto Drain Plug
30	137-88778	91-94	Crankshaft Balancer	71	180-88778	91-94	Partial Service Engine
31	138-88778	91-94	Crankshaft Front Oil Seal	72	181-88778	91-94	Camshaft RR Bearing Hole Plug
32	139-88778	91-94	Hex Nut- 5/16"-18	73	182-88778	91-94	Engine Block Core Hole Plug
33	140-88778	91-94	Bolt- 1/4"-20 x 5/8"	74	183-88778	91-94	Oil Level Indicator Tube Hole Plug
34	141-88778	91-94	Oil Pan Drain Plug	75	184-88778	91-94	Engine Block Oil Gallery Plug
				76	186-88778	91-94	Oil Dipstick

# CYLINDER HEAD, MANIFOLDS, ACCESSORIES

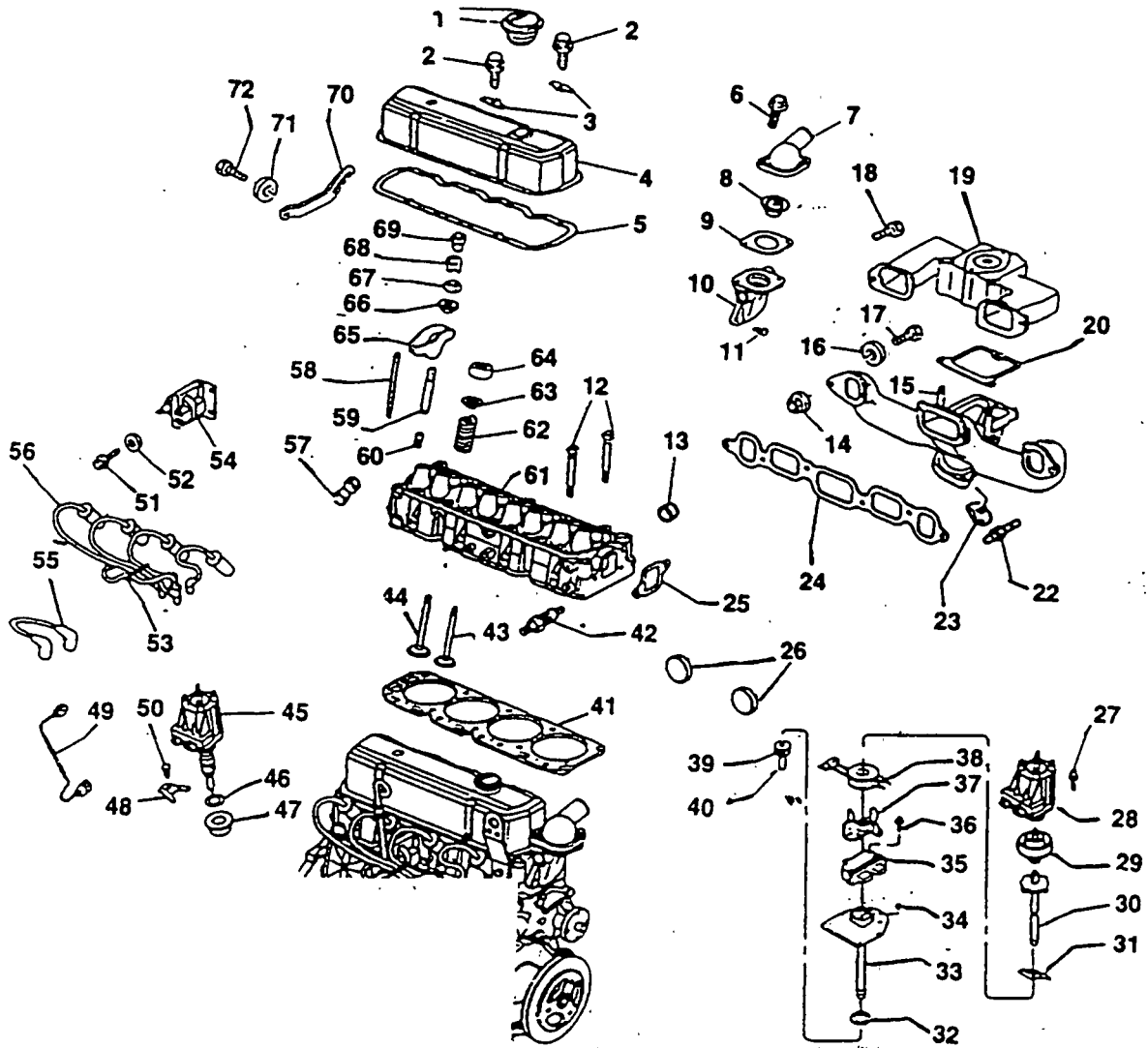

# CYLINDER HEAD, MANIFOLDS, ACCESSORIES

ITEM	PART NO.	YEAR	DESCRIPTION	ITEM	PART NO.	YEAR	DESCRIPTION
1	187-88778	91-94	Oil Fill Cap	40	227-88778	91-94	Distributor Gear Pin
2	188-88778	91-94	Rocker Arm Cover Bolt	41	228-88778	91-94	Cylinder Head Gasket
3	189-88778	91-94	Rocker Arm Cover Reinforcement	42	229-88778	91-94	Spark Plug (AC #R46TS)
4	190-88778	91-94	Rocker Arm Cover	43	230-88778	91-94	Exhaust Valve (STD)
5	191-88778	91-94	Rocker Arm Cover		231-88778	91-94	Exhaust Valve (0.0035 OS)
6	192-88778	91-94	Flanged Hex Bolt 3/8"-16 x 7/8"		232-88778	91-94	Exhaust Valve (0.0155 OS)
7	193-88778	91-94	Water Outlet Fitting	44	234-88778	91-94	Intake Valve (STD)
8	194-88778	91-93	Thermostat		235-88778	91-94	Intake Valve (0.0035 OS)
	195-88778	94	Thermostat		236-88778	91-94	Intake Valve (0.0155 OS)
9	196-88778	91-94	Water Outlet Fitting Gasket		237-88778	91-94	Intake Valve (0.0305 OS)
10	197-88778	91-94	Thermostat Housing	45	238-88778	91-94	Distributor Assembly (Inc. Items 37 thru 40)
11	198-88778	91-94	Thermostat Housing Bolt- 3/8"-16 x 1"	46	239-88778	91-94	Distributor Gasket
12	199-88778	91-94	Cylinder Head Bolt	47	240-88778	91-94	Washer
13	200-88778	91-94	Cylinder Head Core Hole Plug)	48	241-88778	91-94	Distributor Clamp
14	201-88778	91-94	Exhaust Manifold Nut 3/8"-24	49	242-88778	91-94	Ignition Coil Wiring Harness
15	202-88778	91-94	Intake Manifold Stud	50	243-88778	91-94	Distributor Clamp Bolt 3/8"-16 x 1"
16	203-88778	91-94	Spring Lock Washer	51	244-88778	91-94	Ignition Coil Bolt 3/8"-16 x 5/8"
17	204-88778	91-94	Exhaust Manifold Bolt 3/8"-16 x 1"	52	245-88778	91-94	Ignition Coil Flat Washer
18	205-88778	91-94	Intake Manifold Bolt 3/8"-16 x 1-1/4"	53	246-88778	91-94	Wire Retainer
19	206-88778	91-94	Intake Manifold	54	247-88778	91-94	Ignition Coil
20	207-88778	91-94	Exhaust Pipe Stud	55	248-88778	91-94	Ignition Coil Wire
22	209-88778	91-94	Exhaust Pipe Stud	56	249-88778	91-94	Wire Harness
23	210-88778	91-94	Intake & Exhaust Manifold Clamp	57	250-88778	91-94	Valve Lifter
24	211-88778	91-94	Intake Manifold Gasket	58	251-88778	91-94	Valve Push Rod
25	212-88778	91-94	Thermostat Housing	59	252-88778	91-94	Rocker Arm Ball Stud 0.003 Inch OS
26	213-88778	91-94	Engine Block Core Hole Plug		253-88778	91-94	Rocker Arm Ball Stud 0.013 Inch OS
27	214-88778	91-94	Distributor Cap Bolt	60	254-88778	91-94	Valve Stem Oil Seal (Intake and Exhaust)
28	215-88778	91-94	Distributor Cap	61	255-88778	91-94	Cylinder Head Valve Spring
29	216-88778	91-94	Distributor Rotor	62	256-88778	91-94	Valve Spring Cap
30	217-88778	91-94	Distributor Shaft	63	257-88778	91-94	Valve Stem Oil Shield
31	218-88778	91-94	Distributor Ignition Pickup Coil Retainer	64	258-88778	91-94	Rocker Arm Kit
32	219-88778	91-94	Distributor Housing Oil Seal	65	259-88778	91-94	Rocker Arm Ball
33	220-88778	91-94	Distributor Housing	66	260-88778	91-94	Rocker Arm Nut
34	221-88778	91-94	Distributor Pickup Pole Piece Lock Pin	67	261-88778	91-94	Valve Stem Key
35	222-88778	91-94	Ignition Module	68	262-88778	91-94	Exhaust Valve Rotator
36	223-88778	91-94	Ignition Module Bolt	69	263-88778	91-94	Generator Brace
37	224-88778	91-94	Distributor Pickup Pole Piece	70	264-88778	91-94	Lockwasher - 7/16"
38	225-88778	91-94	Distributor Pickup Coil	71	265-88778	91-94	Generator Brace Bolt 3/8"-16 x 3/4"
39	226-88778	91-94	Distributor Shaft Gear	72	266-88778	91-94	

# ENGINE COMMON PARTS- STARTER SIDE

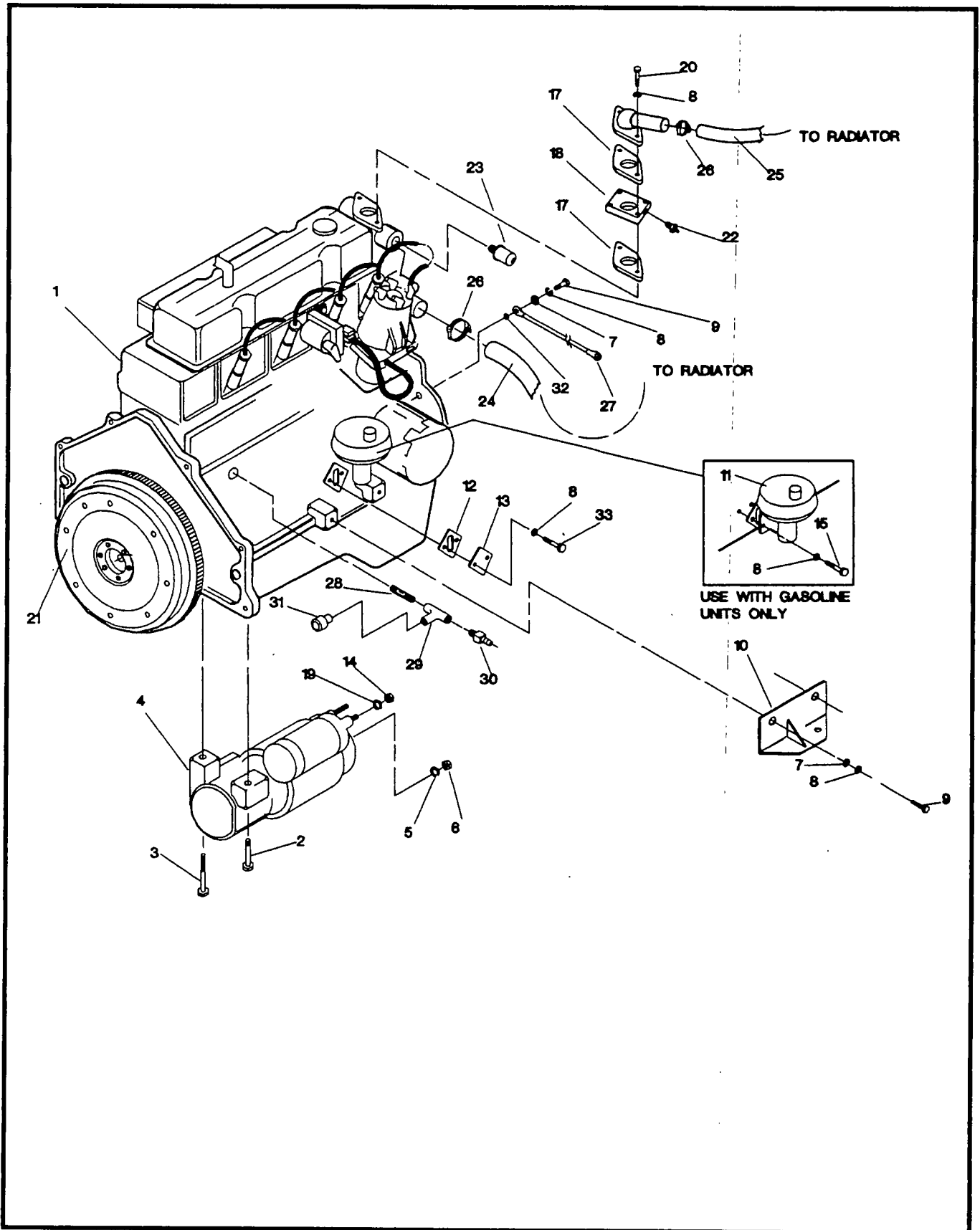

# ENGINE COMMON PARTS- STARTER SIDE

ITEM	PART NO.	QTY	DESCRIPTION	ITEM	PART NO.	QTY	DESCRIPTION
				18	59462	1	Thermostat Spacer
1	88778	1	Engine- 3.0 Liter Gas	19	46526	1	Lockwasher- M10
2	81260	1	Starter Mounting Bolt	20	22219	2	Capscrew- 3/8"-16 x 2-1/4"
3	81259	1	Starter Mounting Bolt	21	79128	1	Flywheel (Reworked)
4	81258	1	Starter Motor	22	57522	1	Water Level Sensor
5	49226	1	Lockwasher- M6	23	35606	1	Water Temperature Switch
6	51716	1	Hex Nut- M5-0.80	24	81257	1	Lower Radiator Hose
7	22131	3	Flatwasher- 3/8"	25	66545	1	Upper Radiator Hose
8	22237	7	Lockwasher- 3/8"	26	35685	2	Hose Clamp
9	36833	2	Capscrew- 3/8"-16 x 1"	27	98-53621	1	Ground Wire Assy.
10	79340	1	Engine Mounting Bracket	28	35483	1	Pipe Nipple- 1/8" NPT x 1-1/2"
11	44002	1	Fuel Pump	29	35430	1	Pipe Tee- 1/8" NPT
12	58018	1	Fuel Pump Gasket	30	60108	1	Oil Pressure Switch
13	58021	1	Fuel Pump Cover	31	53666	1	Oil Pressure Sender
14	45772	1	Hex Nut- M10-1.50	32	25507	1	Shakeproof Washer
15	30795	2	Capscrew- 5/16"-18 x 1"	33	22142	2	Capscrew- 5/16"-18 x 3/4"
16	44003	1	Oil Filter (PF-25)				
17	48665	2	Thermostat Housing Gasket				

# ENGINE COMMON PARTS- MANIFOLD SIDE

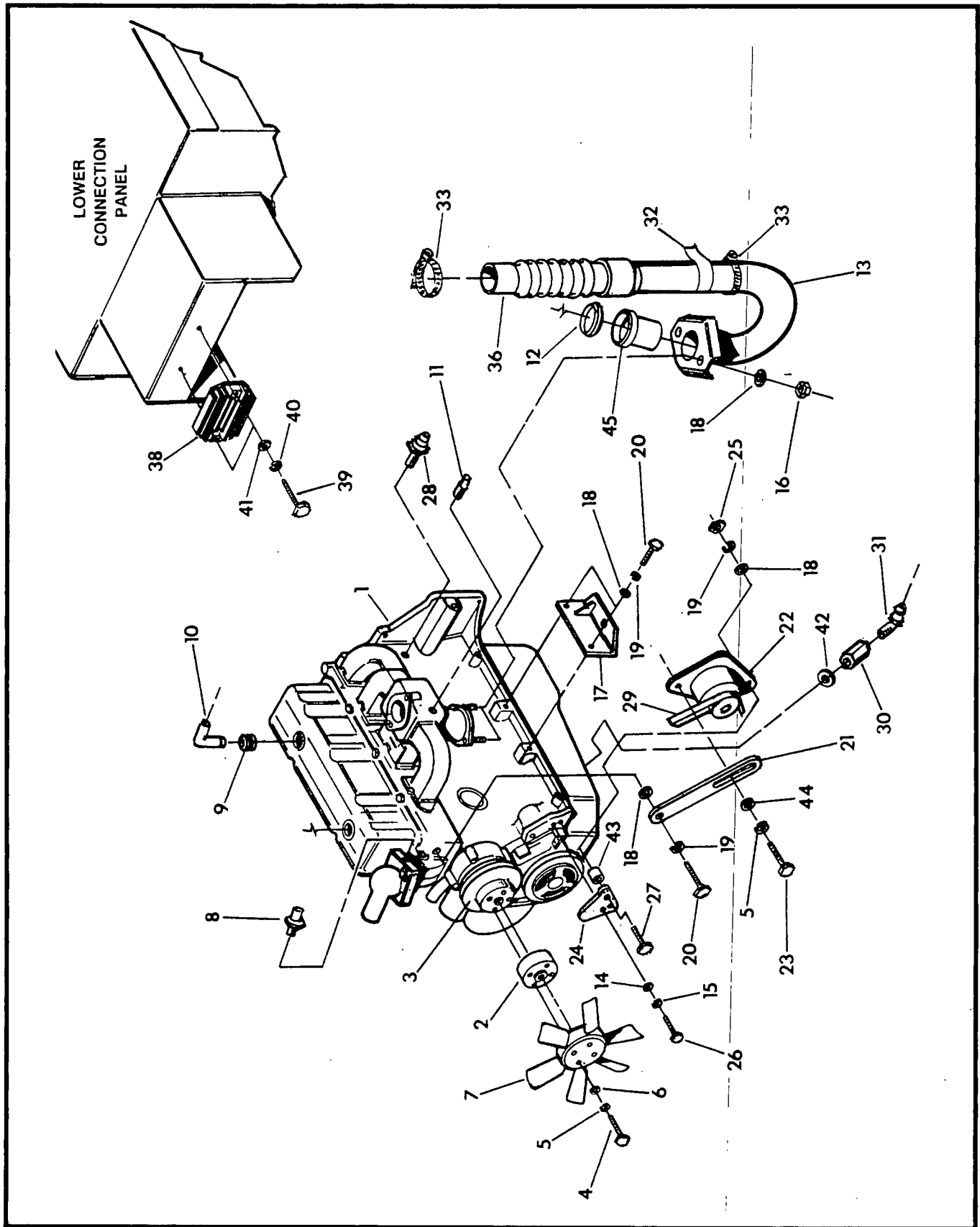

# ENGINE COMMON PARTS- MANIFOLD SIDE

ITEM	PART NO.	QTY	DESCRIPTION	ITEM	PART NO.	QTY	DESCRIPTION
1	88778	1	Engine- 3.0 Liter Gas	24	81243	1	Engine Mounting Bracket
2	79335	1	Fan Spacer	25	45772	1	Hex Nut- M10-1.50
3	58015	1	Fan Pulley	26	22333	2	Capscrew- 7/16"-14 x 1"
4	38719	4	Capscrew- 5/16"-24 x 3-1/4"	27	64416	1	Capscrew- M10-1.50 x 45mm
5	22129	3	Lockwasher- 5/16" (M8)	28	59660	1	Barbed Fitting
6	22145	2	Flatwasher- 5/16" (M8)	29	46361	1	1/4" NPT x 5/8" ID
7	59052	1	Radiator Fan	30	54455	1	V-Belt- 38-1/4" long
8	53667	1	Water Temp. Sender	31	34439	1	Oil Drain Adapter
9	57796	1	Grommet	32	82361	86"	Barbed 90° Fitting
10	57795	1	Crankcase Vent Connector	33	42561	2	3/8" NPT x 5/8" Hose
11	31919	1	Plug- 3/8" Socket	36	58943-H	1	Exhaust Insulation
12	44149	1	Exhaust Pipe Gasket Ring	37	81274*	1	Hose Clamp
13	81246	1	Exhaust Pipe	38	71938-A	1	Flexible Exhaust Pipe
14	22250	1	Flatwasher- 7/16"	39	22413	2	Engine Wiring Harness
15	22302	1	Lockwasher- 7/16"	40	32097	2	Engine Wiring Harness
16	87436	2	Lock Nut- 3/8"-16	41	22473	2	DC Voltage Regulator
17	79339	1	Engine Mounting Bracket	42	52677	1	Capscrew- 1/4"-20 x 1"
18	22131	6	Flatwasher- 3/8"	43	32421	1	Lockwasher- 1/4"
19	22237	4	Lockwasher- 3/8"	44	50190	1	Flatwasher- 1/4"
20	29745	3	Capscrew- 3/8"-16 x 1"	45	44096	1	Nylon Flatwasher
21	81242	1	Alternator Adjust Bracket				Spacer
22	277-70939	1	DC Alternator				Flatwasher
23	51731	1	Capscrew- M8-1.25 x 50mm				Exhaust Pipe Extension

\* NOT SHOWN